

USIM Card	14-2
About USIM Card	14-2
USIM Card Installation.....	14-3
Battery	14-4
Battery Installation.....	14-4
Software Update	14-5
Cleaning Handset	14-6
Troubleshooting	14-7
Key Assignments	14-9
Pager Codes	14-11
Pager Code List	14-11
Character Codes	14-12
Character Code List.....	14-12

Weather Indicators	14-18
Weather Indicator List	14-18
Specifications	14-19
Memory Card Structure & Contents ...	14-24
Menu List	14-25
Index	14-32
Warranty & Service	14-39
Customer Service	14-40

14

Appendix



About USIM Card

USIM Card is an IC card containing customer and authentication information, including the handset number. USIM Card must be inserted to use this handset. Save Phone Book entries on USIM Card Phone Book to use them on other SoftBank handsets. Depending on the USIM Card in use, some entry items may not be supported, and some limits (character entry, etc.) may be lower.

Precautions

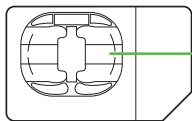

IC Chip

- Do not insert USIM Card into any other IC card device. SoftBank Mobile is not liable for resulting damages.
- Keep the USIM Card IC chip clean; malfunction may result. Clean with soft dry cloth.
- Do not attach labels to USIM Card. Malfunction may result.

Important

- USIM Card is the property of SoftBank Mobile.
- USIM Card will be reissued for a fee if lost or damaged.
- Return USIM Card to SoftBank Mobile upon subscription termination.
- Returned USIM Cards are recycled.
- USIM Card specifications may change without prior notice.
- Back up USIM Card files. SoftBank Mobile is not liable for lost files.
- If your USIM Card or handset (with USIM Card inserted) is lost or stolen, suspend your service immediately. For details, contact SoftBank Mobile Customer Center, General Information (P.14-40).

USIM PIN

Four- to eight-digit code (**9999** by default); activate PIN Entry to restrict handset use.

PIN Lock

- Entering incorrect PIN three consecutive times activates PIN Lock, limiting handset use.

Canceling PIN Lock

- Contact SoftBank Mobile Customer Center, General Information (P.14-40) for your Personal Unlocking Key (PUK Code) and follow these steps:

Enter PUK Code ➔ ● ➔ **Enter new PIN** ➔ ● ➔ **Re-enter new PIN** ➔ ●

- Write down PUK code.

PUK Lock

- Entering incorrect PUK Code ten consecutive times activates PUK Lock, disabling handset. Contact SoftBank Mobile Customer Center, General Information (P.14-40) for recovery.



USIM Card Installation

- Do not apply excessive force to insert/remove USIM Card.
- USIM Card must be inserted to use this handset.

Inserting

- 1 Remove battery (P.14-4)
- 2 Using Tab, pull out Tray as shown until it clicks

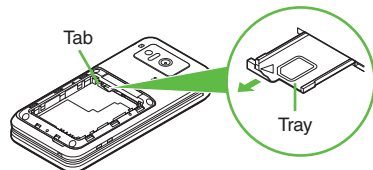

- 3 Slide in USIM Card with IC chip facing up

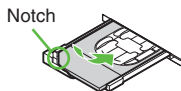

- 4 Push in Tray fully



- Reinstall battery (P.14-4).

Removing

- 1 Remove battery
- 2 Using Tab, pull out Tray as shown until it clicks

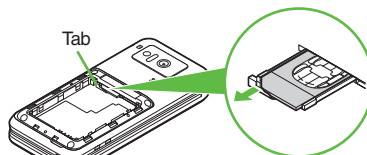

- 3 Lift and slide out USIM Card as shown

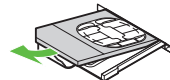

- Reinstall battery.
- Take care not to lose removed USIM Card.

After Repairs, USIM Card Replacement or Handset Upgrade/Replacement

- Some downloaded files may be inaccessible. In addition, S! Applications and BookSurfing® may be disabled after USIM Card replacement.



Battery Installation

About Battery

- Charge battery at least once every six months; an uncharged battery may become unusable or affect files/settings.
- Depending on usage, bulges may appear near end of battery life; this does not affect safety.
- Replace battery if operating time shortens noticeably.
- Clean device charging terminals with a dry cotton swab.
- To maintain water/dust resistance, close Battery Cover properly.
- Battery is not waterproofed or dustproofed.

Lithium-ion Battery

- This product requires a lithium-ion battery. Lithium-ion batteries are a recyclable resource.



Li-ion00

- To recycle a used lithium-ion battery, take it to any shop displaying the symbol shown above.
- To avoid fire or electric shock, do not short-circuit or disassemble battery.

Inserting & Removing

1 Remove cover

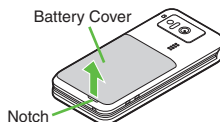

- Use your fingernail to lift cover at notch as shown.

2 Insert battery

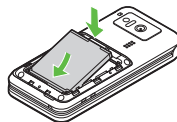

- With logo side up, fit tabs into battery cavity slots.

3 Close cover



Press firmly along edges

- Fit cover top into slot, then press down firmly.
- Close cover firmly. Debris trapped between cover and base may expose handset to liquid/dust.

Removing

- Power handset off and lift battery as shown.



Software Update





Check for firmware updates and download as required.

Precautions

- Handset is disabled until update is complete. Update may take up to approximately 30 minutes.
- Update failure may disable handset. To reduce failure risk, make sure signal is strong and stable, and charge battery beforehand.
- Update will not start if other functions are in use. Before updating software (or before scheduled update time), end all active functions/applications.
- Disconnect USB Cable beforehand to reduce failure risk.
- Always back up important information. SoftBank Mobile cannot be held liable for damages from lost information, etc.

Updating Software

Packet transmission fees do not apply to updates (including checking, downloading and rewriting).

- 1  ➔ **Settings** ➔  ➔ **Phone/Software Update** ➔ 
- 2 **Software Update** ➔ 

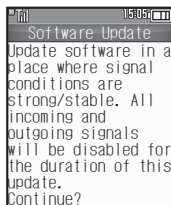

- Follow onscreen instructions.

Update Result

In , **Update Result** ➔ 

Scheduled Update (Japanese)

SoftBank Mobile sends update notice via SMS; read and change preset update schedule as needed. A confirmation appears at scheduled update time. Press  or wait a while for update to start.

When Updated

Update success notification appears and handset reboots.

After reboot, completion message appears and Information window opens.

Update Result

While Information window appears,
Update Result ➔ 

Reboot Failure

- If handset does not return to Standby after update, power handset off, reinsert battery, then restart it. If it still does not restart, contact SoftBank Mobile Customer Center, Customer Assistance (P.14-40).



Cleaning Handset

Washing Handset

Wipe off dirt, sand, beverage, etc., gently with cloth. Then with Battery Cover closed, hold handset approximately 10 cm below faucet or shower head and wash with low-pressure tap water (6 liters/min. or lower) at normal temperature (5°C - 35°C). Wash with your hands, taking care not to open the covers; do not use a brush or sponge. Dry handset before use.

- Before washing handset, make sure that Battery Cover and Port Cover are closed firmly.
- Do not use a washing machine or ultrasonic cleaner.
- Do not place handset in a microwave oven to dry it. Battery/handset may leak, burst, overheat or ignite; may cause malfunction, accident or injury.
- Do not dry handset by exposing it to extreme heat (e.g., hot air from dryers, etc.); may cause warping, discoloration or damage.

Drying Handset

Dry these parts/areas after washing handset:

Hinge	Earpiece
Microphone	Speaker

- 1 Wipe handset surface with dry cloth
- 2 Holding hinge firmly by its sides, shake handset about 20 times

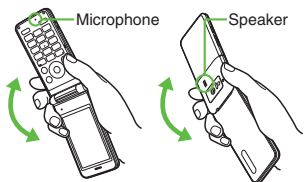
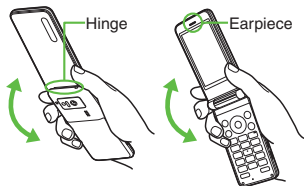

- 3 Pat against dry cloth to remove moisture from grooves

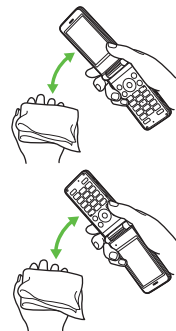

- 4 Leave handset on dry cloth for approximately 2 - 3 hours at room temperature



Do Not Use Wet Handset

- Voice quality may be affected, or moisture may transfer to clothes, bag, etc.
- Moisture may short-circuit External Device Port.
- Exposure to cold may freeze moisture causing malfunction.



Troubleshooting

■ General

Problem	Possible Cause	Solution
Handset won't power on	Was  pressed long enough?	Press  longer.
	Battery may need to be charged or replaced.	Charge battery or install a charged battery.
	Battery may not be properly installed.	Install battery properly (P.14-4).
Handset won't respond	Is Switch On/Off in PIN Entry <i>On</i> ?	If <i>On</i> , PIN is required. Enter PIN according to onscreen prompt.
Insert USIM Card appears	USIM Card may not be properly inserted.	Power handset off and check that USIM Card is properly inserted, then restart handset. If the message still appears, USIM may be damaged.
	The correct USIM Card may not be inserted.	Make sure the correct USIM Card is inserted. The inserted USIM Card may not be valid.
	There may be debris on IC chip/terminals.	Clean relevant parts with dry cloth and re-insert.
REFRESH appears and handset returns to Standby	Handset may have been dropped or subjected to shocks.	Handset failed to recognize USIM Card temporarily. This is not a malfunction.
Keypad won't respond	Keypad Lock may be active.	Cancel Keypad Lock (P.1-20).
	Function Lock may be active.	Cancel Function Lock (P.10-2).

Problem	Possible Cause	Solution
Battery strength indicator flashes when not charging	Ambient temperature may be outside 5°C to 35°C.	Use within an ambient temperature of 5°C - 35°C.
Saved entry/folder does not appear on handset	Entry/folder may be set to Secret.	Activate Show Secret Data (P.10-3).
Handset/AC Charger feels warm	Handset/AC Charger may warm while charging.	Unless handset/AC Charger is too hot to touch, warmth is considered normal. Always avoid prolonged skin contact to prevent burn injuries.
	Handset may warm during extended periods of use.	
	Handset may warm during Video Calls.	
Cannot access Memory Card files	Memory Card may not be properly formatted.	Use 841SH-formatted Memory Cards.
Clock settings are lost	Did you leave handset without battery?	Clock settings remain even when removing battery for replacement, etc. However, if handset is left with no battery or an exhausted one for an extended period of time (approximately one hour), Clock will need to be reset.



■ **Charger/Battery**

Problem	Possible Cause	Solution
Battery charges quickly	Remaining charge shortens charging time.	This is normal.
	Battery may be terminally exhausted or defective. (Small Light flashes red.)	Replace battery with a new one.
Battery charges slowly	Charging slows during Video Calls.	End the call to charge faster.
	Battery may be charging via USB.	Use AC Charger.
Battery won't charge	AC Charger may not be properly connected to handset.	Make sure connector is securely inserted and retry.
	AC Charger may not be firmly plugged in to AC outlet.	Remove plug from outlet, re-insert and retry.
	Battery may not be properly installed.	Install battery properly (P.14-4).
	Battery, AC Charger, or Charging Terminals, or Device Port may be obstructed by dust, etc.	Clean terminals, connector and Port with a dry cotton swab and retry.
	Charger, etc. may not be supported.	Use specified AC Charger, etc. only; others may damage battery.

Problem	Possible Cause	Solution
Battery Time seems shorter than usual	High power consuming operations are in use.	Keep handset closed in Standby; reduce S! Application, Media Player and camera use, and limit transmissions/external connections.
	Using handset in poor conditions may shorten Battery Time.	Avoid prolonged use of handset out-of-range or in poor signal conditions.
	Power hungry settings may be active.	Lower Brightness, select shorter Display Saving/ Backlight time, etc.



Key Assignments

Key	Kanji (Hiragana) [Double-byte]	Katakana [Double & Single-byte]	Alphanumerics [Double & Single-byte]	Numbers [Single-byte]	Character Codes
[1]	あいうえお あいうえお	アイウエオ アイウエオ	@./_-1 □ (space)	1	1
[2]	かきくけこ	カキクケコ	ABCabc2	2	2
[3]	さしすせそ	サシスセソ	DEFdef3	3	3
[4]	たちつてとっ	タチツテトツ	GHIghi4	4	4
[5]	なにぬねの	ナニヌネノ	JKLjkl5	5	5
[6]	はひふへほ	ハヒフヘホ	MNOmno6	6	6
[7]	まみむめも	マミムメモ	PQRSpqrs7	7	7
[8]	やゆよやゆよ	ヤユヨヤユヨ	TUVtuv8	8	8
[9]	らりるれろ	ラリルレロ	WXYZwxyz9	9	9
[0]	わをんー ..	ワヲンー ..*_1	0	0	0
[X]	Log, Pictogram List (double-byte), Symbol List ³				✕ + P (pause) ? - ²
[#]	.. # (line break) ? ! □ (space)		.. # (line break) ?! □ (space)	#	

¹ - is available only in Single-byte Katakana mode.

² Available for phone number entry; some characters may not be enterable in some windows.

³ May not be enterable in some windows.



Key	Kanji (Hiragana) [Double-byte]	Katakana [Double & Single-byte]	Alphanumerics [Double & Single-byte]	Numbers [Single-byte]	Character Codes
	Conversion ⁴	Cursor up/down; (line break) when is pressed at the end of text			
	Cursor left/right				
	Cursor left/right				
	Switch entry modes (except during conversion)				
	Search Word ⁵	_____			
 (Long)	Toggle Personal Mode ⁵	_____	Toggle Personal Mode ^{5,6}	_____	
	Toggle case (for some characters)			_____	
	_____	Toggle mode (upper/ lower and lower case)		_____	
	Delete one character				
	Cancel conversion	_____	Cancel conversion ⁶	_____	Delete code
 (Long)	Delete before or after cursor				
	Recover characters deleted with				
	Re-convert ⁷	_____	Re-convert ^{6,7}	_____	
	OK				
	Non-Predictive suggestions ⁵				
	Hiragana to Katakana/ Alphanumeric Conversion ⁵				
 (Long)	Single Kanji Conversion ⁵				

⁴Cursor moves up/down except during conversion.

⁵Available during conversion.

⁶Available only in Single-byte Alphanumerics mode.



⁷Press immediately after inserting characters to re-convert them.





Pager Code List

Gray background indicates upper and lower case available. Press  to switch immediately after character entry.

Double-byte Upper Case

		Second Digit (Press Next)									
		1	2	3	4	5	6	7	8	9	0
First Digit (Press First)	1	あ	い	う	え	お	A	B	C	D	E
	2	か	き	く	け	こ	F	G	H	I	J
	3	さ	し	す	せ	そ	K	L	M	N	O
	4	た	ち	つ	て	と	P	Q	R	S	T
	5	な	に	ぬ	ね	の	U	V	W	X	Y
	6	は	ひ	ふ	へ	ほ	Z	?	!	-	/
	7	ま	み	む	め	も	¥	&		*1	
	8	や	(ゆ)	よ	*	#	Space		*2
	9	ら	り	る	れ	ろ	1	2	3	4	5
	0	わ	を	ん	.	。	6	7	8	9	0

Single-byte Upper Case

		Second Digit (Press Next)									
		1	2	3	4	5	6	7	8	9	0
First Digit (Press First)	1	ア	イ	ウ	エ	オ	A	B	C	D	E
	2	カ	キ	ク	ケ	コ	F	G	H	I	J
	3	サ	シ	ス	セ	ソ	K	L	M	N	O
	4	タ	チ	ツ	テ	ト	P	Q	R	S	T
	5	ナ	ニ	ヌ	ネ	ノ	U	V	W	X	Y
	6	ハ	ヒ	フ	ヘ	ホ	Z	?	!	-	/
	7	マ	ミ	ム	メ	モ	¥	&		*1	
	8	ヤ	(ユ)	ヨ	*	#	Space		*2
	9	ラ	リ	ル	レ	ロ	1	2	3	4	5
	0	ワ	ヲ	ン	.	。	6	7	8	9	0



Double-byte Lower Case

		Second Digit (Press Next)									
		1	2	3	4	5	6	7	8	9	0
First Digit (Press First)	1	あ	い	う	え	お	a	b	c	d	e
	2						f	g	h	i	j
	3						k	l	m	n	o
	4			つ			p	q	r	s	t
	5						u	v	w	x	y
	6						z				
	7										*1
	8	や		ゆ		よ					*2
	9										
	0				.	。					

Single-byte Lower Case

		Second Digit (Press Next)									
		1	2	3	4	5	6	7	8	9	0
First Digit (Press First)	1	ア	イ	ウ	エ	オ	a	b	c	d	e
	2						f	g	h	i	j
	3						k	l	m	n	o
	4			ツ			p	q	r	s	t
	5						u	v	w	x	y
	6						z				
	7										*1
	8	ヤ		ユ		ヨ					*2
	9										
	0				.	。					

*1 Press   to insert  (line break) in mail message text, Notepad, etc.

*2 Press   to toggle upper and lower case modes.



Character Code List

First Three Digits	Last Digit									First Three Digits	Last Digit									First Three Digits	Last Digit									First Three Digits	Last Digit											
	0	1	2	3	4	5	6	7	8		9	0	1	2	3	4	5	6	7		8	9	0	1	2	3	4	5	6		7	8	9	0	1	2	3	4	5	6	7	8
010	Space	,	.	:	;	?				043	ぞ	た	ち	ち	つ	づ	て	で		171	迂	雨	卵	鶏	丑	碓	白	濁	嘘													
011	!	>	<	..	.	:	;	?	\	044	と	だ	ぬ	ね	は	ば	ば	ば		080	明	蔚	鱧	鮫	浦	瓜	聞	噂														
012	~	^	^	^	^	^	^	^	^	045	ひ	び	ふ	む	べ	べ	ほ		081	云	運	雲	鱧	鮫	鮫	鮫	鮫	鮫														
013	/	\	~	~	~	~	~	~	~	046	ぼ	ま	む	め	ま	ま	ま		082																							
014	"	"	()	[]	{	}		047	よ	ま	り	れ	や	わ	わ		083																							
015	<	>	《	》	「	」	【	】		048	ゐ	を	ん						130																							
016	+	-	±	×	÷	#	<	>	≡	050	ア	イ	ウ	エ	オ			131	①	②	③	④	⑤	⑥	⑦	⑧	⑨															
017	≡	∞	:	∂	∇	°	"	<	℃	¥	051	カ	キ	ク	ケ	コ		132	⑩	⑪	⑫	⑬	⑭	⑮	⑯	⑰	⑱															
018	\$	£	%	#	&	*	@	§	☆	052	オ	カ	キ	ク	ケ	コ		133	㊶	㊷	㊸	㊹	㊺	㊻	㊼	㊽	㊾															
019	★	●	◆	◇	▲	▼	※	〒		053	ソ	タ	チ	ツ	テ			134	㊿	㊿	㊿	㊿	㊿	㊿	㊿	㊿	㊿															
020	◆	◆	◆	▲	▼	※	〒			054	ト	ド	ニ	フ	ヘ	バ		135	km	mg	kg	cc	m ³																			
021	→	←	↑	↓	≡					055	ト	ビ	ピ	フ	ム	ヘ	ホ		136																							
022										056	ボ	ビ	フ	ム	ヘ	マ	ホ		137	㊿	㊿	㊿	㊿	㊿	㊿	㊿	㊿	㊿														
023	㊿	㊿	㊿	㊿	㊿	㊿	㊿	㊿	㊿	057	コ	ヨ	ロ	ル	レ	ウ		138	㊿	㊿	㊿	㊿	㊿	㊿	㊿	㊿	㊿	㊿														
024										058	エ	ラ	ヴ	カ	ケ			139	㊿	㊿	㊿	㊿	㊿	㊿	㊿	㊿	㊿	㊿														
026	∠	⊥	(∂	∇	≡	≡	≡	√	060	A	B	Γ	Δ	E	Z	H	Θ	I	160																						
027	∞	∞	:	∂	∇	°	"	<	℃	061	K	Λ	M	N	Ξ	O	P	Σ	T	161	垂	唾	娃	哀	愛	挨	始	達														
028	∞	∞	:	∂	∇	°	"	<	℃	062	Υ	Φ	X	Ψ	Ω	Π	Ρ	Σ	T	162	葵	菫	藕	握	涯	旭	葦	蔞														
029										063	梓	庄	幹	宛	姐	虻	給	絢	綾	163	蝦	蛄	課	嘩	画	臥	芽	塊														
031										064	θ	κ	λ	μ	ν	ξ	ο	π	ρ	164	靴	杏																				
032	4	5	6	7	8	9				065	σ	τ	υ	φ	χ	ψ	ω		164																							
033	A	B	C	D	E	F	G			070	A	B	B	Γ	Δ	E	Ζ	3	164																							
034	H	I	J	K	L	M	N	O	P	071	И	Й	К	Л	М	Н	О	П	Р	С	165	威	移	維	綉	胃	蔞	衣	謂	違	異	医										
035	R	S	T	U	V	W	X	Y	Z	072	T	У	Ф	X	Ц	Ч	Ш	Ъ	Ы	166	井	亥	域	育	郁	磯	一	壺	溢	逸	190	蟹	開	海	凱	凱	隔	羊	榮	榮	榮	
036	a	b	c	d	e	f	g	h	i	073	Ъ	Э	Ю	Я						167	稻	茨	芋	鱒	允	印	咽	員	因	191	慨	概	涯	垣	基	街	該	鑿	鑿	鑿		
037	f	g	h	i	j	k	l	m	n	074	б	в	г	д	е	ё	ж	з	и	я	168	警	蛙	隔	垣	基	街	該	鑿	鑿	鑿	192	慨	概	涯	垣	基	街	該	鑿	鑿	鑿
038	p	q	r	s	t	u	v	w	x	075	б	в	г	д	е	ё	ж	з	и	я	169	警	蛙	隔	垣	基	街	該	鑿	鑿	193	慨	概	涯	垣	基	街	該	鑿	鑿	鑿	
039	z									076	к	л	м	н	о	п	р	с	т	у	170	警	蛙	隔	垣	基	街	該	鑿	鑿	194	慨	概	涯	垣	基	街	該	鑿	鑿	鑿	
040	あ	が	い	う	え	お				077	ф	х	ц	ч	ш	щ	ъ	ы	э	170	院	陰								195	額	掛	笠	壺	梶	鞆	梶	鞆	梶	鞆		
041	お	が	い	う	え	お				078	ю	я								170									196	額	掛	笠	壺	梶	鞆	梶	鞆	梶	鞆			
042	ご	さ	じ	す	せ	そ														170									197	恰	括	活	滑	滑	葛	葛	葛	葛	葛			



First Three Digits										Last Digit										First Three Digits										Last Digit										
0	1	2	3	4	5	6	7	8	9	0	1	2	3	4	5	6	7	8	9	0	1	2	3	4	5	6	7	8	9	0	1	2	3	4	5	6	7	8	9	
198	叶	梳	鞞	株	兜	甯	釜	鏃		230	掘	窟	靴	窪	窪	熊	隈	灸		261										294	夙	宿	祝	3	4	5	6	7	8	9
199	噉	鴨	栢	林	萱					231	栗	桑	吝	靴	君	薰	訓	群	軍	262										295	述	峻	春	縮	肅	熟	出	術		
200	粥	卷	瓦	乾	冠	冠	刊			232	郡									263										296	旬	殉	殉	渾	純	純	純	純		
201	勘	劉	堪	冠	寬	刊														264										297	酌	順	初	所	暑	曙	庶	遵		
202	幹	患	憤	憾	換	柜	棺													265										298	署	書	錄	諸	諸	諸	諸	諸		
203	款	飲	漢	潤	淮	環	監													266										299	恕	鋤	餘	傷	召	唱	營	妥		
204	竿	管	篋	濶	閑	閑	觀													267										300	勝	匠	升	將	哨	唱	營	妥		
205	諫	貫	遙	伍	閔	臆	館													268										301	妾	勝	匠	升	將	哨	唱	營		
206	館	丸	岸	巖	玩	眼	巖													269										302	彰	承	抄	招	昌	昭	晶	晶		
207	膺	雁	顏	願																270										303	松	樟	樵	沼	涉	湘	昭	晶		
																				271										304	紹	肖	賞	蔣	蕪	蕪	蕪	蕪		
207																				272										305	紹	肖	賞	蔣	蕪	蕪	蕪	蕪		
208	基	奇	棋	岐	希	危	喜													273										306	詳	文	賞	蔣	蕪	蕪	蕪	蕪		
209	旗	機	癸	氣	汽	織	季													274										307	文	情	擾	擊	杖	淨	狀	壤		
210	機	規	儀	貴	宜	輝	季													275										308	文	情	擾	擊	杖	淨	狀	壤		
211	紀	微	烏	疑	宜	輝	季													276										309	釀	膩	觸	植	飾	織	職	職		
212	愧	儀	疑	宜	輝	季	騎													277										310	觸	膩	觸	植	飾	織	職	職		
213	鬼	疑	疑	宜	輝	季	騎													278										311	觸	膩	觸	植	飾	織	職	職		
214	吉	吃	喫	橘	估	估	却													279										312	觸	膩	觸	植	飾	織	職	職		
215	宮	脚	愈	愈	乞	乞	吸													280										313	觸	膩	觸	植	飾	織	職	職		
216	客	窮	愈	愈	乞	乞	吸													281										314	觸	膩	觸	植	飾	織	職	職		
217	究	窮	愈	愈	乞	乞	吸													282										315	尋	甚	甚	甚	甚	甚	甚	甚		
218	巨	拒	挈	挈	挈	挈	居													283																				
219	禦	供	僑	兇	兇	兇	居													284																				
220	脚	叫	僑	兇	兇	兇	居													285																				
221	脚	叫	僑	兇	兇	兇	居													286																				
222	扶	橋	鏡	狹	狹	狹	均													287																				
223	扶	橋	鏡	狹	狹	狹	均													288																				
224	業	局	曲	斤	斤	斤	均													289																				
225	巾	錦	欣	欣	欣	欣	均													290																				
226	芹	茵	禱	禱	禱	禱	均													291																				
																				292																				
226																				293																				
227	俱	句	區	玖	矩	駭	驅																																	
228	駒	具	虞	玖	矩	駭	驅																																	
229	串	櫛	虞	玖	矩	駭	驅																																	



First Three Digits	Last Digit									First Three Digits	Last Digit									First Three Digits	Last Digit																			
	0	1	2	3	4	5	6	7	8		9	0	1	2	3	4	5	6	7		8	9	0	1	2	3	4	5	6	7	8	9								
326	接	撰	折	設	窈	節	說	雪	絕	舌	357	中	仲	宙	忠	抽	昼	柱	注	虫	衷										413	評	豹	廟	描	病	秒	苗	銚	蒜
327	蟬	仙	先	占	千	宣	專	尖	川	戰	358	註	耐	鈔	註	標	猪	犛	犛	犛	著	貯	386																	
328	扇	撰	穿	枿	杲	線	洗	染	潛	煎	359	丁	兆	喝	喉	龍						387	謎	灘	捺	鍋	檣	刷	繩	曬	南	楠								
329	煽	綻	穿	穿	穿	線					360	暢	朝	襖	牒	町	眺	眺	眼	懲	挑	388	軟	難	汝															
330	織	羨	綉	舛	舛	舛	船	薦	詔	踐	361	暢	朝	襖	牒	町	眺	眺	眼	懲	挑																			
331	邁	邁	錢	錢	錢	鮮	前	蕭	瀚	然	362	調	諜	超	跳	跳	長	頂	鳥	鳥	勅	388																		
332	全	禪	繕	膳	膳						363	直	朕	沈	珍	鎮	陳					389	虹	廿	日	乳	入													
																						390	如	尿	莖	任	妊	忍	認											
332											363																													
333	曾	楚	狙	疏	礎	祖	創	粗	粗	叢	364	槌	追	鉗	通	塚	塚	規	樞	樞	佃	390																		
334	組	蘇	訴	阻	礎	祖	創	粗	粗	叢	365	漬	柘	萬	綴	錫	積	樁	規	樞	佃	391	祈	寧	葱	貓	熱	年	念	捨	燃	燃								
335	倉	喪	壯	爽	宋	層	臣	惣	惣	想	366	孀	紉	爪	吊	釣	鶴					392	粘	乃	迺	之	楚	囊	惱	濃	納	能								
336	搜	掃	掃	掃	早	曹	梟	梟	梟	綜												393	腦	膿	農	視	蚤													
337	漕	燥	爭	瘦	相	窓	糴	送	送	鐘	366							亭	低	停	偵																			
338	草	莊	葬	薈	裝	送	送	送	送	鐘	367	剃	貞	呈	堤	定	帝	庭	廷	弟	弟	393																		
339	霜	驕	像	增	增	側	側	則	則	息	368	悌	抵	提	提	汀	禎	禎	禎	程	程	394	波	派	琶	破	瓷	麗	芭	馬	俳	配	配							
340	臆	臆	臆	臆	臆	臆	臆	臆	臆	臆	369	艇	訂	蹄	蹄	鼎	泥	擲	敵	敵	敵	395	拜	排	敗	杯	孟	牌	背	肺	輩	兄	陪							
341	捉	束	測	足	俗	屬	賊	族	族	統	370	的	的	的	的	的	的	的	的	的	的	396	陪	這	蠅	秤	矧	菽	伯	剝	博	拍								
342	卒	袖	其	擗	存	孫	尊	損	村	遜	371	的	的	的	的	的	的	的	的	的	的	397	陪	這	蠅	秤	矧	菽	伯	剝	博	拍								
343	他	多	汰	記	墮	愛	情	打	打		372	的	的	的	的	的	的	的	的	的	的	398	陪	這	蠅	秤	矧	菽	伯	剝	博	拍								
344	柁	舵	檣	舵	駢	體	堆	耐	耐		373	的	的	的	的	的	的	的	的	的	的	399	陪	這	蠅	秤	矧	菽	伯	剝	博	拍								
345	岱	帶	待	態	戴	替	泰	胎	胎		373	的	的	的	的	的	的	的	的	的	的	401	烟	昂	八	鉢	發	醜	髮	伴	判									
346	腿	苔	袋	袋	袋	袋	袋	袋	袋		374	堵	塗	妬	妬	徒	斗	杜	度	登	登	402	烟	拔	反	閱	鳩	嘶	鳩	鳩	鳩	鳩	鳩	鳩	鳩	鳩	鳩	鳩		
347	台	谷	第	第	第	第	第	第	第		375	賭	塗	途	途	徒	斗	杜	度	登	登	403	拔	反	閱	鳩	嘶	鳩	鳩	鳩	鳩	鳩	鳩	鳩	鳩	鳩	鳩	鳩	鳩	
348	宅	托	兜	兜	兜	兜	兜	兜	兜		376	怒	倒	兜	兜	徒	斗	杜	度	登	登	404	犯	班	畔	繁	繁	繁	繁	繁	繁	繁	繁	繁	繁	繁	繁	繁		
349	千	叩	辰	辰	辰	辰	辰	辰	辰		377	盜	島	島	島	徒	斗	杜	度	登	登	405	頑	飯	挽	晚	晚	晚	晚	晚	晚	晚	晚	晚	晚	晚	晚	晚	晚	
350	茸	茸	茸	茸	茸	茸	茸	茸	茸		378	盜	島	島	島	徒	斗	杜	度	登	登																			
351	棚	谷	狸	狸	狸	狸	狸	狸	狸		379	答	筒	筒	筒	徒	斗	杜	度	登	登																			
352	綻	綻	綻	綻	綻	綻	綻	綻	綻		380	董	董	董	董	徒	斗	杜	度	登	登																			
353	綻	綻	綻	綻	綻	綻	綻	綻	綻		381	鐙	鐙	鐙	鐙	徒	斗	杜	度	登	登																			
354	暖	檀	段	段	段	段	段	段	段		382	懂	撞	撞	撞	徒	斗	杜	度	登	登																			
											383	鴛	鴛	鴛	鴛	徒	斗	杜	度	登	登																			
354											384																													
355	智	池	痴	雅	置	致	致	致	致		385	鴛	鴛	鴛	鴛	徒	斗	杜	度	登	登																			
356	畜	竹	築	蓬	蓬	蓬	蓬	蓬	蓬		386	頓	頓	頓	頓	頓	頓	頓	頓	頓	頓																			



















First Three Digits	Last Digit									First Three Digits	Last Digit									First Three Digits	Last Digit									First Three Digits	Last Digit																																																																																																																																																																																																																								
	0	1	2	3	4	5	6	7	8		9	0	1	2	3	4	5	6	7		8	9	0	1	2	3	4	5	6		7	8	9	0	1	2	3	4	5	6	7	8	9																																																																																																																																																																																																												
										459	履	李	梨	理	璃	460	李	痢	裏	裡	離	陸	律	率	立	490	僉	僂	僊	僊	僊	526	墟	壘	壘	壘	壘	527	僂	僂	僂	僂	僂	528	墟	壘	壘	壘	壘	529	僂	僂	僂	僂	僂	530	墟	壘	壘	壘	壘	531	僂	僂	僂	僂	僂	532	墟	壘	壘	壘	壘	533	僂	僂	僂	僂	僂	534	墟	壘	壘	壘	壘	535	僂	僂	僂	僂	僂	536	墟	壘	壘	壘	壘	537	僂	僂	僂	僂	僂	538	墟	壘	壘	壘	壘	539	僂	僂	僂	僂	僂	540	墟	壘	壘	壘	壘	541	僂	僂	僂	僂	僂	542	墟	壘	壘	壘	壘	543	僂	僂	僂	僂	僂	544	墟	壘	壘	壘	壘	545	僂	僂	僂	僂	僂	546	墟	壘	壘	壘	壘	547	僂	僂	僂	僂	僂	548	墟	壘	壘	壘	壘	549	僂	僂	僂	僂	僂	550	墟	壘	壘	壘	壘	551	僂	僂	僂	僂	僂	552	墟	壘	壘	壘	壘	553	僂	僂	僂	僂	僂	554	墟	壘	壘	壘	壘	555	僂	僂	僂	僂	僂	556	墟	壘	壘	壘	壘	557	僂	僂	僂	僂	僂	558	墟	壘	壘	壘	壘	559	僂	僂	僂	僂	僂	560	墟	壘	壘	壘	壘	561	僂	僂	僂	僂	僂



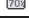
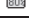

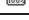

Weather Indicator List





■ Basic Status

	Clear skies (day)
	Clear skies (night)
	Cloudy
	Rain
	Snow
	Thunder showers
	Chance of rain: 0%
	Chance of rain: 10%
	Chance of rain: 20%
	Chance of rain: 30%
	Chance of rain: 40%
	Chance of rain: 50%
	Chance of rain: 60%
	Chance of rain: 70%
	Chance of rain: 80%
	Chance of rain: 90%
	Chance of rain: 100%
	Then
	Partly/chance of





■ Pollen Count

	Low
	Moderate
	High
	Extreme





■ Cherry Blossom

	Flowering
	Almost full bloom
	Full bloom
	Beginning of petal fall



■ Fall Foliage

	No color change
	Colors appearing
	Peak
	Defoliating



■ Ultraviolet

	Low
	Moderate
	High
	Extreme

■ Typhoon

	Forming
	Approaching
	Caution necessary

■ Other

	Heavy rain
	Gale
	Notification



Specifications

SoftBank 841SH	
Weight*	115 g (131 g with battery)
Continuous Talk Time*	210 minutes (3G) 220 minutes (GSM)
Continuous Standby Time*	330 hours (3G) 280 hours (GSM) (handset closed)
Charging Time (power off)*	AC Charger: 140 minutes In-Car Charger: 140 minutes
Dimensions (W x H x D)*	51 x 109.5 x 17 mm (handset closed, without protruding parts)
Maximum Output	0.25 W (3G) 2.0 W (GSM)

*Approximate value.

- Above values calculated with Backlight Brightness set to **Level:2**.
- Continuous Talk Time is an average measured with a new, fully charged battery, in strong signal conditions without moving handset.
- Continuous Standby Time is an average measured with a new, fully charged battery, with handset closed without calls or operations, in strong signal conditions without moving handset. In Japan (3G service area), the value is calculated with IP Service Setting and Mobile Widget Auto Refresh set to **Off**.
- Talk Time/Standby Time may vary with environment, status, settings, etc.

- Display employs precision technology, however, some pixels may appear brighter/darker.

Handset Materials

Parts	Materials/Finishing
Housing (Display side, Keypad side)	Reny/SUS insertion, surface coating
Housing (battery side)	Reny/Surface coating
Battery Cover, hinge cover (outer side)	PC resin & ABS resin/Surface coating
Hinge cover (inner side), Side Keys (Volume Up Key, Volume Down Key, Shutter Key), External Device Port Cover	PC resin/Surface coating
Display panel, Display back panel, camera panel (Infrared Port, Mobile Light), camera lens	Acrylic panel/Back printing
Center Key, Multi Selector (Cursor Keys), Mail Key, Yahoo! Keitai Key, Shortcuts & A/a Key, Camera & Text Key, Start & Rakutomo Link Key, Clear/Back Key, Power On/Off & End Key, Keypad, Dictionary Key, Multi Job & Manner Key, # Key, ✕ Key	UV curing resin/Back printing

Parts	Materials/Finishing
Battery	PC resin & ABS resin
Charging Terminals	SUS/Gold plating (sealer: nickel)
Screws (Display side, Keypad side, battery side)	SWCH16A/Trivalent chromate
USIM pin	Copper alloy/Gold plating (sealer: nickel)
USIM Tray	POM

Accessories

Battery

Voltage	3.7V
Battery Type	Lithium-ion
Capacity	770 mAh
Dimensions (W x H x D)*	35.4 x 46.3 x 4.6 mm (without protruding parts)

*Approximate value.

Desktop Holder

Input Voltage/Current	DC 5.4V/700 mA
Output Voltage/Current	DC 5.4V/700 mA
Charging Temperature	5°C to 35°C
Dimensions (W x H x D)*	130 x 32 x 46 mm

*Approximate value.



Getting Started

■ Standby Shortcut

Savable Items	19 per sheet (shared with widgets)
----------------------	------------------------------------

Universal Operations, Etc.

■ Text Entry

User Dictionary	250 entries (5 per reading) Word: 30 characters Reading: 8 hiragana
Acquire Dictionary	5 dictionaries
Paste List	10 text strings
Recoverable Deleted Characters	30,720 single-byte characters
Dictionary	Meikyo Japanese Dictionary: Approximately 47,100 words/phrases Genius English-Japanese Dictionary: Approximately 45,700 words/phrases Genius Japanese-English Dictionary: Approximately 55,800 words/phrases

■ Phone Book

Entry	1,000 entries
Name/Reading	Last/First: 32 characters each
Phone Number	5 numbers (32 digits each)
Mail Address	5 addresses (128 characters each)
Category	16 Categories
Address	Postal Code: 20 characters Country: 32 characters Others: 64 characters each
Office	Office Name/Division/Post: 32 characters each
Homepage	1,024 bytes
Note	256 characters
Mail Groups	20 Groups (20 members each) Group name: 16 characters

Calling

Call Log Records	Dialed: 30 Dialed Ranking: 10 Received: 30
Answer Phone/Record Caller Voice	20 messages or 90 seconds
Auto Answer List	10 numbers
Speed Dial/Mail	100 numbers/addresses

Messaging

Memory	Received Msg.	10 MB or 3,000 messages
	Drafts	5 MB (or 1,000 messages between Drafts, Sent Messages and Unsent Messages)
	Sent Messages	
	Unsent Messages	
	Templates	50 MB (shared with Data Folder and S! Appli Library)
PC Mail/S! Mail Subject	512 single-byte characters	
PC Mail/S! Mail Message	Approximately 30,000 single-byte characters	
SMS Message	160 single-byte alphanumerics	
Auto Resend	2 times	
Attachment	20 files or 2 MB*	
Send Reservation	10 messages	
Signature	256 single-byte characters	
Recipient	20 numbers/addresses	
Folder	20 folders (20 sort keys each)	
Chat Folder	Memory	300 messages per folder
	Folder	10 folders (20 members each)

Graphic Mail	1 sound or Flash® file, or 40 images/My Pictograms (with 1 sound or Flash® file)	
Auto Reply	20 numbers/addresses Reply Message: 256 single-byte characters per mode	
Sort Spam Mail	Individual	20 entries
	Permitted List	20 entries

*Limit may be lower depending on message text, etc.

■ PC Mail Settings

PC Mail Account	Account	3 accounts
	Account Name	20 characters
Set Receiving	User Name	128 characters
	Password	40 characters
	ReceivingServer	128 characters
	Port Number	1 to 65535
Set Sending	Sender Name	20 characters
	Mail Address	128 characters
PC Mail DL	Individual Address	20 addresses

Internet

Download	Yahoo! Keitai	300 KB per page 10 MB for progressive downloads
	PC Site Browser	1 MB per file
History	300 pages for Yahoo! Keitai 300 pages for PC Site Browser	
URL Entry Log	10 URLs	



Bookmarks* & Saved Pages	100 pages for Yahoo! Keitai 100 pages for PC Site Browser
Tab	3 tabs at one time
Input Memory	20 entries
Streaming History	20 URLs
RSS Feed	30 entries (60 KB per entry)

*Folders are counted as pages.

Camera & Imaging

Mobile Camera

Effective Pixels	3.2 Megapixels
Auto Shut-off Time	Approximately 3 minutes

Photo Camera

Zoom	1x - 24.8x	
Picture Size (W x H dots)	3M	1536 x 2048
	Full HD	1080 x 1920
	2M	1200 x 1600
	1.2M	960 x 1280
	VGA	480 x 640
	Wallpaper	240 x 400
	QVGA	240 x 320
	QQVGA	120 x 160
Scanner Image Size (W x H dots)	Free, 1200 x 640, 480 x 1488, 1280 x 960	
File Format	JPEG	
Memory	Approximately 49 files (at 3M, High Quality) on handset with no other files	
File Name	yymmdd_hhmmss	
Shooting Distance	Macro: 10 cm	
Other	Use transparent PNG files of 40 KB or less as Frames	

Video Camera

Zoom	1x - 8.7x	
Record Size (W x H dots)	Extended Video	320 x 240 (QVGA)
		240 x 176 (HQVGA)
		176 x 144 (QCIF)
	For Message	320 x 240 (QVGA)
		176 x 144 (QCIF)
File Format	3GP	
Recording Capacity per Shot	Extended Video	Approximately 30 minutes* on Memory Card
	For Message	2 MB or 295 KB
File Name	yymmdd_hhmmss	
Recording Distance	1.5 m in good light	

*Varies with handset usage, location or settings.

Editing Images

Picture Editor	Resize (W x H dots)	Wallpaper (240 x 400)
		Power On/Off (240 x 400)
		Incoming Call (160 x 160)
		Alarm (240 x 104)
		Mail Art (96 x 96)
		QVGA (240 x 320)
		Cut
	Retouch	52 x 52 dots or larger JPEG/PNG images
	Paste	16 characters
	Correction	52 x 52 dots or larger JPEG/PNG images
Composite	Merge	JPEG images between W 48 x H 64 dots and 240 x 320 dots
	Panorama	

Media Player

Supported Formats	WMA (.wma), AAC (.mp4/.3gp/.m4a) (Some files may not play depending on sampling frequency and bit rate)	
	All Music List	Shows up to 350 files each
	Music Chaku-Uta® WMA	

S! Applications

Memory	100 items or 50 MB (shared with Messaging Templates folder and other folders in Data Folder)
---------------	--

Handy Extras

PIM/Life

Calendar^{1/} Tasks	Schedule: 1,000 entries Tasks: 300 entries Subject: 32 characters Description: 128 characters Location: 16 characters Set Holiday: 10 holidays
Alarms	5 entries, Subject: 9 characters
Household Accounts	3,285 entries ² (9,999,999 yen each)
Calculator	999,999,999,999
Expenses Memo	50 entries (999,999.99 yen each) per list x 3 lists
Osaifu-Keitai®	Remote Lock password: 5 - 16 single-byte alphanumerics

¹ Preset holidays are based on Japanese calendar as of March 2010.

² Limit may be lower depending on the number of items in each entry.



Specifications

■ Clock/Gauge

Stopwatch	23 hours 59 minutes 59.9 seconds in 0.1-second increments Lap time: 4 records
Countdown Timer	99 minutes 59 seconds in 1-second increments
World Clock	City name: 16 characters

■ Doc./Rec.

Notepad	500 entries (8,192 characters each)	
Voice Recorder	For Message	Approximately 20 minutes (message size limit: 2 MB) or 3 minutes (message size limit: 300 KB) per file
	Extended Voice	99 hours 59 minutes 59 seconds
Scan Barcode (Continuous Mode)	UPC/JAN	50 codes
	QR Code	16 codes
Create QR Code	Equivalent of 513 digits, 311 alphanumerics or 131 kanji	
Scan Text	256 characters	

Mobile Widget

Savable Items	6 widgets (S! Quick News & S! Friend's Status: 1, others: 5) per sheet x 4 sheets
----------------------	---

Entertainment

■ S! Quick News

Savable Items	1 item for Special 5 items between News Flash and General
----------------------	--

■ e-Books

Text Copy	20 characters
------------------	---------------

■ S! Friend's Status

Member	30 members
My Status	Name: 7 characters
	Comment: 15 characters
	Status Label: 4 characters
Status Templates	Template name: 12 characters

■ S! Circle Talk

Participant	11 members
Speak Time	30 seconds each
Member List	30 entries (10 members per Group)

■ Blog Tool

Blog Details	5 entries	
Blog Title	16 characters	
Blog Settings (Mail)	Email Address	128 characters
	Title	32 characters
	Text	128 characters
	Picture Size	S (320 x 320)
		M (640 x 640) L (1024 x 1024) Send
Blog Settings (Yahoo! Keitai & PC Site Browser)	URL for Posting	1,024 characters
	URL for Viewing	1,024 characters

Data Folder

Memory	50 MB (shared with Messaging Templates folder and S! Appli Library)
---------------	---

Memory Card

Backup File Name	yymmddXX* (XX: 2 digits/letters)
-------------------------	----------------------------------

*yymmdd for Contents Keys.

Connectivity & File Backup

■ Infrared

Infrared Transfer	IrMC 1.1	
	Range	Within 20 cm

■ Bluetooth®

Communication System	Bluetooth® specification Ver. 2.1
Supported Profiles	Headset Profile
	Hands-Free Profile
	Dial-Up Networking Profile
	Object Push Profile
	File Transfer Profile
	Basic Imaging Profile
	Advanced Audio Distribution Profile
	Audio/Video Remote Control Profile
Output	Bluetooth® Power Class 2
Range	Within 10 m
Device Search	16 devices
Pairing	32 devices
Device Name	16 characters
Printing	JPEG/PNG images

■ S! Addressbook Back-up

Log	10 synchronization records
------------	----------------------------

Network

Add Network	5 Networks Country/Network code: 3 digits Name: 25 single-byte characters
--------------------	---



Reference URLs

- **SOFTBANK MOBILE Corp.**
<http://mb.softbank.jp/en/>
- **S! Addressbook Back-up**
http://mb.softbank.jp/en/price_plans/basic_option.html
- **Messaging Basics**
http://mb.softbank.jp/en/customer_support/mail.html
- **Custom Handset Address**
<https://www.email.softbank.ne.jp/help/e/address.html>
- **Yahoo! Keitai**
http://mb.softbank.jp/en/customer_support/web.html
- **Secure Remote Lock**
http://mb.softbank.jp/en/price_plans/basic_option.html
- **microSD Memory Card Compatibility**
From PC (Japanese)
http://k-tai.sharp.co.jp/peripherals/sd_support.html
From Handset (Japanese)
<http://shweb.sharp.co.jp/>
- **SVG-T**
From Handset (Japanese)
http://shweb.sharp.co.jp/svgt/index_pdc.html



Memory Card Structure & Contents

Memory Card Structure			Contents (Location when Viewed on Handset)	
DCIM	XXXSHARP		Still images in DCIM	
PRIVATE	MYFOLDER	Local Contents	SD Local Contents	
		Mail	Messaging folder backups (Received Msg., Sent Messages and Drafts)	
		My Items	Book	e-Book files in Data Folder (Books)
			Bookmarks	Yahoo! Keitai Bookmarks
			Character	PNG files in Data Folder (Character)
			Custom Screens	Customized Screen files in Data Folder (Customized Screen)
			Flash(R)	Flash® Wallpaper files in Data Folder (Flash®)
			Flash(R) Ringtones	Flash® ringtones in Data Folder (Flash® Ringtones)
			Games and More	S! Applications
			Hot Status Template	Template files in Data Folder (Status Templates)
			Mail Art	Files in Data Folder (Mail Art)
			Message Templates	Graphic Mail templates in Templates folder
			Music	Music files in Data Folder (Music)
			Other Documents	Other files in Data Folder (Other Documents)
			Pictograms	GIF files in Data Folder (My Pictograms)
			Pictures	Still images in Data Folder (Pictures)
			Sounds & Ringtones	Melodies and other sound files in Data Folder (Ring Songs-Tones)
			Videos	Video files in Data Folder (Videos)
		Widget	Widget files in Data Folder (Widget)	
	WMAudio	WMA files for Media Player (WMA)		
	SH_Folder	Application management files		
	Utility	Backup files (Phone Book), etc.		
	SHARP	MOBILE	Backup files (User Dictionary), etc.	



Menu List

Messaging

Function	Refer to	
Received Msg.	P.4-14	
Create Message	P.4-4	
Retrieve New Msg.	P.4-26	
Drafts	P.4-32	
Templates	P.4-8	
Sent Messages	P.4-14	
Unsent Message	P.4-32	
Chat Folder	P.4-17	
Server Mail Box	Mail List	P.4-26
	Retrieve All	P.4-26
	Delete All	P.4-30
	Mailbox Volume	P.4-32
Create New SMS	P.4-9	
Settings	Address Settings	P.4-3
	General Settings	P.4-33
	S! Mail Settings	P.4-35
	PC Mail Settings	P.4-20
	SMS Settings	P.4-37
	Speed Dial/Mail	P.4-22
Mail Groups	P.4-18	
Memory Status	P.4-29	

Settings: General Settings

	Function	Refer to	
Send/ Compose	Delivery Report	P.4-33	
	Reply to Settings	P.4-33	
	Reply With Text	P.4-33	
	Auto Reply	P.4-28	
	Set Quick Reply	P.4-28	
	Auto Resend	P.4-33	
	Sending Status	P.4-33	
	Restrictions Setting	P.4-10	
	Receive	Message Notice	P.4-34
		Link to Feeling	P.4-34
Animation View		P.4-34	
Sort Spam Mail	P.4-16		
Report Spam	P.4-33		
Scroll Unit	P.4-33		
Message List View	P.4-33		
Address View	P.4-33		
Received Msg. View	P.4-33		
Sent Msg. View	P.4-33		
Auto Delete	Received Msg.	P.4-33	
	Sent Messages	P.4-33	

Settings: S! Mail Settings

Function	Refer to	
Message DL	P.4-13	
Signature	P.4-23	
Picture Appearance	P.4-35	
Auto Play	Pictures	P.4-35
File	Sounds	P.4-35
Create Msg. Size	P.4-24	
Send File Settings	P.4-35	
Picture Auto Resize	P.4-35	

Settings: PC Mail Settings

Function	Refer to
PC Mail Account	P.4-20
PC Mail DL	P.4-36
Check New Mail	P.4-36
Word wrap	P.4-36

Settings: SMS Settings

Function	Refer to
Expiry Time	P.4-37
Message Center	P.4-37
Char-code	P.4-37



Yahoo!

Function	Refer to
Yahoo! Keitai	P.5-3
Menu List	P.5-3
Bookmarks	P.5-8
Saved Pages	P.5-8
Web Search	P.5-11
Enter URL	P.5-3
History	P.5-3
PC Site Browser	P.5-5
Browser Settings	P.5-12

PC Site Browser

Function	Refer to	
Homepage	P.5-5	
Bookmarks	P.5-8	
Saved Pages	P.5-8	
Web Search	P.5-11	
Enter URL	P.5-5	
History	P.5-5	
RSS Feed	P.5-9	
Yahoo! Keitai	P.5-3	
PC Site Browser Settings	Font Size	P.5-12
	Scroll Settings	P.5-12
	Cursor Settings	P.5-12
	Downloads	P.5-12
	Memory Operation	P.5-10
	Security Settings	P.5-16
	Download to	P.5-12
	Initialized Browser	P.5-16
	Reset Settings	P.5-16
	Warning Message	P.5-12
	Zoom Factor	P.5-12
	Softkey Area	P.5-5

Browser Settings

Function	Refer to
Font Size	P.5-12
Scroll Unit	P.5-12
Cursor Settings	P.5-12
Downloads	P.5-12
Memory Operation	P.5-10
Security Settings	P.5-16
Download to	P.5-12
Initialized Browser	P.5-16
Reset Settings	P.5-16

S! Appli

Function	Refer to
Application Library	P.7-7
Osaifu-Keitai	P.8-17
Settings	P.7-10
Information	P.7-11

Settings

Function	Refer to	
Application Volume	P.7-10	
Backlight	P.7-11	
Vibration	P.7-11	
Synchronization	P.7-11	
Calls & Alarms	P.7-10	
Screensaver	Switch On/Off	P.7-10
	Activation Time	P.7-10
	Stop Auto Start	P.7-10
Surround	P.7-10	
Set to Default	P.7-11	
Memory All Clear	P.7-11	

Entertainment

Function	Refer to	
S! Information Channel/ Weather	What's New	P.9-6
	Back Issue	P.9-6
	Registration/Cancel	P.9-6
	Get Latest Contents	P.9-18
	Notification	P.9-18
	Weather Indicator	P.9-6
S! Quick News	P.9-5	
Free Contents	P.9-7	
S! Contents Store	P.9-7	
S! Friend's Status	P.9-9	
S! Circle Talk	P.9-12	
Blog Tool	P.9-14	
BookSurfing	P.9-8	
e-Book Viewer	P.9-8	

S! Information Channel/Weather:
Weather Indicator

Function	Refer to	
Weather	P.9-19	
Manual Update	P.9-6	
Settings	Standby Setting	P.9-19
	Weather Notif.	P.9-19
	Icon Update	P.9-19

S! Quick News

Function	Refer to	
S! Quick News List	P.9-5	
Settings	Automatic Update	P.9-18
	Show Image	P.9-18
	Check Schedule	P.9-18
	Change Skin	P.9-18
	Delete S! Quick News Lists	P.9-18



Camera

Function		Refer to
Photo Camera		P.6-4
Video Camera		P.6-5
Scan Barcode		P.8-29
Scan Card		P.8-31
Scan Receipt		P.8-12
Kanji Grabber		P.8-33
Review		P.6-6
Photo Settings	Picture Size	P.6-15
	Picture Quality	P.6-14
	Settings	P.6-14
Video Settings	Record Time/Size	P.6-15
	Microphone	P.6-15
	Save Setting	P.6-14

Photo Camera

Function		Refer to
Shooting Settings	Exposure	P.6-14
	Focus Setting	P.6-14
	White Balance	P.6-15
Modes	Add Frame	P.6-7
	Continuous Shoot	P.6-7
	Panorama/Scanner	P.6-8
Barcode/Scan		P.8-29
Review		P.6-6
Picture Size		P.6-15
Scene		P.6-15
Picture Quality		P.6-14
Self-timer		P.6-7
Settings		P.6-14
Help		P.6-14
Mobile Light		P.6-14

Video Camera

Function		Refer to
Record Settings	Exposure	P.6-14
	Focus Setting	P.6-14
Display Size		P.6-15
Review		P.6-6
Record Time/Size		P.6-15
Microphone		P.6-15
Video Quality		P.6-14
Self-timer		P.6-7
Settings		P.6-14
Help		P.6-14
Mobile Light		P.6-14

Photo Settings: Settings

Function		Refer to
Focus Mark		P.6-14
Display Icons		P.6-14
Shutter Sound		P.6-14
Save Pictures to		P.6-14
Auto Save		P.6-14
Set Remote Shutter		P.6-14
Set Send Key		P.6-14

Video Settings: Save Setting

Function		Refer to
Save Videos to		P.6-14
Auto Save		P.6-14

Media

Function		Refer to
Music		P.7-4
Videos		P.7-5
Streaming		P.5-13
MTP Mode		P.7-3

Music

Function		Refer to
Last Played Music		P.7-8
My Music		P.7-4
WMA		P.7-4
Download Music		P.7-3
Settings	Sound Effects	P.7-8
	Playback Mode	P.7-8
	Sound Output	P.7-8
	Delete All WMA	P.7-9

Videos

Function		Refer to
Last Played Video		P.7-8
My Videos		P.7-5
Download Videos		P.7-3
Settings	Playback Mode	P.7-8
	Backlight	P.7-8
	Display Size	P.7-8
	Sound Effects	P.7-8
	Web Link Setting	P.7-8
	Sound Output	P.7-8



Tools

PIM/Life

Function	Refer to	
Calendar	P.8-2	
Alarms	P.8-8	
Relaxation Time	P.8-10	
Tasks	P.8-6	
Household Accounts	P.8-11	
Calculator	P.8-15	
Expenses Memo	P.8-16	
Osaifu-Keitai	P.8-17	
Exchange Profile	P.12-5	
Simulated Call	Receive Simulated Call	P.8-40
	Switch On/Off	P.8-21
	Set Caller	P.8-21
	Assign Tone	P.8-21
	Receive Timing	P.8-21
	For Silent Mode	P.8-40

Clock/Gauge

Function	Refer to
Stopwatch	P.8-22
Countdown Timer	P.8-23
World Clock	P.8-24
Hour Minder	P.8-25
Battery Meter	P.1-20

Doc./Rec.

Function	Refer to	
Dictionary	P.2-12	
Search	P.2-14	
Notepad	P.8-26	
Scratch Pad	P.2-15	
ASCII Art	P.8-27	
Voice Recorder	Record Time	P.8-41
	Ring Songs/Tones	P.8-28
	Save Recording to	P.8-41
Barcode/Scan	Scan Barcode	P.8-29
	Open Barcode	P.8-42
	Create QR Code	P.8-30
	Scan Card	P.8-31
	Scan Receipt	P.8-12
	Kanji Grabber	P.8-33
	Scan Text	P.8-32
Scanned Results	P.8-42	
Phone Help	P.1-20	

Connectivity

Function	Refer to	
Bluetooth	Switch On/Off	P.12-19
	Add Device	P.12-9
	Paired Devices	P.12-10
	Send All	P.12-11
	Setting Watch	P.12-19
	My Device Settings	P.12-18
IC Transmission	My Device Details	P.12-19
	1 File Reception	P.12-18
	Send All	P.12-7
USB Mode	Mass Storage	P.12-12
	MTP Mode	P.7-3
USB Charge	P.1-24	
Memory Card	P.11-6	
Backup/Restore	P.12-14	



Data Folder

Function	Refer to
Pictures	P.6-9
DCIM	P.11-2
Ring Songs-Tones	P.8-28
S! Appli	P.7-7
Widget	P.9-2
Music	P.11-2
Videos	P.11-2
Lifestyle-Appli	P.8-17
Books	P.11-2
Customized Screen	P.2-4
Status Templates	P.11-2
Flash@	P.11-2
Other Documents	P.11-2
Memory Status	P.11-2

Widget

Function	Refer to
Widget Store	P.9-2
Widget Contents	P.9-2
Settings	P.9-16

Infrared

Function	Refer to
Exchange Profile	P.12-5
Infrared On/Off	P.12-18
Send All	P.12-4

Phone

Function	Refer to	
Phone Book	P.2-16	
Add New Entry	P.2-16	
Information	P.1-24	
Call Log	P.3-8	
Play Messages	P.3-4	
Call Voicemail	P.3-13	
S! Addressbook Back-up	P.12-15	
My Details	P.1-20	
Set Category	P.2-17	
Mail Groups	P.4-18	
Rakutomo Link	P.3-7	
Speed Dial/Mail	P.3-6	
Touch-Tone Signal List	P.3-16	
Settings/ Manage	Ph.Book Settings	P.2-21
	Call Log Setting	P.3-17
	Manage Entries	P.2-22

Settings

■ Sound/Display

Function	Refer to
Mode Settings	P.1-25
Display	P.13-3
Customized Screen	P.2-4
Sounds & Alerts	P.2-5
Date & Time	P.13-2
言語選択 (Language)	P.13-3
Ringer Output	P.13-6
Earpiece Volume	P.3-15
Change Menu	P.1-17

■ Sound/Display: Display

Function	Refer to	
Wallpaper	P.2-3	
System Graphics	P.13-3	
VeilView	P.1-25	
Display Effects	P.13-3	
Font Settings	P.2-2	
Standby Display	Clock/Calendar	P.13-4
	Show Widget	P.13-4
	Show Operator Name	P.13-4
Mini Battery	P.1-25	
Greeting Message	P.13-3	
Sub-Display	Duration	P.13-4
	Messages	P.13-4
	Display Date&Time	P.13-4
	Clock Type	P.13-4
	Caller Display	P.13-4
Backlight	P.13-3	
Display Saving	P.13-3	
Dial Number	P.13-3	



■ Sound/Display: Sounds & Alerts

Function	Refer to
Volume	P.13-5
Ringtones/videos	P.2-5
Machi-Uta	P.2-5
System Sounds	P.13-6
Vibration	P.2-5
Event Light	P.13-5
Set Key Illumi	P.13-4
Status Light	P.13-5
Any Key Answer	P.13-5
Surround	P.13-6

■ Sound/Display: Date & Time

Function	Refer to
Set Date/Time	P.13-2
Time Correction	P.13-2
Daylight Saving	P.13-2
Set Time Zone	P.13-2
Clock/Calendar	P.13-4
World Clock	P.8-24
Alarms	P.8-8
Set Holiday	P.8-34
Time Format	P.13-2
Date Format	P.13-2
Calendar Format	P.13-2

■ Phone/☎

Function	Refer to	
User Dictionary	P.2-11	
Set Key Shortcut	P.1-14	
Set Key Light	P.13-4	
Double Number	Switch On/Off	P.1-21
	Double Mode	P.1-23
	Password Entry	P.1-26
	Mode Name	P.1-26
	Reject By Line	P.1-26
	Show Missed	P.1-26
	Packet Warning	P.1-26
Send Priority	P.1-26	
Memory Card	P.11-6	
Backup/Restore	Backup All Items	P.12-20
	Backup Selected Items	P.12-14
	Restore All Items	P.12-20
	Restore Selected Items	P.12-14
	Settings/Manage	P.12-20
Locks	P.10-2	
Software Update	P.14-5	
Master Reset	Reset Settings	P.13-9
	Reset All	P.13-9

■ Phone/☎: Memory Card

Function	Refer to	
DPOF	Number of Copies	P.6-13
	Settings	P.6-16
	Check Settings	P.6-13
	Reset Settings	P.6-16
SD Local Contents	P.11-8	
Format Card	P.11-6	
Memory Status	P.11-2	

■ Phone/☎: Locks

Function	Refer to
PIN Entry	P.10-2
Function Lock	P.10-2
IP Service Setting	P.13-8
Function Control	P.10-4
Application Lock	P.10-3
History Lock	P.10-3
Show Secret Data	P.10-3
Set Lock Message	P.10-5
Chg. Handset Code	P.1-19
Administrator Setting	P.1-19



■ Call

	Function	Refer to
Call Time/ Data Counter	Call Timers	P.3-9
	Data Counter	P.3-17
	Call Time Counter	P.3-17
	Minute Minder	P.3-17
Answer Phone	Switch On/Off	P.3-4
	Answer Time	P.3-14
	Outgoing Message	P.3-14
	Volume	P.3-14
Voicemail/ Divert	Voicemail	P.3-13
	Diverts	P.3-12
	Cancel All	P.3-13
	Status	P.3-19
Video Call	Camera Picture	P.3-20
	Incoming Picture	P.3-20
	Outgoing Picture	P.3-20
	Hold Guidance Pict	P.3-20
	Backlight	P.3-20
	Loudspeaker	P.3-20
	Mute Microphone	P.3-20
	Remote Monitor	P.3-14
	Show My Number	P.3-19
	 Missed Calls	P.3-13
Int'l Calling	Int'l Prefix	P.3-15
	Country Codes	P.3-15
	Roaming Dial Assistant	P.3-15
Call Barring	Bar Outgoing Calls	P.3-19
	Restrict Destinations	P.3-10
	Bar Incoming Calls	P.3-19
	Reject Numbers	P.3-11
	Auto Answer	P.3-20
	Call Waiting	P.3-19

■ Network

	Function	Refer to
	Select Network	P.13-7
	Select Service	P.13-7
	Re-search Signal	P.13-7
	Offline Mode	P.1-18
	Retrieve NW Info	P.13-7
	Location Info	P.13-8
	Network Info	P.13-7
	External Device	P.13-7



Index

A

AC Charger	1-4
Accessing Functions	1-12
Accessories	v
Administrator Code	1-19
After-Sales Services	14-39
Alarms	8-8
Canceling	8-9
Deleting	8-9
Editing entries	8-38
For Manner Mode	8-38
Link to World Clk	8-38
Animation View	4-11
Answer Phone	3-4, 3-14
Any Key Answer	13-5
Application Lock	10-3
ASCII Art	8-27
Auto Art	4-4
Auto Focus	6-2
Auto Reply	4-12, 4-28
Auto Resend	4-2, 4-33
Auto Retry Function	4-2

B

Backlight	13-3
Backup	12-13
Settings/Manage	12-20
Bar Incoming Calls	3-19
Bar Outgoing Calls	3-19
Battery	1-4, 14-4
Battery Cover	1-2
Battery Meter	1-20
Blog Tool	9-14, 9-21
Bluetooth®	12-8
Bookmarks	5-8
BookSurfing®	9-8

C

Calculator	8-15, 8-38
Calendar	8-2
Calendar Settings	8-34
Editing schedules	8-35
Call Barring	3-12, 3-19
Call Forwarding	3-12
Call Log	3-8, 3-17
Call Time Counter	3-17
Call Waiting	3-12, 3-19
Call Waiting (answering Line 2)	3-19
Caller ID	3-12, 3-19
Camera	1-2, 6-2
Auto Save	6-14
Capturing Still Images	6-4
Exposure	6-14
Locking focus	6-14
Macro	6-14
Manual Focus	6-14
Picture Quality	6-14
Recording Video	6-5
Review	6-6
Save Pictures to	6-14
Save Videos to	6-14
Self-timer	6-7
Video Quality	6-14
Center Access Code	1-19
Change PIN	10-5
Character Code List	14-12
Charging	1-4
Charging Terminals	1-2
Chat Folder	4-17, 4-31
Cleaning (handset)	14-6
Clock/Calendar	13-4
Composite	6-12
Countdown Timer	8-23
Create Msg. Size	4-24, 4-35

Create QR Code	8-30
Customer Service	14-40
Customized Screen (Japanese)	2-4

D

Data Folder	11-2
Files (attaching)	4-5, 11-3
Files (moving/copying)	11-4
Files (opening)	11-3
Files (renaming)	11-8
Folders (adding)	11-4
Selecting Multiple Files	11-4
Set Secret (folders)	11-4
Slide Show	11-3
Date & Time	13-2
Daylight Saving	8-24, 13-2
Delivery Report	4-11, 4-23, 4-33
Dialing from Call Log records	3-17
Dictionary	2-12
Display	1-2, 1-7
Display (settings)	13-3
Display Effects	13-3
Display Saving	13-3
Double Number	1-21, 1-26
Download Dictionary	2-11
DPOF	6-13
Add Date	6-16
Check Settings	6-13
For All Pictures	6-13
Index Print	6-16
Dual Mode	1-23

E

Earpiece	1-2
Earpiece Volume	3-15
e-Book Library	9-19
e-Book Viewer	9-8



e-Books (Japanese).....	9-8, 9-19
Emergency Calls.....	3-2
English.....	13-3
Event Light.....	13-5
Expenses Memo.....	8-16
External Device Port.....	1-2

F

Face Arrange.....	6-11
Feeling Mail (receiving).....	4-11
Feeling Mail (sending).....	4-5
Focus (locking).....	6-14
Focus Setting.....	6-14
Font Size.....	2-2
Format Card.....	11-6
Free Contents.....	9-7
Function Control.....	10-4
Function Lock.....	10-2

G

General Notes.....	xii
Graphic Mail.....	4-6
Group Calling.....	3-12, 3-19
Guide Usage Notes.....	ii

H

Handset Closed.....	1-2
Handset Code.....	1-19
Handset Keys.....	1-3
Handset mail address.....	4-3
Handset Open.....	1-2
Handset Parts.....	1-2
Handset Positions.....	1-2
Handset Power On/Off.....	1-6
Handset responses.....	2-5
Headphones (answering calls).....	3-14
History Lock.....	10-3
Hold.....	3-14
Hour Minder.....	8-25
Assign Tone/Video.....	8-40

For Manner Mode.....	8-40
Link to World Clk.....	8-40
Vibration.....	8-40
Household Accounts.....	8-11

I

IC Card Lock.....	8-18
IC Card Settings.....	8-18
IC Transmission.....	12-6
Indicators.....	1-9
Camera (Viewfinder).....	6-3
Display.....	1-9
Messaging (message list).....	4-12
Music Playback Window.....	7-4
Sub Display.....	1-11
Video Playback Window.....	7-5
Information window.....	1-7
Infrared.....	12-2
Receiving files.....	12-3
Sending files.....	12-4, 12-18
Infrared Port.....	1-2
Internal Antenna.....	1-2
International calls.....	3-3, 3-15
Internet.....	5-2
Accessing.....	5-3, 5-5
Basic Operations.....	5-6
Browser Settings.....	5-12
Enter URL.....	5-3, 5-5
History.....	5-3, 5-5
Saving Bookmarks/pages.....	5-8
Int'l Call.....	3-4
IP Service Setting.....	13-8

K

Kanji Grabber.....	8-33
Key Assignments.....	14-9
Keypad Lock.....	1-20

L

Language.....	13-3
---------------	------

Large Font Menu.....	2-2
Link to Feeling.....	4-34
Link to World Clk.....	8-38, 8-40
Locks.....	1-19, 10-2
Loudspeaker.....	3-16, 3-20, 9-21

M

Machi-Uta®.....	2-5
Mail Groups.....	4-18
Changing members.....	4-31
Deleting.....	4-31
Edit Name.....	4-31
Main Menu.....	1-13
Manner mode.....	1-18
Mass Storage.....	12-12
Master Reset.....	13-9
Format Card.....	11-6
Reset All.....	13-9
Reset Settings.....	13-9
Media Player.....	7-2
Playlists.....	7-6, 7-9
Memory All Clear (S! Applications).....	7-11
Memory Card.....	11-5
Format Card.....	11-6
Opening files.....	11-6
Memory Card Structure & Contents.....	14-24
Menu List.....	14-25
Camera.....	14-27
Data Folder.....	14-29
Entertainment.....	14-26
Infrared.....	14-29
Media.....	14-27
Messaging.....	14-25
Phone.....	14-29
S! Appli.....	14-26
Settings.....	14-29
Tools.....	14-28
Widget.....	14-29
Yahoo!.....	14-26
Message List View.....	4-33



- Message Notice** 4-34
- Messages (creating/sending)**.... 4-4, 4-9, 4-21
- Attachments 4-24
 - Graphic Mail 4-6
 - Inserting signature manually 4-23
 - Messaging Settings 4-23
 - Preview Message 4-4
 - Recipient status 4-22
 - Recipients (editing) 4-22
 - Restricting Outgoing Messages 4-10
 - Save to Drafts 4-23
 - Send Reservation 4-23
 - Sending from Drafts 4-32
 - Sending unsent messages 4-32
 - Set Auto Play File 4-25
 - Set Sent Cancel 4-23
 - Signature 4-23
 - Speed Dial/Mail 4-22
 - Templates 4-8
 - Using sent messages 4-32
- Messages (deleting)**..... 4-21, 4-29
- Auto Delete 4-33
- Messages (forwarding)**..... 4-32
- Messages (protecting)**..... 4-14
- Messages (receiving/checking)** 4-11
- Accessing new mail out of Standby 4-26
 - DL Size Limit 4-35
 - Mail List 4-26
 - Message List 4-12, 4-29
 - Message Window 4-12, 4-27
 - Retrieving complete S! Mail messages manually 4-13
 - Retrieving PC Mail 4-21, 4-36
 - Save to Data Folder 4-27
- Messages (sorting)**..... 4-16
- Messaging (→ SMS, S! Mail, PC Mail)**..... 4-2
- General Settings 4-33
 - PC Mail Settings 4-36
 - Receive (settings) 4-34
 - S! Mail Settings 4-35
 - Send/Compose (settings) 4-33
 - SMS Settings 4-37
- Microphone**..... 1-2
- Minute Minder**..... 3-17
- Missed Call Notification**..... 3-13
- Mobile Light**..... 1-2
- Mobile Widget**..... 9-2
- Mode Settings**..... 1-25
- Multi Job**..... 1-15
- Music (deleting)**..... 7-9
- Music (downloading)** 7-3
- Music (playing)**..... 7-4, 7-8
- My Details**..... 1-20
- Sending via Bluetooth® 12-19
 - Sending via Exchange Profile 12-5
 - Sending via IC Transmission 12-18
 - Sending via Infrared 12-18
- N**
- Notepad**..... 8-26
- Edit Text 8-41
 - Change Category 8-41
- O**
- Offline Mode** 1-18
- Optional Services**..... 3-12
- Optional Services (checking status)** 3-19
- Osaiifu-Keitai®**..... 8-17
- Balance Info 8-39
 - IC Card Settings 8-18
 - Locking 8-18
 - Set to Default 8-40
- P**
- Pager Code List**..... 14-11
- PC (connecting handset)**..... 12-12
- PC Mail** 4-2, 4-19
- PC Mail (sending)**..... 4-21
- PC Site Browser** 5-5
- Pen Light**..... 1-20
- Phone Book (deleting)**..... 2-22
- Phone Book (editing)**..... 2-22
- Phone Book (saving)**..... 2-16
- Phone Book (using)**..... 2-18
- Phone Book search**..... 2-18
- Phone Help**..... 1-20
- Picture Editor**..... 6-9
- PIN** 14-2
- PIN Entry**..... 10-2
- PIN Lock**..... 14-2
- Playlists**..... 7-6, 7-9
- Pressure Vent**..... 1-2
- Q**
- Quick Operations** 1-12
- R**
- Rakutomo Link** 3-7
- Received Msg. View** 4-33
- Record Caller Voice**..... 3-16
- Reference URLs** 14-23
- Reject (calls)**..... 3-14
- Relaxation Time**..... 8-10
- Remote Lock**..... 8-19
- Remote Monitor**..... 3-14
- Reply**..... 4-12, 4-21, 4-28
- Auto Reply 4-28
 - Opening received message for reference ... 4-28
 - Set Quick Reply 4-28
- Re-search Signal** 13-7
- Reset (→ Master Reset)**..... 13-9
- Reset All**..... 13-9
- Reset Settings** 13-9
- Restrict Destinations** 3-10
- Retrieve NW Info**..... 13-7
- Retrieving Network Information** 1-6
- Review** 6-6
- RSS Feeds** 5-9



S

- S! Addressbook Back-up** 12-15
 - Auto Sync Settings 12-20
 - Confirming password 12-20
 - Sync Log 12-20
- S! Applications** 7-7
- S! Circle Talk** 9-12, 9-21
 - Accepting requests 9-13
 - Initiating 9-13
 - IP Service Setting 13-8
 - Registering Members 9-12
- S! Contents Store** 9-7
- S! FeliCa (→ Osafu-Keitai®)** 8-17
- S! Friend's Status** 9-9, 9-20
 - IP Service Setting 13-8
 - Opening Member Status 9-10
- S! Information Channel (Japanese)**... 9-6, 9-18
 - Weather Indicator 9-6
- S! Mail** 4-2
 - Attaching Files 4-5
 - Create Msg. Size 4-24, 4-35
 - Feeling Mail 4-5
 - Graphic Mail 4-6
 - S! Mail Settings 4-35
- S! Mail (sending)** 4-4
- S! Quick News (Japanese)** 9-5
 - Automatic Update 9-18
 - Deleting items 9-18
- Safety Precautions** vi
- SAR** xix
- Saved Pages** 5-8, 5-14
- Scan Barcode** 8-29
 - Open Barcode 8-42
 - Scanning during text entry 8-42
 - Using scan results 8-42
- Scan Card** 8-31
 - Using scan results 8-44
- Scan Text** 8-32
 - Scanning and pasting during text entry... 8-44
 - Using scan results 8-45
- Scanning Receipts** 8-12
- Schedules (→ Calendar)** 8-2
- Scratch Pad** 2-15
- SD Local Contents** 11-8
- Search** 2-14
- Security Codes** 1-19
- Sent Msg. View** 4-33
- Set as Wallpaper** 11-7
- Set Date/Time** 13-2
- Set Key Light** 13-4
- Set Key Shortcut** 1-14
- Set Quick Reply** 4-28
- Set Sent Cancel** 4-23
- Set Time Zone** 8-24, 13-2
- Set to Default (S! Applications)** 7-11
- Shortcuts** 1-12
- Show My Number** 3-19
- Show Secret Data** 10-3
- Side Keys** 1-3
- Signature** 4-23
- Simple Menu** 1-17
- Simulated Call** 8-21
- Slide W paper** 2-3
- Small Light** 1-2
- SMS** 4-2
 - SMS Settings 4-37
- SMS (sending)** 4-9
 - Snooze 8-8, 8-9
- Softkeys** 1-8
- Software Update** 14-5
- Sort Spam Mail** 4-16, 4-31
- Sounds & Alerts** 2-5, 13-4
- Speaker** 1-2
- Specifications** 14-19
- Specifications (by function)** 14-20
 - Calling 14-20
 - Camera & Imaging 14-21
 - Connectivity & File Backup 14-22
 - Data Folder 14-22
- Entertainment 14-22
- Getting Started 14-20
- Handy Extras 14-21
- Internet 14-20
- Media Player 14-21
- Memory Card 14-22
- Messaging 14-20
- Mobile Widget 14-22
- Network 14-22
- S! Applications 14-21
- Universal Operations, Etc. 14-20
- Speed Dial/Mail** 3-6, 4-22
- Standby** 1-6
- Standby Shortcuts** 1-16
- Status Icon List** 1-7
- Status Templates** 11-2
- Still images (capturing)** 6-4
 - Add Frame 6-7
 - Continuous Shoot 6-7
 - Panorama Picture 6-8
 - Picture Size 6-15
 - Scanner 6-8
 - Scene 6-15
 - Shutter Sound 6-14
 - White Balance 6-15
- Still images (capturing & sending)** 6-4
- Still images (editing)** 6-9
 - Additional editing options 6-15
 - Changing sizes 6-10
 - Face Arrange 6-11
 - Merge Panorama 6-12
- Stopwatch** 8-22
- Strap Eyelet** 1-2
- Streaming** 5-4
- Sub Display** 1-2, 1-11, 13-4
- Swap Calls** 3-19
- System Graphics** 13-3
- System Sounds** 13-6



T

Table of Contents	iii
Tasks	8-6
Deleting Tasks	8-7
Editing tasks	8-36
Opening Tasks	8-7
Text (editing)	2-10
Text Entry	2-6
Emoticons	2-9
Hiragana	2-7
Hiragana to Katakana/Alphanumeric Conversion	2-9
Input/Conversion	2-20
Inserting line breaks	2-19
Inserting Phone Book entry items	2-19
Inserting spaces	2-19
Katakana	2-8
Mail & Web Extensions	2-9
One-Hiragana Conversion	2-8
Personal Mode	2-7
Pictograms & Symbols	2-8
Quick Conversion	2-9
Reset Log	2-19
Search Word	2-8
Single Kanji Conversion	2-7
Switching Entry Modes	2-6
Undo conversion or recover deleted characters	2-19
Using Character Codes	2-19
Using Pager Code	2-19
When Target Word is Not Listed	2-7
Time Correction	13-2
Touch-Tone Signal List	3-16
Troubleshooting	14-7

U

USB Charge	1-5, 1-24
User Dictionary	2-11
Deleting entries	2-20

USIM Card	14-2
USIM PIN (→ PIN)	14-2
Utility Software	12-12

V

VeilView	1-20
Vibration	2-5
Video (downloading)	7-3
Video (playing)	7-5, 7-8
Video (recording)	6-5
Display Size	6-15
Microphone	6-15
Record Time/Size	6-15
Video (recording & sending)	6-5
Video Calling	3-5
Remote Monitor	3-14
Video Calls (answering)	3-5
Video Calls (placing)	3-5
Voice Calling	3-3
Voice Calls (answering)	3-3
Voice Calls (placing)	3-3
Voice Calls (placing while abroad)	3-4
Voice Recorder	8-28
Record Time	8-41
Save and Send	8-41
Save Recording to	8-41
Voicemail	3-12
Volume (ringtones)	13-5

W

Wallpaper	2-3
Slide W paper	2-3
Warranty	14-39
Water & Dust Resistance	xv
Weather Indicator	9-6
Icon Update	9-19
Manual Update	9-6
Weather	9-19
Weather Indicator List	14-18
Widgets	9-2

World Clock	8-24
--------------------------	------

Y

Yahoo! Keitai	5-3
----------------------------	-----



Objectives

Accessing Secret Files/Entries

Data Folder	11-4
Messaging folders	4-15
Phone Book	2-17
Schedules/tasks	8-4

Accessing the Internet

From message text	4-27
From scan results	8-42, 8-45
Media Player	7-3
PC Site Browser	5-5
RSS Feeds	5-9
Yahoo! Keitai	5-3

Browsing/Viewing

e-Books	9-8
PC Site Browser	5-5
S! Information Channel	9-6
S! Quick News	9-5
Yahoo! Keitai	5-3

Calculating

Calculator	8-15
Expenses Memo	8-16
Household Accounts	8-11

Canceling/Removing

Alarm	8-9
Answer Phone	3-4
Call Forwarding	3-13
Customized Screen	2-19
Download Dictionary	2-11
Function Lock	10-2
Hour Minder	8-25
IC Card Lock	8-18
Keypad Lock	1-20
Large Font Menu	2-2
Manner mode	1-18
Offline Mode	1-18
S! Information Channel	9-6
Secret folders	4-30, 11-4
Simple Menu	1-17

Speed Dial entries	3-6
Voicemail	3-13

Changing

Font Size	2-2
Font Weight	2-2
Handset Code	1-19
Handset mail address	4-3
PIN	10-5

Changing Ringtones

Phone Book	2-17
Ringtone/videos	2-5
Via Data Folder	11-7

Composing/Sending Messages

ASCII Art entries	8-27
Feeling Mail	4-5
From Call Log records	3-17
From Internet pages	5-11
From message text	4-27
From Phone Book	2-22
From received messages	4-12
From scan results	8-42, 8-45
From Scratch Pad	2-15
From sent messages	4-32
Graphic Mail	4-6, 4-25
PC Mail	4-21
S! Mail	4-4
SMS	4-9

Copying

Calculation results	8-38
Data Folder files	11-4
From text entry window	2-10
Scan results	8-43, 8-45
Text (e-Books)	9-19
Text (Internet pages)	5-11
Text (Messaging)	4-27
Text (S! Information Channel pages)	9-19

Downloading

Content	9-7
Customized Screen	2-4
e-Books	9-8

Free content	9-7
Music	7-3
S! Applications	7-10
Video	7-3
Widgets	9-2

Exchanging Files

Bluetooth®	12-8
Exchange Profile	12-5
IC Transmission	12-6
Infrared	12-2
Mass Storage	12-12
MTP Mode	7-3

Hiding Files/Entries

Data Folder	11-4
Messaging folders	4-15
Phone Book	2-17
Schedules/tasks	8-34, 8-36

Inserting/Removing

Battery	14-4
Memory Card	11-5
USIM Card	14-3

Locking/Restricting

Application Lock	10-3
Call Log	10-3
Function Lock	10-2
Incoming/outgoing calls	3-19
Keypad Lock	1-20
Mail records	10-3
PIN Entry	10-2

Managing Schedules

Calendar	8-2
Tasks	8-6

Measuring Time

Countdown Timer	8-23
Stopwatch	8-22

Notifying Phone Number

Opening My Details	1-20
Via Bluetooth	12-19
Via Exchange Profile	12-5
Via IC Transmission	12-18



- Via Infrared 12-18
- Placing Calls**
 - By entering phone numbers 3-3
 - From Call Log records 3-17
 - From Internet pages 5-11
 - From message text 4-27
 - From Phone Book 2-18
 - From scan results 8-42, 8-45
 - International calls 3-3
 - Rakutomo Link 3-7
 - Speed Dial 3-6
 - Video Calls 3-5
 - While abroad 3-4
- Playing**
 - Answer Phone messages/caller voice 3-4
 - Files (Scan Barcode) 8-43
 - Music 7-4
 - Streams 5-13
 - Video 7-5
 - Voice files 8-28
 - Voice-mail messages 3-13
- Rejecting**
 - Calls from public phones 3-11
 - Calls from specified numbers 3-11
 - Calls from unsaved numbers 3-11
 - Withheld Caller ID 3-11
- Resetting/Formatting**
 - All settings 13-9
 - Handset 13-9
 - Memory Card 11-6
- Saving**
 - Backup 12-14
 - Captured still images 6-4, 6-7, 6-8
 - Draft messages 4-23
 - Edited still images 6-9
 - Files (Internet) 5-11
 - Files (S! Information Channel pages) 9-19
 - Graphic Mail templates 4-6
 - Mail attachments 4-27
 - Notepad entries 8-26
 - Phone Book entries 2-16
 - Recorded video 6-5
- Saving Phone Book Entries**
 - Add New Entry 2-16
 - Data Folder files 11-7
 - During a call 3-16
 - From Call Log records 3-17
 - From message text 4-27
 - From received messages 4-27
 - From scan results 8-42, 8-44
- Scanning**
 - Business cards 8-31
 - Kanji 8-33
 - QR Codes 8-29
 - Receipts 8-12
 - Text 8-32
- Searching**
 - Messages 2-14, 4-15
 - Music to download 7-3
 - Music to play 7-4
 - Notepad entries 8-41
 - Phone Book 2-18
 - Text (Internet pages) 5-11
 - Video to download 7-3
 - Video to play 7-5
 - Web Search 2-14
- Sending via Mail**
 - Data Folder files 4-5, 11-3
 - Notepad entries 8-41
 - QR Codes 8-30
 - Scan results 8-43, 8-45
 - Still images 6-4
 - URLs 5-11, 5-13
 - Video 6-5
 - Voice files 8-41
- Setting Wallpaper**
 - From attached files 4-27
 - From scan results 8-43
 - From Sound/Display menu 2-3
 - Via Data Folder 11-7
- Showing in Standby**
 - Clock/Calendar 13-4
 - Mobile Widgets 9-2
 - S! Applications 7-10
 - Standby Shortcuts 1-16
 - Wallpaper 2-3
 - World Clock 8-24
- Using as Alarm Clock**
 - Alarms 8-8
 - Hour Minder 8-25
- Using Away from Home**
 - Alarms 8-8
 - Camera 6-2
 - Hour Minder 8-25
 - Scratch Pad 2-15
 - Search 2-14
 - Voice Recorder 8-28



Warranty & Service

■ Warranty

Warranty is provided when you purchase handset.

- Check the name of distributor and date of purchase.
- Read contents and keep in a safe place.
- The warranty term is described in the warranty.

■ After-Sales Services

See **P.14-7** "Troubleshooting" before contacting SoftBank Mobile for service or repairs.

If you cannot find solutions or solve problems, contact SoftBank Mobile Customer Center, Customer Assistance (**P.14-40**) in your subscription area and provide a detailed description of the problem.

- Repairs within warranty are performed under terms and conditions described.
- Out of warranty, possible repairs are performed upon request at subscriber expense.

For other services, contact the distributor, the nearest SoftBank Shop or SoftBank Mobile Customer Center, General Information (**P.14-40**).

Replacement parts are available for 6 years after termination of production.

- SoftBank Mobile is not liable for any damages resulting from use of this product.
- SoftBank Mobile is not liable for any damages resulting from accidental loss/alteration of handset data. Keep a copy of Phone Book entries, etc. in a separate place.
- Disassembling or modifying handset may violate the Radio Law. Modified handset will not be repaired.



Customer Service

For SoftBank handset or service information, call General Information. For repairs, call Customer Assistance.

SoftBank Mobile Customer Center

From a SoftBank handset, dial toll free at **157**
for General Information or **113** for Customer Assistance

SoftBank Mobile Global Call Center

From outside Japan, dial **+81-3-5351-3491**
(International charges apply.)

Call these numbers toll free from landlines.

Subscription Area	Service Center	Phone Number
Hokkaido, Aomori, Akita, Iwate, Yamagata, Miyagi, Fukushima, Niigata, Tokyo, Kanagawa, Chiba, Saitama, Ibaraki, Tochigi, Gunma, Yamanashi, Nagano, Toyama, Ishikawa, Fukui	General Information	☎0088-240-157
	Customer Assistance	☎0088-240-113
Aichi, Gifu, Mie, Shizuoka	General Information	☎0088-241-157
	Customer Assistance	☎0088-241-113
Osaka, Hyogo, Kyoto, Nara, Shiga, Wakayama	General Information	☎0088-242-157
	Customer Assistance	☎0088-242-113
Hiroshima, Okayama, Yamaguchi, Tottori, Shimane, Tokushima, Kagawa, Ehime, Kochi, Fukuoka, Saga, Nagasaki, Oita, Kumamoto, Miyazaki, Kagoshima, Okinawa	General Information	☎0088-250-157
	Customer Assistance	☎0088-250-113

