

<b>USIM Card</b> .....	<b>1-2</b>
About USIM Card .....	1-2
USIM Card Installation.....	1-3
USIM PINs.....	1-3
<b>Parts &amp; Functions</b> .....	<b>1-4</b>
Handset .....	1-4
Display Positions.....	1-6
Key Operations in Standby .....	1-7
Display .....	1-9
<b>About Battery</b> .....	<b>1-12</b>
Before Charging .....	1-12
Battery Installation .....	1-14
Charging Battery .....	1-15
<b>Handset Power On/Off</b> .....	<b>1-16</b>
<b>Manner Mode</b> .....	<b>1-17</b>
Minding Mobile Manners.....	1-17
Manner-related Features.....	1-17
Activating Manner Mode .....	1-17
Activating Emission OFF Mode.....	1-18
Activating Driving Mode .....	1-18
<b>Standby Options &amp; Event Indicators</b> .....	<b>1-18</b>
Event Indicators.....	1-18
S! Quick News.....	1-19
Shortcuts.....	1-19

<b>Handset Menus</b> .....	<b>1-20</b>
Main Menu .....	1-20
Menu Numbers .....	1-21
Horizontal Open Menu .....	1-22
<b>Customizing User Interface</b> .....	<b>1-22</b>
Customized Screen/Familiar Usability .....	1-22
<b>Private Menu</b> .....	<b>1-23</b>
Opening Private Menu .....	1-23
Customizing Private Menu .....	1-24
Adding Shortcuts.....	1-24
<b>Simple Menu</b> .....	<b>1-24</b>
Activating Simple Menu.....	1-25
Simple Menu .....	1-25
<b>Passwords</b> .....	<b>1-26</b>
Phone Password .....	1-26
Center Access Code.....	1-26
Security Code .....	1-26
<b>Multi Task</b> .....	<b>1-27</b>
Activating Another Function.....	1-27
Switching Functions.....	1-27
Ending Current Functions.....	1-27
<b>View Blind</b> .....	<b>1-28</b>
<b>My Number</b> .....	<b>1-28</b>

## USIM Card

### About USIM Card

**Universal Subscriber Identity Module (USIM) Card is an IC card containing customer and authentication information, including handset number, and limited Phone Book entry and SMS message storage. USIM must be inserted to use 930P or Network services (calling, messaging, Internet, etc.). Turn handset off before inserting/removing USIM Card.**

USIM Card

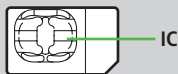

- Insert USIM Card into other compatible SoftBank handset to use information saved on USIM Card.
- Use SoftBank specified USIM Card only; non-specified USIM Cards may not function properly.
- Do not insert USIM Card into other IC card devices. SoftBank is not liable for any resulting damages.
- Keep IC portion clean.
- Do not damage, carelessly touch or short-circuit IC chip; doing so may result in loss of data or malfunction.
- Remove dust/debris with a soft, dry cloth.
- Do not place labels, etc. on USIM Card; may cause failure.
- If 930P is dropped/subjected to shock, 930P may return to Standby. This is not a malfunction.

If **USIM not inserted After power-off Insert USIM** appears, re-insert USIM Card properly then restart 930P.

### Important

- USIM Card is the property of SoftBank.
- Return USIM Card to SoftBank upon service cancellation.
- USIM Card will be reissued for a fee if lost or damaged.
- If USIM Card/930P with USIM Card inserted is lost or stolen, contact SoftBank Customer Center or Global Call Center (☎P.19-32).
- Back up USIM Card files. SoftBank is not liable for lost files.
- USIM Card specifications/performance may change without prior notice.
- Pre-installed S! Appli may be unusable while a different or replacement USIM Card is inserted into 930P.
- Returned USIM Cards are recycled.

### Note

- Some downloaded files may be inaccessible after upgrades/repairs, USIM Card/handset replacement.

## USIM Card Installation

- Remove battery (☞P.1-14) then follow steps below.

### Inserting

- 1 With IC chip down, insert USIM Card

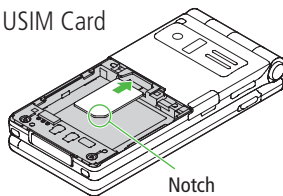

### Removing

- 1 Slide out USIM Card gently

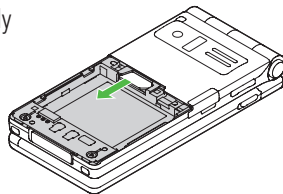

#### Note

- Do not force USIM Card into or out of 930P; may damage handset/USIM Card.
- Be careful not to lose the removed USIM Card.
- Avoid touching USIM Card terminals or IC chip; doing so may hinder performance/USIM Card recognition.

## USIM PINs

### There are two USIM Card security codes: PIN & PIN2

- PIN and PIN2 are set to 9999 by default.
- PIN/PIN2 can be changed (☞P.11-2).

<b>PIN</b>	4 to 8-digit code used to prevent unauthorized handset use. <ul style="list-style-type: none"> <li>● When <b>PIN Authentication</b> is <b>ON</b> (☞P.11-2), PIN entry is required each time handset is turned on (with USIM Card inserted).</li> </ul>
<b>PIN2</b>	Required to clear call times/costs or set maximum cost (☞P.18-8).

### PIN Lock & Cancellation (PUK)

PIN Lock or PIN2 Lock is activated if PIN or PIN2 is incorrectly entered three times. Cancel PIN Lock or PIN2 Lock by entering the PIN Unlocking Key (PUK/PUK2) (☞P.11-3).

- For information on PUK, contact SoftBank Customer Center, General Information (☞P.19-32).

#### Note

- If PUK is incorrectly entered ten times, USIM Card is locked and handset is disabled. Write down PUK.
- For procedures required to unlock USIM Card, contact SoftBank Customer Center, General Information (☞P.19-32).

# Parts & Functions

## Handset

### Normal Position

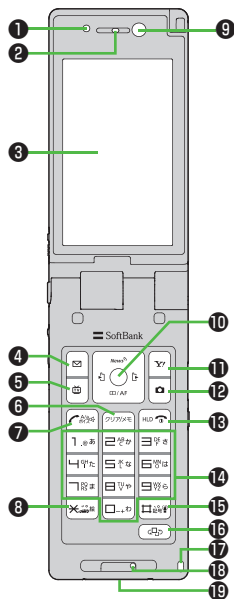

### Horizontal Open Position

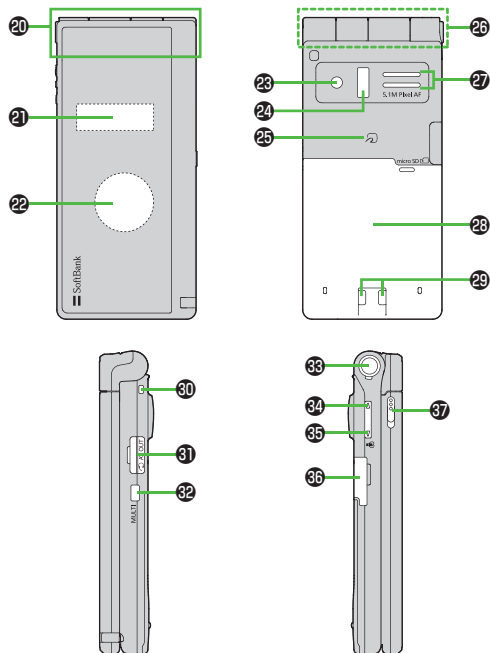
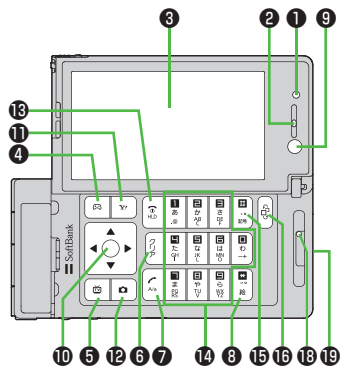

- Key labels differ between Normal Position and Horizontal Open Position. Key icons in this manual use labels in Normal Position.
- Key icons are based on key labels for handset color Silver.

- 1 Light Sensor**
- Detect ambient light
- 2 Earpiece**
- 3 Internal Display**
- 4 [Envelope] Mail Key (Normal Position)**
- Open Messaging menu
  - Execute Upper Left Softkey function (☞P.1x)
- [S] Appli Key (Horizontal Open Position)**
- Open S! Appli List
  - Execute Upper Left Softkey function (☞P.1x)
- 5 [TV] TV Key**
- Activate TV
  - Execute Lower Left Softkey function (☞P.1x)
- 6 [Clear] Clear/Memo Key**
- Delete characters or highlighted items
  - Cancel menus
- 7 [Send] Send Key**
- Initiate or answer calls
  - Toggle upper/lower case in text entry windows
  - Use Voice Dial
- 8 [Star] \*/Symbol/Driving Mode Key**
- Enter " \* "
  - Access pictographs in text entry windows
  - Toggle Driving Mode
- 9 Inside Camera**
- Use during Video Calls
  - Capture a self-portrait
- 10 [Multi] Multi Selector**
- Scroll up/down/left/right to navigate menus and text (☞P.1x)
- 11 [Yahoo! Keitai] Yahoo! Keitai Key**
- Open Yahoo! Keitai Main Menu
  - Execute Upper Right Softkey function (☞P.1x)
- 12 [Camera] Camera Key**
- Activate Camera/Video Camera
  - Execute Lower Right Softkey function (☞P.1x)
- 13 [End/Escape & Power] End/Escape & Power Key**
- Power on/off (☞P.1-16)
  - End calls
  - Return to Standby
- 14 [0] - [9] Keypad**
- Enter phone number/text
- 15 [Hash] #/Symbol/Manner Key**
- Enter " # "
  - Access symbols in text entry windows
  - Toggle Manner Mode
- 16 [Media Jump] Media Jump Key**
- Activate Yahoo! Keitai/Music Player
- 17 Horizontal Open Position Hook**
- 18 Microphone**
- 19 External Port**
- Connect AC Charger (sold separately) or other accessories here
- 20 Antenna**
- 21 External Display**
- 22 Notification Light/Charging Indicator**
- Flashes for incoming transmissions (Hikaridrops)
  - Flashes while Camera is active
  - Lights in red for charging
- 23 Outside Camera**
- 24 Infrared Port**
- Transfer data via Infrared
- 25 [Logo] Logo**
- Place Logo over a reader/writer when using Osaifu-Keitai® (☞P.16-4)

- 26 Hinge**
- 27 Speaker**
- 28 Battery Cover**
- Do not remove sticker from back of Battery Cover; IC Card may become unreadable/unwritable.
- 29 Charging Terminals**
- 30 Strap Eyelet**
- 31 Earphone/AV Output Port**
- Connect earphone/microphones or video output cables (not included) here

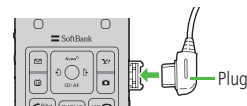

- 32 [MULTI] MULTI Key**
- Open/activate/toggle TASK MENU (☞P.1-27)
- 33 One-push Open Button (☞P.1-6)**
- 34 [Up] Upper Side Key**
- Increase TV volume
- [Closed Position]
- Toggle External Display
- 35 [Down] Lower Side Key**
- Decrease TV volume
- [Closed Position]
- Set/cancel Manner Mode
  - Check missed calls/new messages
- 36 microSD Card Slot**
- Insert microSD Card here (☞P.9-16)
- 37 Horizontal Open Lever (☞P.1-6)**

## Display Positions

Use following display positions accordingly.

### Normal Position

Press One-push Open Button to open handset.

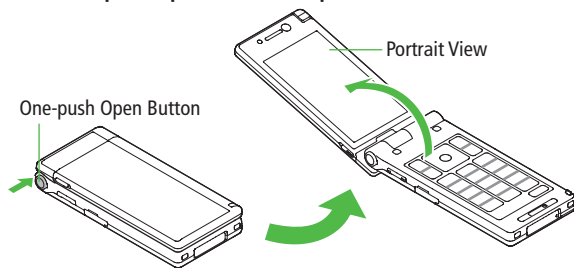

- Close handset by hand. When handset does not close, open it all the way once, then close.
- Customize handset to answer/end calls, etc. by opening/closing handset (→P.18-7, P.18-9).
- Be careful not to drop handset when opening handset by One-push Open Button.

## Horizontal Open Position

- 1 Slide and hold Horizontal Open Lever
- 2 Flip open (as indicated by arrow)  
Watch TV programs or use PC Site Browser, S! Appli, Camera, etc. in Horizontal Open Position (Landscape View).

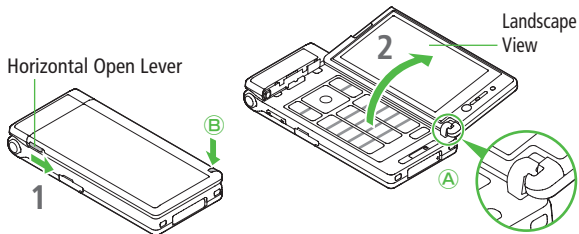

- Hinge should be intact (A). If hinge is detached, close handset and try again.  
Do not lift hinge portion (B) when opening handset.

### Note

- If One-push Open Button is pressed in Horizontal Open Position, handset opens in Normal Position after it is closed.
- Before switching positions, be sure to completely close handset. Do not operate Horizontal Open Lever when handset is not fully closed; otherwise malfunction or damage may result.

## Key Operations

- Key operations in Horizontal Open Position may differ from Normal Position.
- Keys assigned for games have different color/design labels.
- Multi Selector (  ) operations are described as pictured.

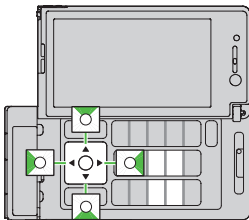

## Settings Linked with Display Position

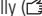





- Open handset in Horizontal Open Position to show Horizontal Open Menu while handset is in Standby (  P.1-22). Also, leave handset in Standby or activate Digital TV or Camera automatically (  P.18-12).



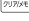

### Note



- Switching Normal Position to Horizontal Open Position may end active screen.

## Key Operations in Standby

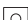
Press (less than one second) or press and hold (more than one second) a key in Standby to execute operation according to handset position.

Key Operations	Normal Position (Horizontal View)	Horizontal Open Position (Landscape View)
	Short Press	Initiate a call
	Long Press	Voice dial
	Short Press	Play/pause Flash®
	Long Press (2 + sec)	Turn off power
	Short Press	Open Main Menu
	Long Press	Activate/cancel Keyguard
	Short Press	Play Answer Phone
	Long Press	Activate/cancel Answer Phone
	Short Press	Activate Camera
	Long Press	Activate Video Camera
	Short Press	Activate Digital TV
	Long Press	Activate/cancel IC Card Lock
	Short Press	Open Messaging Menu
	Long Press	Open S! Mail Composition window
	Short Press	—
	Long Press	—
		Open S! Appli List

Key Operations		Normal Position (Horizontal View)	Horizontal Open Position (Landscape View)
	Short Press	Access Yahoo! Keitai	
	Long Press	Open Yahoo! Keitai Menu	
	Short Press	Access Yahoo! Keitai	
	Long Press	Activate Music Player	
	Short Press	Select Event Indicator, Shortcut, S! Quick News ticker	Select Event Indicator
	Long Press	—	
	Short Press	Open Phone Book search window	—
	Long Press	Open Phone Book entry window	—
	Short Press	Open Received Call Logs	—
	Long Press	Open Received address logs	—
	Short Press	Open Redial logs	—
	Long Press	Open Sent address logs	—
1	Short Press	Enter "1"	—
	Long Press	Open Phone Book page "あ"	—
2	Short Press	Enter "2"	—
	Long Press	Open Phone Book page "か"	—
3	Short Press	Enter "3"	—
	Long Press	Open Phone Book page "さ"	—
4	Short Press	Enter "4"	—
	Long Press	Open Phone Book page "た"	—
5	Short Press	Enter "5"	—
	Long Press	Open Phone Book page "な"	Turn on/off Back Light

Key Operations		Normal Position (Horizontal View)	Horizontal Open Position (Landscape View)
6	Short Press	Enter "6"	—
	Long Press	Open Phone Book page "は"	—
7	Short Press	Enter "7"	—
	Long Press	Open Phone Book page "ま"	—
8	Short Press	Enter "8"	—
	Long Press	Open Phone Book page "や"	Activate/cancel View Blind
9	Short Press	Enter "9"	—
	Long Press	Open Phone Book page "ら"	—
0	Short Press	Enter "0"	—
	Long Press	Open Phone Book page "わ"	—
*	Short Press	Enter "＊"	—
	Long Press	Activate/Cancel Drive Mode	
#	Short Press	Enter "#"	—
	Long Press	Activate/Cancel Manner Mode	
	Short Press	Increase earpiece volume	—
	Long Press	Fast increase earpiece volume	—
	Short Press	Decrease earpiece volume	—
	Long Press	Fast decrease earpiece volume	—
□ (MULTI)	Short Press	Activate TASK MENU	
	Long Press	Toggle TASK MENU	



# Display

## Internal Display Indicators

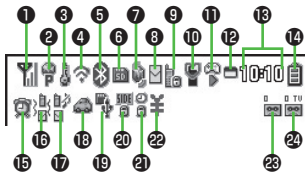

### 1 Signal Strength

Strong Moderate Weak Low

Emission OFF Mode

Out-of-Range

### 2 Packet Transmission in Progress (PC)

Dial-up Connection Established on PC

3G/GSM Packet Transmission Enabled

3G/GSM Packet Transmitting

Operator (set for Select Operator)  
Out-of-Range

3G/GSM Packet Transmission Available\*

3G/GSM Packet Transmission Unavailable\*

\* Available only while abroad

### 3 Secure Content

S! Addressbook Back-up Synchronizing

Auto Sync Settings Active

### 4 PC Site Browser Active

Infrared Active

IC Transmission

USB Cable Connected

Keypad Active

### 5 Software Update (Notification/Updating/Result)

Voice Mail

(Blue) Bluetooth® Device Connected

(Black) Bluetooth® Power Save Mode

### 6 microSD Card

Inserted

Reading/Writing Data

Write-protected

Unsupported

Unusable

### USB Cable (Not Included) Connected

microSD Mode

MTP Mode

### During Call

During Video Call

During Voice Call

















### 7 Positioning























New S! Quick News Information







### 8 Unsent Message

Unread Message

Incoming Mail Memory Full (Handset)

- 9  Privacy Key Lock Active
  -  Personal Data Lock Active
  -  Key Pad Dial Lock Active
  -  IC Card Lock Active
  -  Secret Mode and Secret Data Only Active
  -  Key Pad Dial Lock, Secret Mode and Secret Data Only Active
  -  Key Pad Dial Lock and Personal Data Lock Active
  -  Secret Mode, Secret Data Only and IC Card Lock Active
  -  Privacy Key Lock and IC Card Lock Active
  -  Personal Data Lock and IC Card Lock Active
  -  Key Pad Dial Lock and IC Card Lock Active
  -  Key Pad Dial Lock, Secret Mode, Secret Data Only and IC Card Lock Active
  -  Key Pad Dial Lock, Personal Data Lock and IC Card Lock Active
- 10  Manner Mode Active
-  User Mode Active
  -  Remote Monitoring Active

- 11 **SI Appli**
-  Paused
  -  Active
  -  Auto Start Request Received
  -  Start Request Received while Paused
  -  Start Request Received while Active
- 12  One Function Active
-  Multiple Functions Active
  -  Digital TV Active
  -  Music Playback
  -  Music Paused
- 13 Time
- 14 **Battery Level**
-  →  →  →  (Red)
- 15  (Red) Alarm Set (Today)
-  (Blue) Alarm Set (After Today)
- 16  Vibration Active (Incoming Call)
-  Vibration Active (Incoming Message)
  -  Vibration Active (Incoming Call/Message)
- 17  Incoming Call Ringtone Disabled
-  Incoming Message Ringtone Disabled
  -  Incoming Call/Message Ringtone Disabled
- 18  Driving Mode

- 19  Switching USB Mode to microSD Mode
-  Switching USB Mode to MTP Mode
- 20  Side Key Disabled when Handset Closed
- 21  Timer Lock at Close Active
- 22  Call Charge Reached Upper Limit
- 23  Number of Answer Phone Messages (Voice Calls)
- 24  Number of Answer Phone Messages (Video Calls)

**Note**

- To show icon description: **Main Menu**  
 ► **Settings** ► **Display Settings**  
 ► **Describe Icons** ►  to highlight an icon

## External Display Indicators

- Upon closing handset, External Display lights up and goes out in 15 seconds.

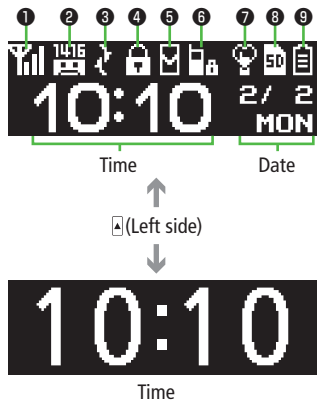

### 1 Signal Strength

Strong Moderate Weak Low

Emission OFF Mode

Out-of-Range

### 2 Voice Mail

Software Update (Notification/Updating/Result)

Bluetooth® Device Connected

Bluetooth® Power Save Mode

### 3 S! Addressbook Back-up Synchronizing

### 4 Keyguard Active

### 5 Unsent Message

Unread Message

Incoming Mail Memory Full (Handset)

### 6 Privacy Key Lock Active

Personal Data Lock Active

Key Pad Dial Lock Active

IC Card Lock Active

Secret Mode and Secret Data Only Active

Key Pad Dial Lock, Secret Mode and Secret Data Only Active

Key Pad Dial Lock and Personal Data Lock Active

Secret Mode, Secret Data Only and IC Card Lock Active

Privacy Key Lock and IC Card Lock Active

Personal Data Lock and IC Card Lock Active

Key Pad Dial Lock and IC Card Lock Active

Key Pad Dial Lock, Secret Mode, Secret Data Only and IC Card Lock Active

Key Pad Dial Lock, Personal Data Lock and IC Card Lock Active

### 7 Manner Mode Active

User Mode Active

Remote Monitoring Active

### 8 microSD Card

Inserted

Reading/Writing Data

Write-protected

Unsupported

### USB Cable (Not Included) Connected

microSD Mode

MTP Mode

### 9 Battery Level

## About Battery

### Before Charging

Charge battery before use or after a period of disuse.  
(AC Charger sold separately)

### Charging Time & Operating Time Estimates

		3G	GSM
<b>Charging Time</b>		130 minutes*	
<b>Standby Time</b>		650 hours*	390 hours*
<b>Talk Time</b>	<b>Voice Call</b>	220 minutes*	240 minutes*
	<b>Video Call</b>	130 minutes*	—

\* Approximate value

- 3G Mode/GSM Mode:  P.2-11
- Charging time is an average measured within temperatures of 5°C to 35°C.
- Talk Time is an average measured with a new, fully charged battery, with stable signals.
- Standby Time is an average measured with a new, fully charged battery, with handset closed without calls or operations, in Standby with stable signals.
- Talk Time and Standby Time may vary by environment (battery status, temperature, etc.).

## About Battery

- Clean handset, battery & charger with dry cotton swab.
- Replace battery if operating time shortens noticeably.
- Charge battery at least once every six months.
- Use a case when carrying battery separately.
- Battery may swell as service life nears end; this is not a problem.

### Charging

- Battery must be installed to charge it.
- It may take longer for charging when handset is on.
- Move charger away from TV/radio if interference occurs.

## Battery Time

- Using handset in poor conditions may shorten battery time.
  - Extreme temperatures
  - Impaired handset, battery or Charging Terminals
  - Signal is weak/handset is out-of-range
  - 930P is left mid-operation (not in Standby)
  - Viewing TV, playing music or using S! Appli, etc.
- Extending battery time
 

Example:

  - Turn Back Light Time **OFF** and Power Saver Mode **ON** (☞P.18-5)
  - Select **OFF** for Key Tone (☞P.18-2)

## When Battery Runs Out

### ● Unless a Call is in Progress

- A message appears and warning tone sounds for 10 seconds. Warning tone ends automatically after one minute; press any key except   to cancel warning tone manually. Charge or replace battery.
- If Manner Mode is active, nothing sounds.
  - When handset is closed, press  (MULTI) to cancel warning tone.

### ● During a Call

- A message appears and warning tone sounds via Earpiece or Speaker. After 20 seconds, call ends and 930P shuts down in 60 seconds. Charge or replace battery.

## Battery Strength Indicator

- Battery Strength indicator changes as remaining usage time decreases. Charge or replace battery when battery level is low (☞P.1-10, 1-11) or a message appears on Display.

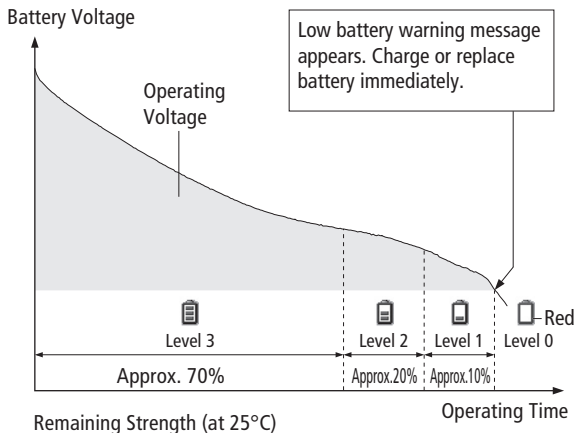

### Note

- Alternatively, check battery level from **Main Menu** ► **Settings** ► **Phone Settings** ► **Battery** ► **Battery Level**

## Battery Installation

- Always turn off handset power before removing battery.

### 1 Press and slide to remove cover

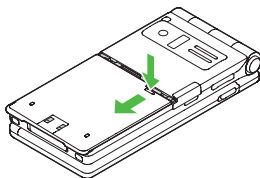

### 2 Insert Battery

Align battery contacts with handset pins.

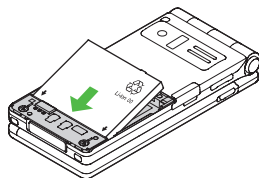

### Remove Battery

Lift battery out as shown.

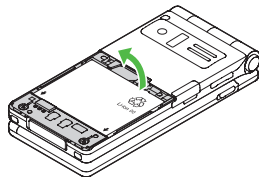

### 3 Replace battery cover

Cover should click into place.

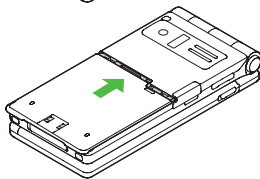

#### Note

- Lithium-ion batteries are valuable and recyclable resources.
  - Recycle used lithium-ion battery at a shop displaying the symbol shown to the right.
  - To avoid fire or electric shock, do not:
    - Short-circuit battery
    - Disassemble battery



Li-ion 00

## Charging Battery

Use only specified AC Charger (sold separately).

Charging Time: Approximately 130 minutes

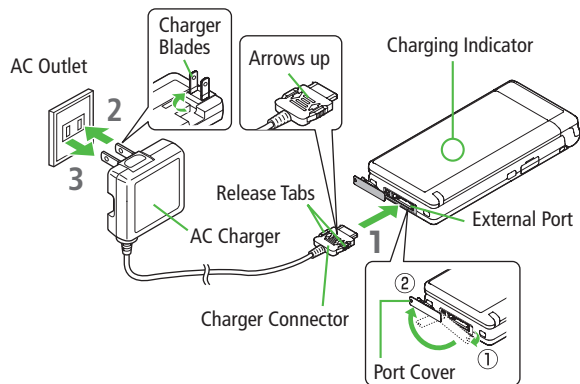

### 1 Connect AC Charger to handset

Insert Charger Connector (printed side up) into External Port.

### 2 Plug AC Charger into AC Outlet

Extend Charger Blades.

Charging Indicator illuminates and charging starts.

When charging is complete, Charging Indicator goes out.

- When Charging Indicator flashes, remove AC Charger and battery from handset then attach them again.

- **Charge Sound** is heard when charging starts/ends. (☞P.18-2)  
When handset is turned off or in Manner Mode, nothing sounds.

### 3 When charging is complete, unplug AC Charger, then disconnect handset

Squeeze Release Tabs to remove Charger Connector, and replace Port Cover.

#### Note

- For details, read AC Charger instructions.

## Handset Power On/Off

### 1 Press and hold

Start-up window ([P.18-3](#)) appears and handset enters Standby.

- Enter PIN if PIN Authentication is ON ([P.11-2](#)).

### 2 Press for 2+ seconds

Handset shuts down.

- Do not turn on handset immediately after turning off. Wait a few seconds.

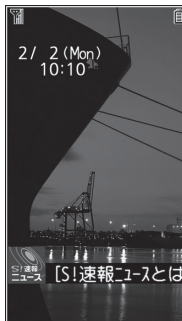

Standby

### The First Time 930P Powers Up, and Setup Window Appears...





Select **YES**, and set the following:  
(Each item can be set separately.)

- Set date and time (Date & Time: [P.18-8](#))
- Set Phone Password  
Enter "9999", and enter new Phone Password (4-8 digits). ([P.1-26](#))
- Set Key Tone  
Select **ON** or **OFF**. ([P.18-2](#))
- Set font size  
Set Display font size all at once. ([P.18-6](#))

#### Note

- If **USIM not inserted After power-off Insert USIM** appears, clean and properly re-insert USIM Card then restart 930P.
- After a period of inactivity, Display turns off.

### Retrieving Network Information

When , ,  or  is pressed for the first time in Standby, 930P initiates Network Information retrieval;  to retrieve it.

- Update Network Information to use messaging, Internet, etc.
- Update Network Information manually: **Main Menu** ► **Settings** ► **Connectivity** ► **Retrieve NW Info** ► **YES**



# Manner Mode

## Minding Mobile Manners

Please use your handset responsibly. Use these basic tips as a guide. Inappropriate handset use can be both dangerous and bothersome. Please take care not to disturb others when using your handset. Adjust handset use according to your surroundings.

- Turn it off in theaters, museums and other places where silence is the norm.
- Refrain from use in restaurants, lobbies, elevators, etc.
- Observe signs and instructions regarding handset use aboard trains, etc.
- Refrain from use that interrupts the flow of pedestrian or vehicle traffic.

## Manner-related Features



<b>Manner Mode</b> (☞P.18-2)	Press Manner key to mute 930P tones and activate vibration for incoming transmissions.
<b>Vibration Mode</b> (☞P.18-2)	Activate in public places, meetings, etc. for silent call/message alerts.
<b>Ringer Volume</b> (☞P.18-2)	Mute call/message tones.
<b>Emission OFF Mode</b> (☞P.1-18)	Suspend all 930P transmissions.
<b>Answer Phone</b> (☞P.2-15)	Use to handle incoming calls when inappropriate/unsafe to answer.
<b>Driving Mode</b> (☞P.1-18)	While driving, send a voice message informing the caller that you cannot answer the call. (Handset does not ring.)

## Activating Manner Mode

Press one key to mute 930P tones and vibration for incoming transmissions.

- Manner Mode settings can be changed (☞P.18-6).
- When Manner Mode is active,  appears.

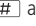
1 In Standby, press and hold 

- To cancel: Press and hold  again
- To activate/cancel while handset is closed: Press and hold 



### Note

- Shutter click and incoming tone via Earphone (**Level 1**) sound even in Manner Mode.
- Music Player files or Digital TV programs are initially muted in Manner Mode. When Music Player or Digital TV activates in Manner Mode, confirmation appears asking whether to cancel Manner Mode.
- When **Prefer manner mode** is **OFF** (☞P.12-7), Alarm sounds even if Manner Mode is active.

### Tip

- **Settings** ● Set Manner Mode Type (☞P.18-6)

## Activating Emission OFF Mode

Temporarily suspend all 930P transmissions; when active, all calls/messages and incoming information are blocked.

- When Emission OFF Mode is active,  appears.

**Main Menu** ► **Settings** ► **Call Settings** ► **Emission OFF Mode**

### 1 YES

- To cancel: Follow the same steps.

#### Note

- Emission OFF Mode disables Bluetooth®/Infrared/IC transmissions. Bluetooth® handsfree devices cannot be used either.

## Activating Driving Mode

Handset does not ring for incoming calls. Voice guidance informs the caller you are unavailable and Answer Phone activates.

- When Driving Mode is active,  appears.

### 1 In Standby, press and hold

- To cancel: Follow the same step.

#### Note

- When Answer Phone memory is full, incoming calls are rejected.

## Standby Options & Event Indicators

### Event Indicators

Event Indicators appear for missed calls, messages, etc.

### 1 → Select an indicator

- To clear indicators:  or 



### ■ Events

<b>Call</b>	Missed calls ( <a href="#">☞P.2-13</a> )
<b>Message</b>	New messages ( <a href="#">☞P.13-10</a> )
<b>Answer Phone</b>	Recorded caller messages ( <a href="#">☞P.2-16</a> )
<b>Voice Mail</b>	Unanswered call forwarded to Voice Mail Center ( <a href="#">☞P.2-19</a> )
<b>Missed Call</b>	If Missed Call Notification is active, indicator appears for calls missed while handset is off, out-of-range, engaged, etc. ( <a href="#">☞P.2-19</a> )

### ■ Other Information

- Missed alarm ([☞P.12-7](#))
- USB Mode setting ([☞P.10-11](#))
- Missed location information request ([☞P.17-3](#))
- Auto location information result ([☞P.17-3](#))
- Timer ([☞P.5-13](#))
- Content Key ([☞P.9-5](#))
- Software Update result ([☞P.19-12](#))

#### Note

- Call operations are available while Event Indicators appear.

## S! Quick News

By default, S! Quick News appears at bottom of Display.

- Show/hide S! Quick News:  P.7-2
- S! Quick News:  P.18-14



S! Quick News



## Shortcuts

Access frequently used functions from Standby.

### Adding Shortcuts



- 1 Open a function,  [Menu] →  
*Add shortcut icon* → YES

### Accessing Functions from Shortcuts

- 1 In Standby,  → Select an icon  
The selected function name appears above icon.
  - To clear:  or 



### Editing/Deleting Shortcuts

- 1 In Standby,  → Highlight an icon, and press  [Menu]
- 2 **Edit Title**  
*Edit title* → Edit title  
**Delete Shortcut(s)**  
*Delete this* or *Delete all* → YES

# Handset Menus

## Main Menu

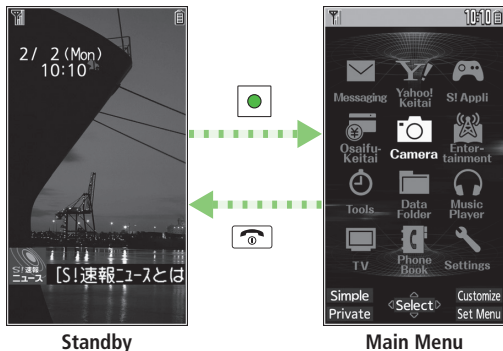

Standby

Main Menu

### 1 In Standby,

Main Menu appears.

- To change Main Menu theme:  
 [Set Menu] → Select a pattern

### 2 to highlight an icon →













Selected function menu appears.

- To return to Standby: 

#### Note

- Standby window returns after 15 seconds of inactivity in Main Menu.

## Main Menu Icons

<b>Messaging</b>  Messaging Create new/view received messages	<b>Yahoo! Keitai</b>  Yahoo! Keitai Enjoy Mobile Net & PC Site browsing...	<b>S! Appli</b>  S! Appli Download, set and use S! Appli
<b>Osaifu-Keitai</b>  Osaifu-Keitai® Use Osaifu-Keitai®	<b>Camera</b>  Camera Capture images or record video clips	<b>Entertainment</b>  Entertainment Use S! Quick News or E-Books
<b>Tools</b>  Tools Set Alarm or save Calendar entries...	<b>Data Folder</b>  Data Folder Open files saved on 930P/microSD Card	<b>Music Player</b>  Music Player Use Music Player
<b>TV</b>  TV View TV or record/timer-record programs	<b>Phone Book</b>  Phone Book Save entries to call or send messages...	<b>Settings</b>  Settings Adjust/customize handset settings

Tip

- Settings** ● Change Display Color Scheme (P.18-3) ● Change Main Menu Icons ● Change Main Menu Background (P.18-4)

## Menu Numbers

Use keypad to select functions or menu items.

### Unnumbered Menu Items

When numbers do not appear, select items as shown.

#### Main Menu

[#] to select **Settings** from Main Menu

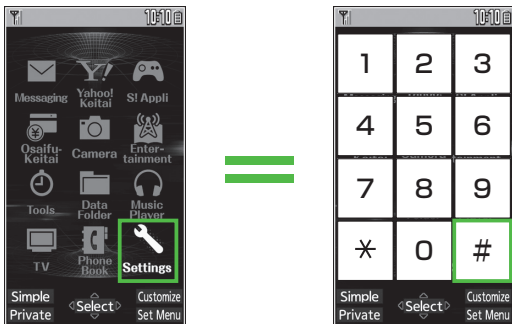

Example: Menu Icons set to Pattern 1

\* Press [0] to open Account Details. To open Phone Book top menu, use [Phone Book icon] to highlight **Phone Book**.

### When Menu Icons is Set to Pattern 5 or Customize

Menu cannot be selected from Main Menu by keypad.

Open menu items by entering specific number in Main Menu (Quick Open Menu: P.19-13).

#### Top Menu Opened from Main Menu

[2] to select **Display Settings**

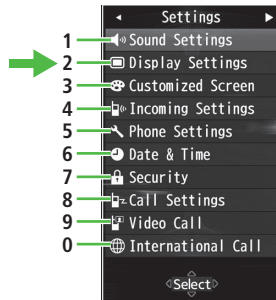

Example: Settings Top Menu

### Numbered Menu Items

Press key corresponding to menu number to select a menu.

In Display Settings (from **Settings** Top Menu), [5] to select **Menu Icons**

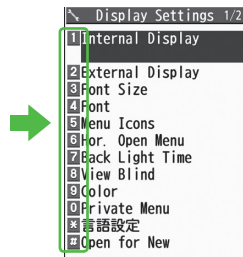

## Horizontal Open Menu

In Standby, open handset to Horizontal Open Position to access Horizontal Open Menu. From Horizontal Open Menu, access functions available in Horizontal Open Position.

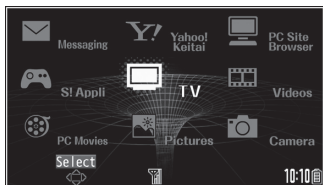

- Default Horizontal Open Menu varies by handset color (☞P.18-20).
- Press  to go from Horizontal Open Menu to Standby.
- Set handset to open to Standby, Digital TV or Camera for Horizontal Open Position (☞P.18-12).
- Some operations and menu items in Horizontal Open Menu differ from those that appear in this manual.

## Customizing User Interface

### Customized Screen/Familiar Usability

<b>Customized Screen</b>	Download and set Customized Screen to personalize user interface, ringtone, etc., to a selected theme.
<b>Familiar Usability</b>	Download Familiar Usability applications that mimic the interface design of other handsets.

### Downloading Customized Screen/Familiar Usability

Download characters or applications from websites.



Main Menu ► Data Folder ► Customized Screen

#### 1 *Customized Screen* or *Familiar Usability*

Website providing characters or applications appears.  
Follow onscreen instructions.

- To manage Customized Screen applications in Data Folder:  
☞P.9-10

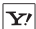
## Setting Customized Screen/Familiar Usability

- 1 In Standby, 
- 2  [Customize] → *Customized Screen* or *Familiar Usability*
- 3 Highlight a theme, and press  [Set]
  - To toggle thumbnail and list:  [Change]
- 4 **YES**

### Note



- Customized Screen or Familiar Usability cannot be set when battery is low.
- Other functions are not available while switching. For some seconds after switching is complete, all calls/messages may be blocked.
- Familiar Usability does not completely remake handset.
- Alternatively, **Main Menu ▶ Settings ▶ Customized Screen**  
To cancel, select **Release Settings**.
- When Simple menu is active, Customized Screen and Familiar Usability settings are not reflected. To reflect settings, cancel Simple menu.

## Private Menu

Save frequently used functions in Private Menu.

- Up to 12 items can be saved.
- Change preset functions as needed.

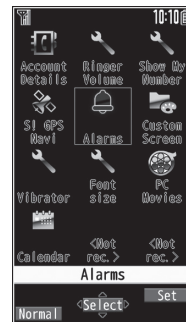

### Opening Private Menu

- 1 In Standby,  →  [Private]  
Private Menu appears.
  - To return to Main Menu:  [Normal]
- 2 Select a menu

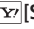

Private Menu Window

### Changing Private Menu Background

After Step 1,  [Set] →  [Menu] → *Change BG image* → Select a folder → Select an image

## Customizing Private Menu

- 1 In Standby, → [Private] → [Set]
- 2 Highlight a target, and press [Menu] → **Add to menu**
- 3 Select an item

### Canceling Functions

In Step 3, (highlight a function,) [Menu] → **Release this** or **Release all** → YES

### Reset Private Menu

In Step 3, [Menu] → **Reset menu** → YES



Private Menu Setting Window

## Adding Shortcuts

- 1 In Standby, → [Private] → [Set]
- 2 [Menu] → **Add shortcut icon**

### Note

- Alternatively, open Private Menu setting window from **Main Menu** ► **Settings** ► **Display Settings** ► **Private Menu**

## Simple Menu

Activate Simple menu to limit menu options to basic ones.

- Handset is limited to basic operations (☞P.1-25).



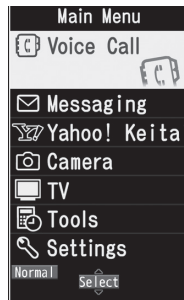

Normal Mode Window



Simple Menu Window



## Activating Simple Menu

1 In Standby,  →  [Simple] → **YES**

2 **YES** or **NO**

- Select **YES** to set all items in Font Size (P.18-6) to **Large**.
- To open Simple menu:  in Standby.

### Canceling Simple Menu

In Standby,  →  [Normal] → **YES**

#### Note

- Turning off the power does not cancel Simple menu.
- S! Quick News is not available in Simple menu. Customized Screen or Familiar Usability setting is canceled.

## Simple Menu

Simple Menu	Page	Simple Menu	Page
<b>Voice Call</b>		<b>TV</b>	
Outgoing Log	2-13	Watch TV	5-5
Incoming Log	2-13	Timer Recording	5-13
Phone Book	4-6	Channel Setting	5-4
Create New Phone Book Data	4-3	<b>Tools</b>	
Answer Phone	2-15	Data Folder	9-2
Account Details	1-28	Alarms	12-7
<b>Messaging</b>		Calendar	12-2
Incoming Mail	13-10	Calculator	12-8
Create New	13-4	Notepad	12-9
Retrieve New	13-14	Infrared	10-3
Drafts	13-15	<b>Settings</b>	
Sent Messages	13-15	Ringtones/Volume	1-17 18-2
Create New SMS	13-7	Screen/Fonts	18-3 to 18-6
<b>Yahoo! Keitai</b>		Call Time & Cost	18-8
Yahoo! Keitai	14-2	Date & Time	18-8
Bookmarks	14-8	Security	11-2 16-5 19-11
Saved Pages	14-8	Call Settings	2-17 2-21
Enter URL	14-4	<b>Camera</b>	
<b>Camera</b>		Take Pictures	6-5
Take Pictures	6-5	See Pictures	6-10
See Pictures	6-10	Shoot Videos	6-6
Shoot Videos	6-6	Watch Videos	6-10
Watch Videos	6-10		

## Passwords

Phone Password, Center Access Code and Security Code are needed for 930P use.

### Phone Password

<Default> 9999

**4 to 8-digit number required to use/change some handset functions.**

- Enter number within 15 seconds.
- \_ appears for each digit entered.
- Phone Password can be changed on 930P (☞P.11-2).

### Center Access Code

**4-digit number specified at initial subscription; required to access Voice Mail via landlines or subscribe to fee-based information.**

- Do not attempt to change Center Access Code. For details, contact SoftBank Customer Center, General Information (☞P.19-32).

## Security Code

**4-digit number specified at initial subscription, required to restrict handset services (☞P.2-20).**

- Enter number within 15 seconds.
- If entered incorrectly three times, Security Code settings lock; Security Code & Center Access Code must be changed. Reach SoftBank Customer Center, General Information (☞P.19-32) for details.
- Security Code can be changed on 930P (☞P.2-21).

### Note

- Write down Phone Password, Center Access Code and Security Code.
- Do not reveal Phone Password, Center Access Code and Security Code. SoftBank is not liable for misuse or damages.
- For details, contact SoftBank Customer Center, General Information (☞P.19-32).

## Multi Task

Activate up to three functions from four different groups at the same time.

Group	Function
① Messaging Group	Messaging
② Yahoo! Keitai/S! Appli Group	Yahoo! Keitai/S! Appli/Entertainment/Osaifu-Keitai (Lifestyle-Appli)
③ Tools Group	Music Player*/Camera/Tools/Data Folder/TV/Phone Book
④ Settings Group	Settings/Osaifu-Keitai (IC Card Settings)

\* Functions other than Tools Group are included.

- [▼] appears above the icons of an active group.
- [ ] appears for single function in use; [ ] for multiple functions in use.

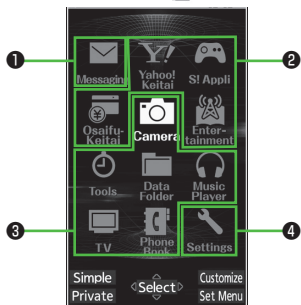

### Tip

- Use Other Functions while Watching TV (P.5-8)
- Using Other Functions while Listening to Music (Play Background) (P.8-7)

## Activating Another Function

Activate another function from a different group. Multi Task is unavailable when Simple menu is active.

- 1 [ ] (MULTI) → *Open Menu* →  
Select a function

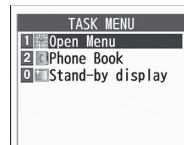

TASK MENU Window

### Note

- If another function is selected from same group, confirmation appears. Select **YES** to cancel current function and start a new function.

## Switching Functions

- 1 Press and hold [ ] (MULTI)  
Each press cycles through activated functions.

### Selecting a Function from TASK MENU

- 1 [ ] (MULTI) → Select a function

## Ending Current Functions

- 1 [ ] (MULTI)

### Ending All Active Functions

- 1 [ ] (MULTI) → [END] → **YES**

## View Blind

Activate View Blind to protect Display from prying eyes.

Main Menu ► Settings ► Display Settings ► View Blind

1 *ON*

2 Select a level

- Set level 1-3 (Level 3 is the highest level).

### Note

- Alternatively, press and hold [8] to activate/cancel. Previously selected level takes priority.
- View Blind cannot be activated: While in Standby (Normal Position only); while S! Appli is active; while Privacy Key Lock is active; during All Reset

## My Number

Confirm handset phone number in Account Details (☞P.4-13). Also confirm data saved in Account Details: name, mail address, etc.

- 1 In Standby,  →
- Account Details appears.

