

Support

Customer Service

■ Call these numbers toll free from landlines.

Subscription Area	Service Center	Toll Free Number
Hokkaido, Aomori, Akita, Iwate, Yamagata, Miyagi, Fukushima, Niigata, Tokyo, Kanagawa, Chiba, Saitama, Ibaraki, Tochigi, Gunma, Yamanashi, Nagano, Toyama, Ishikawa, Fukui	General Information	0088-240-157
	Customer Assistance	0088-240-113
Aichi, Gifu, Mie, Shizuoka	General Information	0088-241-157
	Customer Assistance	0088-241-113
Osaka, Hyogo, Kyoto, Nara, Shiga, Wakayama	General Information	0088-242-157
	Customer Assistance	0088-242-113
Hiroshima, Okayama, Yamaguchi, Tottori, Shimane, Tokushima, Kagawa, Ehime, Kochi, Fukuoka, Saga, Nagasaki, Oita, Kumamoto, Miyazaki, Kagoshima, Okinawa	General Information	0088-250-157
	Customer Assistance	0088-250-113

Emergency Numbers

- Police..... **110**
- Fire & Ambulance..... **119**
- Coast Guard..... **118**

More Information

- **Handset User Support**
Via Yahoo! Keitai Main Menu: From above search field, Select **メニューリスト** → **English** → **User Support**.
- **Online English Manual**
<http://www.softbank.jp/mb/r/support/921p/>
May be unavailable at purchase. Call Customer Service or try later.



March 2012,
Second Edition
3TR100085AAA

SoftBank 921P

First Step Guide

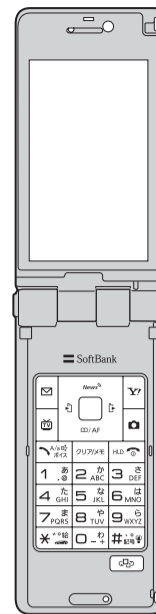

Customer Service

Emergency Numbers

More Information

Use English Interface

Call Abroad from Japan

Customize Handset Address

and more...

Safety Precautions

- **Use specified battery, charger and holder.**
The use of devices other than those specified may result in malfunction of handset or battery. Leaking, overheating, explosion or fire may occur.
- **Do not get handset, battery and charger wet.**
If liquids such as water or pet urine get into battery and charger, they may cause overheating, electric shock or malfunction. Do not use handset in damp places like bathrooms.
- **Do not use handset while driving a vehicle.**
Doing so may interfere with safe driving and cause an accident. Stop your vehicle to park in a safe place before using handset. Drivers using handsets while driving are subject to prosecution.
- **Do not throw or otherwise subject to strong force or impacts.**
Battery may leak, overheat, explode, catch fire, or cause damage to handset.
- **Turn off handset where use is prohibited, such as aboard aircraft or in hospitals.**
Handset may interfere with the operation of sensitive devices and electronic medical equipment. Follow the instructions given by the respective medical facilities regarding the use of mobile phones on their premises. In addition, actions such as speaking on a mobile phone aboard aircraft are prohibited and may be punishable by law.
- **Do not disassemble or modify handset.**
May cause accidents such as fire, bodily injury, electric shock or equipment malfunction.
- **Keep handset off and charger disconnected in filling stations or places where flammable gas is generated.**
Handset use in such areas may lead to fire.
- **Do not use or leave handset or related hardware in locations subject to high temperatures, such as near an open flame/heater, in sunlight or inside a car on an extremely hot day.**
Do not charge, leave, use, or be carrying handset or related hardware in a warm place or where heat collects, such as under a kotatsu (blanketed warming table) or electric blanket, next to a kairo (worn warming patch), etc.
Battery may leak, overheat, explode, or ignite. Handset or related hardware may deform or malfunction. Part of the casing may also become hot and cause burns.

For more information, see "Safety Precautions" in User Guide (Japanese).

Handling Precautions

General Notes

- **SoftBank is not liable for damages from accidental loss/alteration of handset/microSD Card information (Phone Book entries, image/sound files, etc.). Back-up important information.**
- **Handset transmissions may be disrupted inside buildings, tunnels or underground, or when moving into/out of such places.**
- **Use handset without disturbing others.**
- **If handset is left with no battery or an exhausted one, data may be altered/lost. SoftBank is not liable for any resulting damages.**
- **Handset use near landlines, TVs or radios may cause interference.**

- **Beware of eavesdropping.**
Digital signals reduce interception, however transmissions may be overheard. Deliberate/accidental interception of communications constitutes eavesdropping. "eavesdropping" means radio communication is received by another receiver deliberately or accidentally.

Electromagnetic Waves

- **For body worn operation, this mobile phone has been tested and meets RF exposure guidelines when used with an accessory containing no metal and positioning the handset a minimum 15 mm from the body. Use of other accessories may not ensure compliance with RF exposure guidelines.**

For more information, see "Handling Precautions" in User Guide (Japanese).

Before Using Handset

Package Contents

- Handset (921P)
- Battery (PMBAK1)
- User Guide (Japanese)
- First Step Guide
- Raku Raku Start Book (Japanese)
- Utility Software* (CD-ROM)

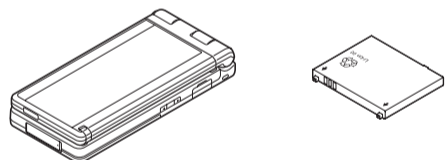

*Utility Software updates/upgrades may be released on SOFTBANK MOBILE Corp. Website (<http://www.softbank.jp>) without prior notification. Please check for the newest versions of utility applications and download as required.

Horizontal Open Position

Watch TV programs or use PC Site Browser in Horizontal Open Position (landscape view).

- 1 Slide and hold Horizontal Open Lever
- 2 Flip open (as indicated by arrow)
Hinge should be intact (A). If hinge is detached, close handset and try again.

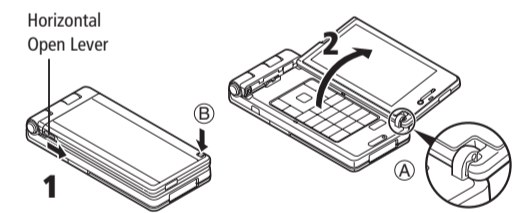

Do not lift hinge portion (B) when opening handset.

USIM Card Installation

With IC chip down, slide in USIM Card

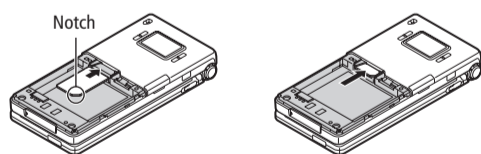

USIM Card must be inserted to use this handset. Turn handset off and remove battery before inserting/removing USIM Card.

Battery Installation

- 1 Press and slide to remove cover
- 2 Insert battery
- 3 Replace cover

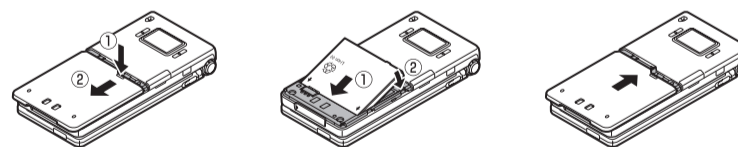

USIM PINs

- **PIN**
4 to 8-digit code used to prevent unauthorized 921P use.
• PIN can be changed.
• When PIN Entry is ON, PIN entry is required each time handset is turned on (with USIM Card inserted).
- **PIN2**
Required to clear call times/costs or set maximum cost.
• PIN2 can be changed.
- **PIN Lock & Cancellation (PUK)**
PIN Lock or PIN2 Lock is activated if PIN or PIN2 is incorrectly entered three times. Cancel PIN Lock or PIN2 Lock by entering the PIN Unlocking Key (PUK/PUK2).
• If PUK is incorrectly entered ten times, USIM Card is locked and handset is disabled. Write down PUK.
• For procedures required to unlock USIM Card, contact SoftBank Customer Center, General Information.

Charging

Use specified AC Charger (sold separately).

- 1 Connect AC Charger to handset
- 2 Plug AC Charger into AC Outlet
• Charging Indicator illuminates and charging starts; may take up to approximately 130 minutes.
• When charging is complete, Charging Indicator goes out.
- 3 Unplug AC Charger, then disconnect handset

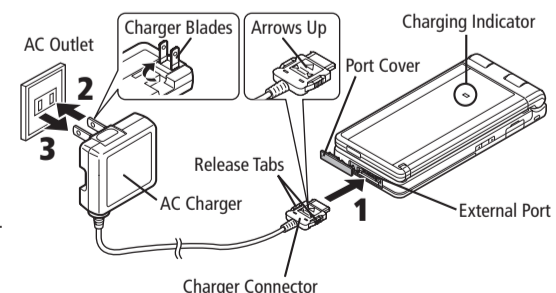

Passwords

- **Phone Password**
Required to use/change some handset functions.
• _ appears for each digit entered.
• Phone Password (9999 by default) can be changed on handset.
- **Center Access Code**
4-digit number specified at initial subscription; required to access Voice Mail via landlines or subscribe to fee-based information.
- **Security Code**
4-digit number specified at initial subscription, required to restrict handset services.
• If entered incorrectly three times, Call Barring settings lock; Security Code & Center Access Code must be changed. Reach SoftBank Customer Center, General Information for details.

Specifications

Weight (including battery)	124 g*
Dimensions (closed)	50 x 108 x 17.5 mm*
Standby Time (closed)	3G: 650 hours* GSM: 410 hours*
Talk Time	3G: 220 minutes* Video Call: 110 minutes* GSM: 200 minutes*

TV Reception Time	Normal Mode: 3.4 hours* (When Mobile W-Speed is ON) ECO Mode: 6 hours*
Charging Time	AC Charger: 130 minutes* In-Car Charger: 130 minutes*
Maximum Output	3G: 0.25 W GSM: 2.0 W

* Approximate value
• Values were calculated with battery installed.

Getting Started

Display Indicators & Key Assignments

Signal Strength
Packet Transmission Available*
Unread Message
microSD Card Inserted
Manner Mode
Battery Level
Voice Mail
Alarm Set

* Both indicators appear while abroad.

Open Messaging menu or execute Upper Left Softkey functions
Activate TV or execute Lower Left Softkey functions
Initiate/answer call; press and hold to activate Voice Dial
Enter numbers/characters
Access pictograms in text entry windows; press and hold to toggle Driving mode

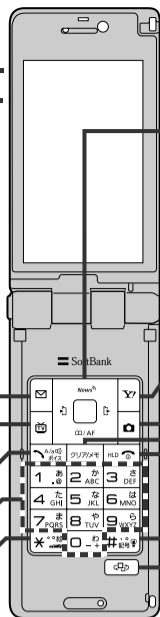

Multi Selector: Select items, navigate menus, etc.

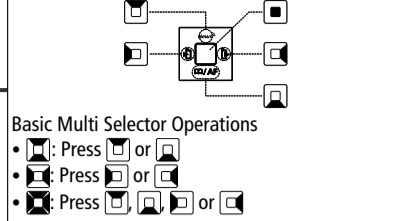

Open Yahoo! Keitai Main Menu or execute Upper Right Softkey functions
Activate Camera in Standby or execute Lower Right Softkey functions
Delete characters or highlighted items
Return to Standby; press and hold to turn handset power on/off
Press and hold in Standby to toggle Manner Mode
Activate PC Site Browser or press and hold to activate Music Player in Standby; toggle PC Site Browser and TV

Function List

Messaging
Incoming Mail
Create New
Retrieve New
Drafts
Templates
Sent/Unsent Messages
Server Mail
Create New SMS
Settings
Memory Status
Yahoo! Keitai
Yahoo! Keitai
Bookmarks
Saved Pages
Enter URL
History
PC Site Browser
Set Yahoo! Keitai
Reset
S! Appli
S! Appli Library
OsaiFu-Keitai
S! Appli Settings
S! Appli History
Information

Communication
S! Town
S! Loop
Camera
Camera
Video Camera
Pictures
Videos
Entertainment
S! Quick News
BookSurfing
e-Book Viewer
Tools
Alarms
Calendar
Calculator
Notepad
Tasks
OsaiFu-Keitai
Sound Recorders
Bar Code Reader
S! GPS Navi
Bluetooth
Receive via Infrared
microSD Backup
Templates/Users Dic.

Data Folder
Pictures
Ring Songs&Tones
S! Appli
Music
Videos
PC Movies
TV
Lifestyle-Appli
Books
Customized Screen
Templates
Other Documents
Music Player
Player
Data Manager
TV
Watch TV
Program List
Timer Watching
Timer Recording
Recording Result
TV Link
Channel List
Channel Setting
User Settings

Phone Book
Phone Book
Create New Entry
Call Log
Group
Account Details
S! Addressbook BkUp
Memory Manager
Restrictions
Settings
Memory Status
Settings
Sound Settings
Display Settings
Customized Screen
Incoming Settings
Phone Settings
Date & Time
Security
Call Settings
Video Call
International Call
Connectivity
Notification Light

Handset Functions

Most operation descriptions below begin in Standby.

Basic Operations

Handset Power On/Off

- **Power On**
Open handset → Press and hold [HLD] [Power]
- **Power Off**
Open handset → Press [HLD] [Power] for 2+ seconds

Retrieving Network Information

- When [Signal], [Packet], [Unread], or [MicroSD] is pressed for the first time, 921P initiates Network Information retrieval; [Enter] to retrieve it.
- To update manually, [Enter] → **Settings** → [Enter] → **Connectivity** → [Enter] → **Retrieve NW Info** → [Enter] → **YES** → [Enter]

English Interface

- [Enter] → **設定** → [Enter] → **ディスプレイ設定** → [Enter] → **Language** → [Enter] → **English** → [Enter]

My Number

- [Enter] → [0-9]

Date & Time

- [Enter] → **Settings** → [Enter] → **Date & Time** → [Enter] → **Date & Time** → [Enter] → Enter year → [Enter] → Enter date → [Enter] → Enter time → [Enter] → time zone → [Enter] → [Enter] to select a time zone → [Enter] → [Enter]

Manner Mode

Please use your handset responsibly. Inappropriate handset use can be both dangerous and bothersome.

In Standby, press and hold [HLD] [Manner].

Calls

Making Voice Calls

- Enter number with area code → [Area Code] [Number]
• [HLD] [Power] to end call

Calling from Redial Log

- [Call] → An entry → [Area Code] [Number]
• [HLD] [Power] to end call

Making Video Calls

- Enter number with area code → [Area Code] [Number]
• [HLD] [Power] to end call

Calling Abroad from Japan

- International Call Service may require application. Details and applications are available online: http://mb.softbank.jp/mb/en/global_service/
Enter number → [Area Code] → **Int'l dial assist** → [Enter] → A country/region → [Enter] → [Area Code] [Number]
• [HLD] [Power] to end call
• 921P is Global Roaming Service eligible. For links to information, see Support section in this Guide.

Answering a Call

- [Answer] [Power] to end call

Answer Phone

Record messages on handset when unable to answer incoming calls.

- **Activating**
Press and hold [Answer]
- To cancel: Press and hold [Answer] again.

- **Playing Messages**
In Standby, [Answer] to select indicator → [Enter] → A message → [Enter]

- **Deleting Messages**
[Enter] → **Tools** → [Enter] → **Sound Recorders** → [Enter] → **Voice Call Data** or **Video Call Data** → [Enter] → A message → [Enter] → **Erase this** → [Enter] → **YES** → [Enter]

Answer Phone is unavailable when handset is off, out-of-range or Offline.

Text Entry

Toggling Entry Modes

In text entry window, [Enter] to toggle input modes (or press [1] → **1byte/2bytes (1 byte character or 2 byte character)** to toggle single/double-byte) → Enter text

Character Input Mode	
漢	Kanji/Hiragana input mode
カ	Katakana input mode
abc	Alphanumerics input mode
123	Number input mode

Example: Entering "no"

- In text entry window, [Enter] → abc1/2 → [Enter] → [1] → [2] → [Enter] → [0] → [Enter] → [6] → [Enter] → [MNO] → [Enter] → [6] → [Enter] → [MNO] → [Enter] → [6] → [Enter] → [MNO] → [Enter]

Messaging

S! Mail/SMS

- **S! Mail**
Exchange text messages with e-mail compatible handsets, PCs, etc.; attach image/sound files etc.
- **SMS**
Exchange short text messages with SoftBank handsets.

Customizing Handset Address

- Change your handset mail address (alphanumerics before @) to reduce the risk of receiving spam.
[Enter] → **Settings** → [Enter] → **Custom Mail Address** → [Enter] → Follow onscreen instructions

Sending S! Mail & SMS

- [Enter] → **Create New (Create New SMS for SMS)** → [Enter] → Address field → [Enter] → **Phone Book** → [Enter] → An entry → [Enter] → A number/mail address → [Enter] → Subject field → [Enter] → Enter subject → [Enter] → Attachment field → [Enter] → A folder → [Enter] → A file → [Enter] → Text field → [Enter] → Enter text → [Enter] → [Enter]
• Subject and attachment fields are not available for SMS.

Receiving S! Mail & SMS

- In Standby, [Enter] to select indicator → [Enter] → A folder → [Enter] → An unread message → [Enter]

Phone Book

Phone Book Entry Items

- **Phone Number**
Save up to four entries in Phone Book; two in USIM Card Phone Book.
- **E-mail Address**
Save up to three entries in Phone Book; one in USIM Card Phone Book.

Saving to Phone Book

- Press and hold [Call] → Enter name → [Enter] → An item → [Enter] → Enter information → [Enter] → [Enter]

Save Settings

- Select Phone Book memory for new entries.
[Enter] → **Phone Book** → [Enter] → **Settings** → [Enter] → **Save Settings** → [Enter] → **Phone, USIM** or **Ask Every Time** → [Enter]

- Select **Ask Every Time** to select target each time you save an entry.

Editing Phone Book Entries

- [Call] → An entry → [Enter] → [Call] → An item → [Enter] → Edit → [Enter] → [Enter] → (**YES**)* → [Enter]

* Handset Phone Book only

Making Calls from Phone Book

- [Call] → [Call] to select a page of the required reading → An entry → [Enter] → [Call] → A phone number → [Enter]

Voice Mail

Activating Voice Mail

- [Enter] → **Settings** → [Enter] → **Call Settings** → [Enter] → **Voice Mail/Call Fwding** → [Enter] → **Voice Mail ON** → [Enter] → **Ringer ON** or **Ringer OFF** → [Enter] → Ring time (for **Ringer ON**) → [Enter] → **YES** → [Enter] → [Enter]

Checking Voice Mail Messages

- In Standby, [Enter] to select indicator → [Enter] → **YES** → [Enter] → Follow voice guidance
• To switch to English voice guidance, press [1] [2] while Japanese voice guidance is playing.

Camera

Capturing Still Images

- [Camera] → Frame subject → [Enter] → [Enter] → Select a folder to save → [Enter] → [Enter]

Recording Videos

- Press and hold [Camera] → Frame subject → [Enter] → [Enter] → [Enter] → Select a folder to save → [Enter] → [Enter]

Yahoo! Keitai

Yahoo! Keitai Main Menu

- [Enter] → **メニューリスト** → [Enter] → **English** → [Enter] → A menu item → [Enter]

PC Site Browser

- [Enter] → **Yahoo! Keitai** → [Enter] → **PC Site Browser** → [Enter] → **Homepage** → [Enter] → [Enter] → [Enter] → A menu item → [Enter]

Music Player

Playing Music

- [Enter] → **Music Player** → [Enter] → **Player** → [Enter] → An item → [Enter] → A file → [Enter]
• To stop playback: [Enter]

Digital TV

Initial Setup

- [Enter] → **TV** → [Enter] → **Channel Setting** → [Enter] → **OK** → [Enter] → **YES** → [Enter] → **Select Area** → [Enter] → A region → [Enter] → A prefecture → [Enter] → **YES** → [Enter]

Watching TV

- [TV]* → **OK** → [Enter] → **YES** → [Enter] → [Enter] -

[Enter] [Enter] [Enter] or [Enter] to select a channel

* To activate TV in landscape view, open handset to Horizontal Open Position (Front page).

- [Enter] to adjust volume
- To exit: [HLD] [Power] → **YES** → [Enter]

Managing Files

Opening Files

- [Enter] → **Data Folder** → [Enter] → A folder → [Enter] → A file → [Enter]

Formatting microSD Card

- [Enter] → **Tools** → [Enter] → **microSD Backup** → [Enter] → [Enter] → **microSD format** → [Enter] → Enter Phone Password (4 to 8 digits) → [Enter] → **YES** → [Enter]

Software Update

Precaution

Fully charge battery beforehand.

Updating Software

- [Enter] → **Settings** → [Enter] → **Phone Settings** → [Enter] → **Software Update** → [Enter] → **Software Update** → [Enter] → [Enter] → Follow onscreen instructions