

USIM Card	1-2
About USIM Card	1-2
USIM Card Installation	1-3
USIM PINs	1-3
Parts & Functions	1-4
Handset	1-4
Key Operations in Standby	1-6
Display	1-8
About Battery	1-10
Before Charging	1-10
Battery Installation	1-12
Charging Battery	1-13
Handset Power On/Off	1-14
Manner Mode	1-15
Minding Mobile Manners.....	1-15
Manner-related Features.....	1-15
Activating Manner Mode	1-15
Activating Emission OFF Mode.....	1-16
Activating Drive Mode	1-16
Handset Menus	1-16
Main Menu	1-16
Menu Numbers	1-17
Using Keys	1-18

Standby Options	1-18
Information Window.....	1-18
Standby Window	1-19
Private Menu	1-20
Opening Private Menu	1-20
Customizing Private Menu	1-21
Simple Mode	1-21
Activating Simple Mode.....	1-22
Simple Mode	1-22
Passwords	1-23
Phone Password.....	1-23
Center Access Code.....	1-23
Call Barring Password.....	1-23
View Blind	1-24
My Number	1-24

USIM Card

About USIM Card

Universal Subscriber Identity Module (USIM) Card is an IC card containing customer and authentication information, including handset number, and limited Phone Book entry and SMS message storage. USIM must be inserted to use handset or Network services (calling, messaging, Internet, etc.).

Turn handset off before inserting/removing USIM Card.

USIM Card

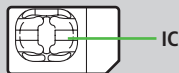

- Insert USIM Card into other compatible SoftBank handset to use information saved on USIM Card.
- Use SoftBank specified USIM Card only; non-specified USIM Cards may not function properly.
- Do not insert USIM Card into other IC card devices. SoftBank is not liable for any resulting damages.
- Keep IC portion clean.
- Do not damage, carelessly touch or short-circuit IC chip; doing so may result in loss of data or malfunction.
- Remove dust/debris with a soft, dry cloth.
- Do not place labels, etc. on USIM Card; may cause failure.
- If handset is dropped/subjected to shock, handset may return to Standby. This is not a malfunction. If **Insert USIM** appears, re-insert USIM Card properly then restart handset.

Important

- USIM Card is the property of SoftBank.
- Return USIM Card to SoftBank upon service cancellation.
- USIM Card will be reissued for a fee if lost or damaged.
- If USIM Card/handset with USIM Card inserted is lost or stolen, contact SoftBank Mobile Customer Center or Global Call Center (☎ P.16-30).
- Back up USIM Card files. SoftBank is not liable for lost files.
- USIM Card specifications/performance may change without prior notice.
- Pre-installed S! Appli may be unusable while a different or replacement USIM Card is inserted into handset.
- Returned USIM Cards are recycled.

Note

- Some downloaded files may be inaccessible after upgrades/repairs, USIM Card/handset replacement.

USIM Card Installation

- Remove battery (☞ P.1-12) then follow steps below.

Inserting

- 1 With IC chip down, insert USIM Card

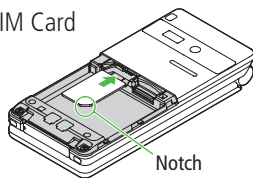

Removing

- 1 Slide out USIM Card gently

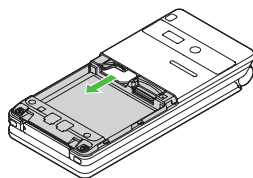

Note

- Do not force USIM Card into or out of handset; may damage handset/USIM Card.
- Be careful not to lose the removed USIM Card.
- Avoid touching USIM Card terminals or IC chip; doing so may hinder performance/USIM Card recognition.

USIM PINs

There are two USIM Card security codes: PIN & PIN2

- PIN and PIN2 are set to 9999 by default.
- PIN/PIN2 can be changed (☞ P.10-3).

PIN	4 to 8-digit code used to prevent unauthorized handset use. <ul style="list-style-type: none"> ● When PIN Certification is ON (☞ P.10-2), PIN entry is required each time handset is turned on (with USIM Card inserted).
PIN2	Required to clear call costs or set maximum cost (☞ P.15-10).

PIN Lock & Cancellation (PUK/PUK2)

PIN Lock or PIN2 Lock is activated if PIN or PIN2 is incorrectly entered three times. Cancel PIN Lock or PIN2 Lock by entering the PIN Unblocking Key (PUK/PUK2) (☞ P.10-3).

- For information on PUK/PUK2, contact SoftBank Mobile Customer Center, General Information (☞ P.16-30).

Note

- If PUK/PUK2 is incorrectly entered ten times, USIM Card is locked and handset is disabled. Write down PUK/PUK2.
- For procedures required to unlock USIM Card, contact SoftBank Mobile Customer Center, General Information (☞ P.16-30).

Parts & Functions

Handset

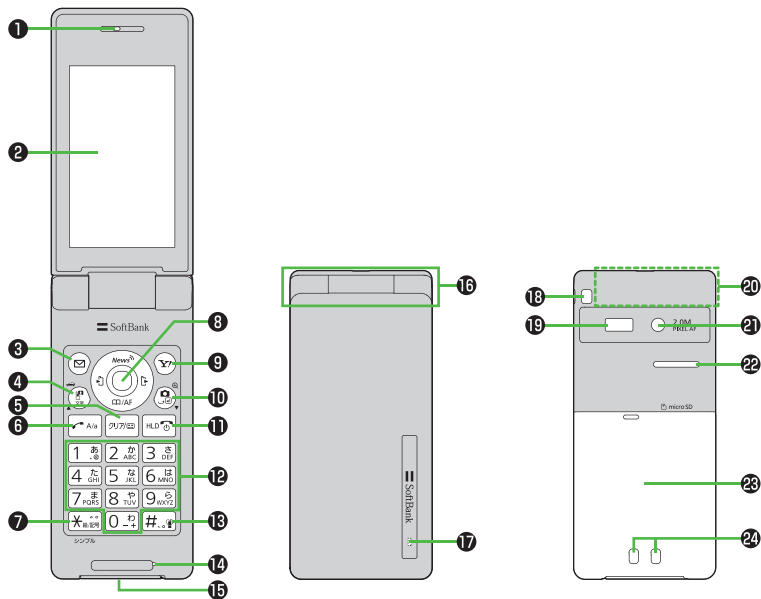

Using Microphone/Earphone

Connect Earphone Conversion Cable (sold separately) to External Port to use Microphone/ Earphone. Stereo Earphone Conversion Cable (PMLAJ1) is also compatible with 840P.

- Do not press answer button on microphone/ earphone when connecting. Doing so may cause microphone/earphone to malfunction. In that case, pull out earphone/microphone, and connect again.

1 Earpiece**2 Display****3  Mail Key**

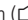
- Open Messaging menu
- Execute Left Softkey function ( P.ix)

4  Video Call/Input Mode/Drive Mode Key

- Initiate Video Call
- Toggle input mode in text entry windows
- Toggle Drive Mode

5  Clear/Memo Key

- Delete characters
- Cancel menus
- Open Answer Phone message list; Toggle Answer Phone on/off





6  Send Key

- Initiate or answer calls
- Toggle upper/lower case in text entry windows

7  * /Pictograph/Symbol/Simple Mode Key

- Enter "*"
- Access pictographs in text entry windows
- Access symbol list from pictograph list
- Toggle Simple Mode

8  Multi Selector

- Scroll up/down/left/right to navigate menus and text ( P.ix)
-  Open/Select Standby Window (Unavailable in Simple Mode)
-  Open Phone Book; set Auto Focus Lock
-  Open Incoming Call Logs
-  Open Outgoing Call Logs

9  Yahoo! Keitai Key

- Open Yahoo! Keitai Main Menu
- Execute Right Softkey function ( P.ix)

10  Camera/Line Break Key

- Activate Camera; activate Magnifying Loupe
- Enter a line break
- Toggle letters in reverse order in a text entry window

11  End/Escape & Power Key

- Power on/off ( P.1-14)
- End calls
- Return to Standby
- Place Call on hold

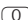
12  0 - 9 Keypad

- Enter phone number/text

13  #/Manner Mode Key

- Enter "#"
- Toggle Manner Mode

14 Microphone**15 External Port**

- Connect AC Charger (sold separately) or other accessories here

16 Hinge**17 Notification Light/Charging Indicator**

- Flashes for incoming transmissions; flashes while Camera is active
- Lights in red for charging











18 Strap Eyelet**19 Infrared Port**



- Transfer data via Infrared

20 Antenna**21 Camera****22 Speaker****23 Battery Cover****24 Charging Terminals**

Key Operations in Standby

Press or press and hold (more than one second) a key in Standby to execute the following.

Key Operations		Functions
	Short Press	Initiate a call
	Long Press	
	Short Press ¹	Show/hide Standby Window
	Long Press (2+ sec)	Turn off power
	Short Press	Open Main Menu
	Long Press	Activate/cancel Keyguard
	Short Press	Open Answer Phone message list
	Long Press	Activate/cancel Answer Phone
	Short Press	Open Messaging Menu
	Long Press	Open S! Mail Composition window
	Short Press	Access Yahoo! Keitai
	Long Press	Open Yahoo! Keitai Menu
	Short Press ²	Open Calendar
	Long Press ²	Activate/cancel Drive Mode
	Short Press ²	Activate Camera
	Long Press ²	Activate Magnifying Loupe
	Short Press ¹	Show/select Standby Window
	Long Press ²	Open Private Menu
	Short Press	Open Phone Book
	Long Press ²	Open Phone Book entry window

Key Operations	Functions	
	Short Press	Open Incoming Call Logs
	Long Press ²	Open the newest unread message ● Open Incoming Mail folder for read messages
	Short Press	Open Outgoing Call Logs
	Long Press ²	Open Sent Messages folder
①	Short Press	Enter "1"
	Long Press	Open Phone Book page "あ"; dial the number set to Speed Dial
②	Short Press	Enter "2"
	Long Press ³	Open Phone Book page "か"; dial the number set to Speed Dial
③	Short Press	Enter "3"
	Long Press ³	Open Phone Book page "さ"; dial the number set to Speed Dial
④	Short Press	Enter "4"
	Long Press ³	Open Phone Book page "た"; dial the number set to Speed Dial
⑤	Short Press	Enter "5"
	Long Press ³	Open Phone Book page "な"; dial the number set to Speed Dial
⑥	Short Press	Enter "6"
	Long Press ³	Open Phone Book page "は"; dial the number set to Speed Dial
⑦	Short Press	Enter "7"
	Long Press ³	Open Phone Book page "ま"; dial the number set to Speed Dial

Key Operations		Functions
8	Short Press	Enter "8"
	Long Press ³	Open Phone Book page "や"; dial the number set to Speed Dial
9	Short Press	Enter "9"
	Long Press ³	Open Phone Book page "ら"; dial the number set to Speed Dial
0	Short Press	Enter "0"
	Long Press ³	Open Phone Book page "わ"
*	Short Press	Enter "✖"
	Long Press	Activate/cancel Simple Mode
#	Short Press	Enter "#"
	Long Press	Activate/cancel Manner Mode

- ¹ **Standby Window** setting (☞ P.15-4) applies; unavailable in Simple Mode.
- ² Change the assigned function as required (Key Settings: ☞ P.15-6). While Simple Mode is active, settings may return to defaults.
- ³ **One Touch Key setting** (☞ P.4-8) applies.

Display

Display Indicators

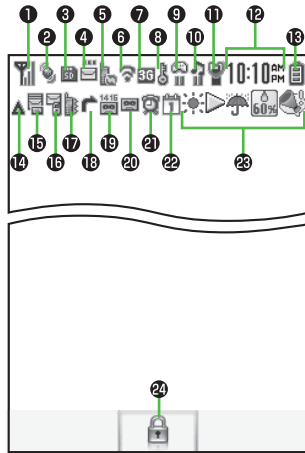

1 Signal Strength

Strong Moderate Weak Low

Out-of-Range

Emission OFF Mode

(Red) Only Packet Transmission Available

2 New S! Quick News Information

Location Access

3 Memory Card

Inserted Unusable

Unsupported Write-protected

Call

Video Call

Voice Call

4 Secret Mode Active

Secret Data Only Active

5 Unread Message

Software Update

(Notification/Updating/Result)

New S! Information Channel Info

6 PC Site Browser Active

Infrared Active

USB Cable Connected

7 Network Service

3G Packet Transmission Available

GSM Packet Transmission Available

Data Transmission

Packet Transmission in Progress (PC)

Dial-up Connection Established on PC

3G/GSM Packet Transmission Enabled

3G/GSM Packet Transmitting

8 Secure Content

S! Addressbook Back-up Synchronizing

Auto Sync Settings Active

9 S! Appli Active S! Appli Paused

10 Music/Video Playback

BGM Playback BGM Paused

Streaming Streaming Paused

11 Manner Mode Active

Original Manner Mode Active

Drive Mode Active

12 Time

13 Battery Level

 →  →  →  (Red)

14  Roaming

15  Unread Message on Server

16  Messaging Lock Active

 Phone Book Lock Active

 Messaging & Phone Book Lock Active

17  Mute Active

 Vibration Active

 Mute & Vibration Active

18  Call Forwarding or Voice Mail Active

19  Voice Message

20  Answer Phone Active

 Answer Phone Full

 New Message Recorded

 New Message Recorded & Answer Phone Full

21  Alarm Set

22 Schedule Set ( P.11-3)

23 Weather Indicator ( P.6-3)

24 Multi Selector

 Keyguard Locked

 Password Lock Active

 Keyguard & Password Lock Active

About Battery

Before Charging

Charge battery before use or after a period of disuse (AC Charger sold separately).

Charging Time & Operating Time Estimates

		3G	GSM
Charging Time		150 minutes*	
Standby Time		460 hours*	360 hours*
Talk Time	Voice Call	230 minutes*	250 minutes*
	Video Call	110 minutes*	—

* Approximate value

- 3G Mode/GSM Mode: ➔ P.2-9
- Charging time is an average measured within temperatures of 5°C to 35 °C.
- Talk Time is an average measured with a new, fully charged battery, with stable signals.
- Standby Time is an average measured with a new, fully charged battery, with handset closed without calls or operations, in Standby with stable signals.
- Talk Time and Standby Time may vary by environment (battery status, temperature, etc.).

About Battery

- Clean handset, battery & charger with dry cotton swab.
- Replace battery if operating time shortens noticeably.
- Charge battery at least once every six months.
- Use a case when carrying battery separately.

Charging

- Battery must be installed to charge it.
- It may take longer for charging when handset is on.
- Move charger away from TV/radio if interference occurs.

Battery Time



- Using handset in poor conditions may shorten battery time.
 - Extreme temperatures
 - Impaired handset, battery or Charging Terminals
 - Signal is weak/handset is out-of-range
 - Handset is left mid-operation (not in Standby)
 - Playing music or using S! Appli, etc.
- Extending battery time

Example:

 - Select shorter Display backlight time; select **OFF** or shorter time for Keypad Backlight (☞ P.15-6).
 - Select **Silent** for Key Tone Volume (☞ P.15-3)

When Battery Runs Out

- **Unless a Call is in Progress**

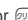
A message appears and warning tone sounds. Handset power turns off automatically after two minutes; press ,  or  to cancel warning tone manually. Charge or replace battery.

 - If Manner Mode is active/Warning Tone **Off**, nothing sounds.
- **During a Call**

A message appears and warning tone sounds via Earpiece or Speaker. After 90 seconds, call ends and handset shuts down in 30 seconds. Charge or replace battery.

Battery Strength Indicator

- Battery Strength indicator changes as remaining usage time decreases. Charge or replace battery when battery level is low (☞ P.1-9) or a message appears on Display.

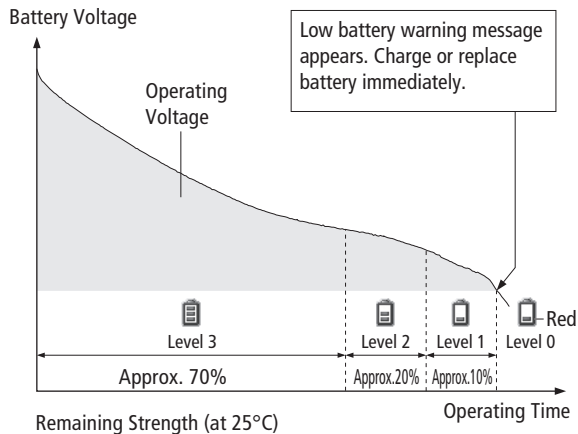

Battery Installation

- Always turn off handset power before removing battery.

1 Press and slide to remove cover

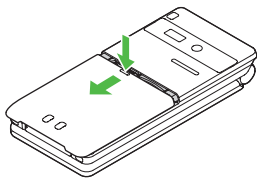

2 Insert Battery

Align battery contacts with handset pins.

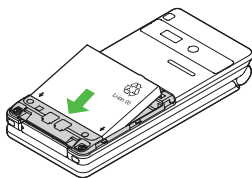

Remove Battery

Lift battery out as shown.

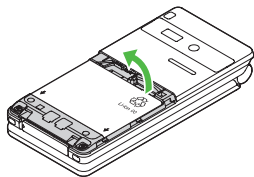

3 Replace battery cover

Cover should click into place.

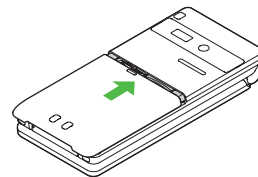

Note

- When battery is removed just after changing handset settings, changes may not take effect.
- Lithium-ion batteries are valuable and recyclable resources. **Li-ion 00**
 - Recycle used lithium-ion battery at a shop displaying the symbol shown to the right.
 - To avoid fire or electric shock, do not:
 - Short-circuit battery
 - Disassemble battery



Charging Battery

Use only specified AC Charger (sold separately).

Charging Time: Approximately 150 minutes

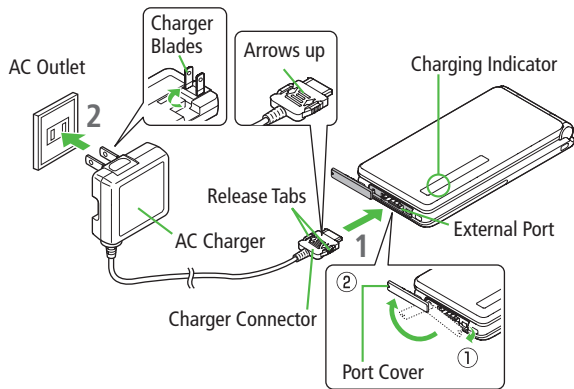

1 Connect AC Charger to handset

Insert Charger Connector (printed side up) into External Port.

2 Plug AC Charger into AC Outlet

Extend Charger Blades.

Charging Indicator illuminates and charging starts.

When charging is complete, Charging Indicator goes out.

3 When charging is complete, unplug AC Charger, then disconnect handset

Squeeze Release Tabs to remove Charger Connector, and replace Port Cover.

Note

- For details, read AC Charger instructions.
- Alternatively, charge battery by using Desktop Holder (not included).

Handset Power On/Off

1 Press for 3+ seconds

Start-up window appears and handset enters Standby.

- Enter PIN if PIN Certification is ON (☞ P.10-2).

2 Press for 2+ seconds

Handset shuts down.

- Do not turn on handset immediately after turning off. Wait a few seconds.



Standby

The First Time Handset Powers Up...

Setup window appears.

Enter date → Enter time (24 hours)

Day of the week is set automatically.

- If unentered, **2000/01/01 00:00** is set.
- To change date and time: ☞ P.15-8

View Information Messages





At time of purchase, information messages are provided for your convenience.

>  → **Incoming Mail** → **Received** → Select a message

Note

- Standby Display takes a few moments to appear.
- If **Insert USIM** appears, clean and properly re-insert USIM Card then restart handset.
- After a period of inactivity, Display turns off.

Retrieving Network Information

When ,  or  is pressed for the first time in Standby, handset initiates Network Information retrieval; Press  to retrieve it.

- Update Network Information to use messaging, Internet, etc.
- Update Network Information manually: **Main Menu** ► **Settings**
► **Retrieve NW Info** ► 

Tip

- Change Wallpaper ● Change Clock/Calendar Style (☞ P.15-4)

Manner Mode

Minding Mobile Manners

Please use your handset responsibly. Use these basic tips as a guide. Inappropriate handset use can be both dangerous and bothersome. Please take care not to disturb others when using your handset. Adjust handset use according to your surroundings.

- Turn it off in theaters, museums and other places where silence is the norm.
- Refrain from use in restaurants, lobbies, elevators, etc.
- Observe signs and instructions regarding handset use aboard trains, etc.
- Refrain from use that interrupts the flow of pedestrian or vehicle traffic.

Manner-related Features

Manner Mode (☞ Right)	Press Manner key to mute handset tones and activate vibration for incoming transmissions.
Vibration Mode (☞ P.15-2)	Activate in public places, meetings, etc. for silent call/message alerts.
Ringer Volume (☞ P.15-2)	Mute call/message tones.
Emission OFF Mode (☞ P.1-16)	Suspend all handset transmissions.
Answer Phone (☞ P.2-12)	Use to handle incoming calls when inappropriate/unsafe to answer.
Drive Mode (☞ P.1-16)	While driving, send a voice message informing the caller that you cannot answer the call. (Handset does not ring.)

Activating Manner Mode

Press one key to mute handset tones and vibration for incoming transmissions.

- Manner Mode settings can be changed (☞ P.15-7).
- When Manner Mode is active,  appears.

1 In Standby, press and hold 

- To cancel: Press and hold  again

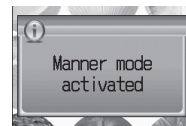

Note

- Shutter click, Auto Answer tone, and incoming tone via Earphone (**Volume 1**) sound even in Manner Mode.
- Media Player files are initially muted in Manner Mode; adjust volume in Playback window.
- When Alarm Priority is set to **Alarm prioritized** (☞ P.11-6), Alarm sounds even if Manner Mode is active.

Tip

- **Settings** ● Set Manner Mode Type (☞ P.15-7)

Activating Emission OFF Mode

Temporarily suspend all handset transmissions; when active, all calls/messages and incoming information are blocked.

- When Emission OFF Mode is active,  appears.

Main Menu ► Settings ► Call Settings
► Emission OFF Mode

1 ON or OFF

Note

- Emission OFF Mode disables Infrared transmissions.
- Emergency numbers (110, 119, 118) cannot be dialed.

Activating Drive Mode

Handset does not ring for incoming transmission. Voice guidance informs the caller you are unavailable and handset records messages.

- When Drive Mode is active,  appears.

1 In Standby, press and hold

- To cancel: Press and hold  again

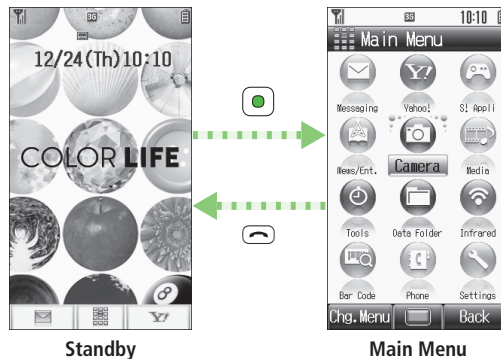

Handset Menus

Main Menu



1 In Standby,

Main Menu appears.













- To change Main Menu Theme:  [Chg.Menu] → Select a Theme → 

2 to highlight an icon →

Selected function menu appears.

- To return to Standby: 

Main Menu Icons

<p>Messaging</p>  <p>Create new/view received messages</p>	<p>Yahoo! (Yahoo! Keitai)</p>  <p>Enjoy Mobile Net & PC Site browsing...</p>	<p>S! Appli</p>  <p>Download, set and use S! Appli</p>
<p>News/Ent. (News/Entertainment)</p>  <p>Use S! Quick News & e-Books</p>	<p>Camera</p>  <p>Capture images or record videos</p>	<p>Media (Media Player)</p>  <p>Use Media Player</p>
<p>Tools</p>  <p>Set Alarm or save Calendar entries...</p>	<p>Data Folder</p>  <p>Open files saved on handset/Memory Card</p>	<p>Infrared</p>  <p>Use Infrared</p>
<p>Bar Code (Bar Code Reader)</p>  <p>Scan barcodes and QR Codes to retrieve information</p>	<p>Phone</p>  <p>Access Phone Book, save contact information...</p>	<p>Settings</p>  <p>Adjust/customize handset settings</p>

Tip

Settings

- Change Display Color Theme (👉 P.15-4)
- Change Main Menu Background ● Change Main Menu Icons (👉 P.15-5)

Menu Numbers

Use keypad to select functions or menu items.

Unnumbered Menu Items

When numbers do not appear, select items as shown.

Example: Press **#** to select **Settings** from Main Menu



Main Menu Item Key Assignments

- Press **0** to open Account Details. To open Phone Book top menu, select **Phone** by pressing **☒**.

Numbered Menu Items

Press key corresponding to menu number to select a menu.

Example: In Display Settings (from *Settings* Top Menu), press **7** to select *Themes*

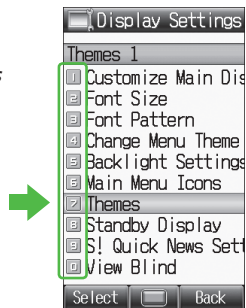

Using Keys

Press a key corresponding to a menu to open in Standby (☞ P.1-6).

- Change or deactivate the functions assigned to **7**, **8**, and **9** (☞ P.15-6). While Simple Mode is active, settings may return to defaults.

Standby Options

Information Window

In Standby, Information window opens for missed calls, messages, etc.

1  to select an item

- To close Information window: , **[Exit]** or **[7/716]**

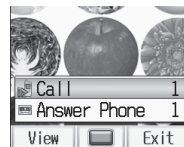

Events

Call	Missed calls (☞ P.2-10)
Message	New messages (☞ P.12-12) When Feeling Mail is received, a pictograph that shows emotion set by sender, and sender name, mail address or phone number appear
Answer Phone	Recorded caller messages (☞ P.2-13)
Voice Mail	New Voice Mail messages (☞ P.2-16)
Missed Call	If Missed Call Notification is active, Information window opens for calls missed while handset is off, out-of-range, engaged, etc. (☞ P.2-16)
Update Results	Received software update results (☞ P.16-10)
New S! Information Channel	Received S! Information Channel updates (☞ P.6-2)
S! Information Channel	Failed to receive S! Information Channel updates (☞ P.6-2)
New Weather	Received weather forecast updates (☞ P.6-3)
Weather	Failed to receive weather forecast updates (☞ P.6-4)

Standby Window

Access S! Quick News or Shortcuts from Standby Window.

- S! Quick News: P.6-5



S! Quick News

Show/Hide Standby Window

From Standby, press to show Standby Window; press to show/hide Standby Window. Press to deselect a shortcut icon or ticker.

- Set Standby Window On/Off: P.15-4

Changing Templates

<Default> Shortcuts & S! Quick News

Set to appear both or either S! Quick News/Shortcuts.

- 1 In Standby, → [Menu] → **Change Templates**
→ Select an item

Changing Transparency Level of Standby Window

<Default> Light

- 1 In Standby, → [Menu] →
Background of Panel → Select a level

Adding Content & Changing Settings

Add or Set S! Quick News in Standby Window.

- 1 In Standby, → highlight ticker → [Menu]

- 2 **Add Content**
Add S! Quick News

Handset connects to the Network.

Follow onscreen instructions.

Settings

S! Quick News Settings → **Auto Refresh** or
Display Setting

Go to P.15-17 and follow steps.

Accessing Functions from Shortcuts

- 1 In Standby, → Select an icon
The selected function name appears at top of panel.

- To deselect:

- 2 to access function



Adding Shortcuts

Add frequently used functions to Shortcuts.

- Following shortcuts are set by default:
 - メニューリスト (Menu List)*
 - 各種手続き・料金 (Manage Account/Fees)*
 - 待ちうた (Machi-Uta®)*
 - One Touch Guide
 - Pictures (Data Folder)
 - Alarms
 - Calculator
 - Calendar
 - Web Search

* Requires network connection. Available in Japanese only.

1 In Standby,  → highlight target →  [Menu] → **Set Shortcut**

2 Select an item → Highlight a function, bookmark or Phone Book entry →  [Entry]

Move Icons

> In Step 1, highlight an icon →  [Menu] → **Move Shortcut** → Select a position

Delete Icons

> In Step 1, highlight an icon →  [Menu] → **Remove Shortcut** → 

Private Menu

Save frequently used functions in Private Menu.

- Up to 12 items can be saved.
- Change preset functions as needed.

Opening Private Menu

1 In Standby, press and hold 

Private Menu appears.

- To return to Standby:  [Back]

2 Select a menu

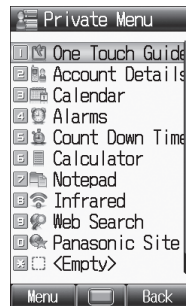

Private Menu Window

Customizing Private Menu

- 1 In Standby, press and hold 
- 2 Highlight target →  [Menu] → **Set Shortcut**
- 3 Select an item
- 4 Highlight an item →  [Entry]

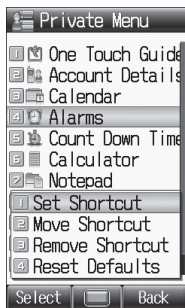



Private Menu Setting Window



Change Menu Order

- > After Step 2, highlight a function →  [Menu] → **Move Shortcut**
→ Select a position

Delete Functions

- > After Step 2, highlight a function →  [Menu] → **Remove Shortcut**
→ 

Reset Private Menu

- > After Step 2,  [Menu] → **Reset Defaults** → 

Simple Mode

Activate Simple menu to limit mode options to basic ones. Enlarge fonts in Messaging, Phone Book, Call Log and Browser menus, and maximize volume.

- Handset is limited to basic operations (☞ P.1-22).
- Font size cannot be changed.
- To change volume: ☞ P.1-22





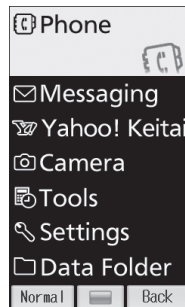

Normal Mode Window



Simple Mode Window

Font Size: Large
Earpiece Volume: Volume 6

Activating Simple Mode

- 1 In Standby, press and hold  → 
- To cancel: Press and hold  →  again

Change Earpiece Volume

> During a call, / or /

Position Clock in Standby

> In Simple Mode, **Main Menu** ► **Settings** ► **Standby Display Clock**
► **Lower Center**

Cancel Simple Menu

> In Standby,  →  [Normal] → 

Note

- While switching between modes, other functions are not available.
- Turning off the power does not cancel Simple Mode.
- Standby Window and Private Menu is not available in Simple Mode, and Key settings temporarily return to defaults.
- Alternatively, **Main Menu** ► **Settings** ► **Phone Settings** ► **Change Simple Mode** ► .

Simple Mode

Simple Mode Menu	Page	Simple Mode Menu	Page
Phone		Tools	
View Phone Book	4-6	One Touch Guide	11-12
Create New Entry	4-3	Alarms	11-6
Mail & Call Log	2-10	Bar Code Reader	11-10
Message List	2-12	Calculator	11-7
Voice Mail	2-15	Notepad	11-8
One Touch Key	4-8	Voice Recorder	11-9
Account Details	1-24	Infrared	9-2
Messaging		Settings	
Incoming Mail	12-12	Ringer Volume	15-2
Create New S! Mail	12-4	Assign Ringtone	15-2
Drafts	12-18	Vibration Alert	15-2
Retrieve New	12-17	Wallpaper	15-4
Sent Messages	12-18	Standby Display Clock	Left
Unsent Messages	12-18	Date & Time	15-8
Create New SMS	12-8	Data Folder	
Yahoo! Keitai		View Photos	8-2
Yahoo! Keitai	13-3	View Movies	8-2
Bookmarks	13-8	Ring Songs&Tones	8-2
Saved Pages	13-8	S! Appli	8-2
Enter URL	13-4	Books	8-2
Camera		Templates	8-2
Take Photos	5-5	Memory Status	8-3
View Photos	5-8		
Record Movies	5-6		
View Movies	5-8		

Passwords

Phone Password, Center Access Code and Call Barring Password are needed for handset use.

Phone Password

<Default> 9999

4 to 8-digit number required to use/change some handset functions.

- ✖ appears for each digit entered.
- Phone Password can be changed on handset (☞ P.10-2).
- If Phone Password is incorrectly entered three times, warning message appears. Turn off handset and try again.

Center Access Code

4-digit number specified at initial subscription; required to access Voice Mail via landlines or subscribe to fee-based information.

- Do not attempt to change Center Access Code. For details, contact SoftBank Mobile Customer Center, General Information (☞ P.16-30).

Call Barring Password

4-digit number specified at initial subscription, required to restrict handset services (☞ P.2-19).

- If entered incorrectly three times, Call Barring Password settings lock; Call Barring Password & Center Access Code must be changed. Reach SoftBank Mobile Customer Center, General Information (☞ P.16-30) for details.
- Call Barring Password can be changed on handset (☞ P.2-19).

Note

- Write down Phone Password, Center Access Code and Call Barring Password.
- Do not reveal Phone Password, Center Access Code and Call Barring Password. SoftBank is not liable for misuse or damages.
- For details, contact SoftBank Mobile Customer Center, General Information (☞ P.16-30).

View Blind

Activate View Blind to protect Display from prying eyes.

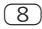
- 1 Press and hold 

View Blind is set to Level 1 by default.

- To cancel: Press and hold  again

Change Level

> **Main Menu** ► **Settings** ► **Display Settings** ► **View Blind** ► **Level** ► Select a level (Highest protection: Level 3)

Note

- Alternatively, **Main Menu** ► **Settings** ► **Display Settings** ► **View Blind** ► **Settings ON/OFF**.
- View Blind cannot be activated: In Standby; in View Blind Setting; while S! Appli is active
- When S! Appli is active, View Blind is temporarily canceled. After terminating/suspending S! Appli, View Blind reactivates.

My Number

Confirm handset phone number in Account Details (☞ P.4-14). Also confirm data saved in Account Details: name, mail address, etc.

- 1 In Standby,  → 

Account Details appears.

