

Support

Customer Service

■Call these numbers toll free from landlines.

Subscription Areas	Contact	
Hokkaido, Aomori, Akita, Iwate, Yamagata, Miyagi, Fukushima, Niigata, Tokyo, Kanagawa, Chiba, Saitama, Ibaraki, Tochigi, Gunma, Yamanashi, Nagano, Toyama, Ishikawa, Fukui	General Information	☎ 0088-240-157
	Customer Assistance	☎ 0088-240-113
Aichi, Gifu, Mie, Shizuoka	General Information	☎ 0088-241-157
	Customer Assistance	☎ 0088-241-113
Osaka, Hyogo, Kyoto, Nara, Shiga, Wakayama	General Information	☎ 0088-242-157
	Customer Assistance	☎ 0088-242-113
Hiroshima, Okayama, Yamaguchi, Tottori, Shimane, Tokushima, Kagawa, Ehime, Kochi, Fukuoka, Saga, Nagasaki, Oita, Kumamoto, Miyazaki, Kagoshima, Okinawa	General Information	☎ 0088-250-157
	Customer Assistance	☎ 0088-250-113

SoftBank Customer Center
From a SoftBank handset, dial toll free at
157 (General Information)
113 (Customer Assistance)

SoftBank Global Call Center
From outside Japan, dial
+81-3-5351-3491
(International charges apply.)
Call this number immediately if handset/USIM Card is lost or stolen while outside Japan.

More Information

Online English Manual
See SOFTBANK MOBILE Corp.
Website (<http://www.softbank.jp>).
May be unavailable at purchase.
Call Customer Service or try later.

Emergency Numbers

- Police **110**
- Fire & Ambulance **119**
- Maritime Safety Agency.... **118**

GH68-20229A (Rev. 1.0)

SoftBank 730SC

First Step Guide

Emergency Numbers

Customer Service

More Information

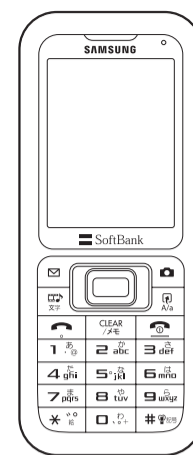

English Interface

International Call

Customizing Address

And More...

Safety Precautions

Do not short-circuit Charger Port.

Keep metal objects away from the Charger Port. Keep handset away from jewelry. Battery may leak, overheat, burst, or ignite causing injury. Use a case to carry handset.

Avoid battery leakage, breakage or fire injury.

- Do not:**
- Heat or dispose of battery in a fire.
 - Disassemble, modify, or break battery.
 - Damage or solder on to battery.
 - Use a damaged or deformed battery.
 - Use a non-specified charger.
 - Force battery into handset.
 - Charge or place battery near fire, heat sources or expose it to extreme heat.
 - Use battery for other equipments.

Do not insert foreign objects into handset.

Do not place metal or flammable objects in handset or Charger. This may cause fire or electric shock. Keep handset out of the reach of children.

Keep handset away from liquid-filled containers.

Keep handset and Charger away from chemicals/liquids. Fire or electric shock may result.

Avoid sources of fire.

To prevent fire or explosion, do not use handset near gas or fine particles (Coal, dust, metal, etc.).

Keep handset and Charger away from microwave ovens.

Battery or handset may leak, burst, overheat, or ignite.

Do not subject handset to shocks.

Subjecting handset or Charger to shocks may cause malfunction or injury. Should handset break, remove battery and contact the SoftBank Customer Center, Customer Assistance. Discontinue handset use. Fire or electric shock may occur.

Keep handset off and Charger disconnected near filling station or places with risk of fire/explosion.

Handset use near petrochemicals or other flammables may lead to fire or explosion.

Preventing accidents

- For safety, never use handset while driving. Pull over beforehand. Mobile phone use while driving is prohibited by the revised Road Traffic Law (Effective November 1 2004).

- Do not use headphones while driving or riding a bicycle. Accidents may result.
- Do not turn the volume up so high that ambient sounds cannot be heard, especially when walking in or around traffic to avoid accidents.

Do not swing handset by the strap.

Injury or breakage may result.

Use only the specified voltage.

Non-specified voltages may cause fire or electric shock.

AC Charger: AC 100V-240V Input

Do not plug multiple cords in one outlet.

Excess heat or fire may occur.

Do not bend, twist, pull, or set objects on the cord. Do not put heavy objects on the cords or heat or pull the cords.

Fire or electric shock may result.

Turn handset power off before boarding air craft.

Using wireless devices aboard aircraft may cause electronic malfunctions or endanger aircraft operation.

Ringtone & Vibration Settings

Select settings carefully if you have a heart condition or wear a pacemaker/defibrillator.

During thunderstorms, turn power off; move to a safe place.

There is a risk of a lightning strike or electric shock.

Do not use handset with wet hands.

Doing so may lead to electric shock or damage to 730SC.

For more information, see User Guide P.xxviii

Before Using Handset

Accessories

• Battery [SCBAM1]

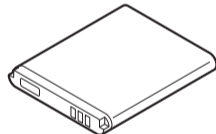

• AC Charger [SCCAM1]

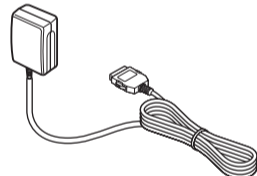

USIM Card Installation

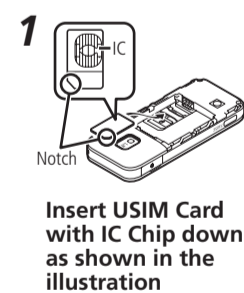

USIM Card must be inserted to use 730SC. Turn 730SC off and remove battery before inserting/removing USIM Card. To prevent damaging it, avoid touching the IC chip when inserting or removing USIM Card.

Manner Profile

Minding Mobile Manners

Please use handset responsibly. Inappropriate handset use can be both dangerous and bothersome to others. Please take care not to disturb others with handset use. Adjust handset use to your surroundings accordingly.

Activating/Canceling Manner Profile

■ Press **[*][#][0][*]** for 1+ seconds

Battery Installation

Do not touch battery contacts.

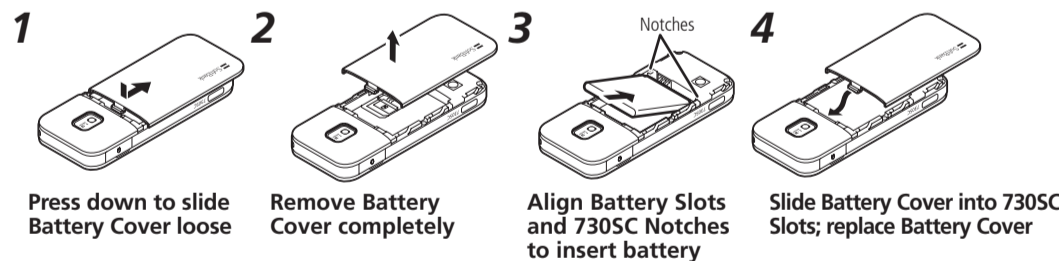

USIM PINs

- PIN
4- to 8-digit security code; prevents unauthorized use. Set **PIN certification to On** to require PIN entry at power on.
- PIN2
4- to 8-digit security code required for Reset Call Cost or Edit Cost Limit, etc.

Change PIN and PIN2 as required.

Canceling PIN Lock (PUK/PUK2 Code*)

Incorrectly entering PIN or PIN2 three consecutive times activates PIN Lock and limits 730SC function access. Enter PUK (PIN Unlocking Key) Code to cancel PIN Lock. For more information, contact Customer Service.

* Entering PUK/PUK2 incorrectly ten consecutive times locks USIM Card and disables 730SC. Write down PUK and PUK2. Unlocking USIM Card requires special service. Contact Customer Service.

Charging

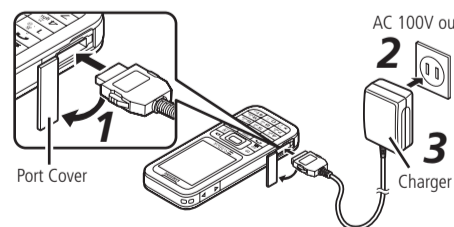

Open Port Cover and insert Adapter Connector

Plug Charger into an AC 100V outlet

- While charging, battery indicator charges as follows:
[Battery icon] → [Battery icon] → [Battery icon] [Battery icon] flashes when battery is full.
- Charging time is approximately 150 minutes.

Unplug Charger, then disconnect handset

Security Codes

- Phone Password
4-digit number (9999 by default) required to use or change handset functions. Entered digits appear as *. If incorrect, error message appears; try again.
- Center Access Code
4-digit number specified at subscription; use to subscribe to fee-based information/access Voice Mail via landlines.

Network Password

4-digit number specified at subscription; use for Call Barring, etc. Entering it incorrectly three consecutive times locks Call Barring settings. To resolve, Network Password and Center Access Code must be changed. For details, contact Customer Service.

Change Phone Password or Network Password on 730SC.

Specifications

SoftBank 730SC

Weight	Approximately 95.9 g
Continuous Talk Time	Voice Call: 270 minutes
Continuous Standby Time (Display off)	500 hours

Charging Time (power off)	AC Charger: Approximately 150 minutes
Dimensions (W x H x D)	Approximately 44.5 x 107.9 x 14.7 mm
Maximum Output	0.25W

- Values calculated with battery installed.
- Actual times may be reduced by alternating between operations/transmissions and Standby.

Getting Started

Display Indicators

1	Signal Strength
2	Network Connection Status
3	New Message
4	Memory Full (S! Mail/SMS)
5	Music Status
6	Data Transmission Status
7	Manner Profile
8	Battery Level
9	Alert Tone Volume and Vibration Status
	Voice Mail/Call Forwarding Active
	Answering Machine Active
	Alarm Set
	Unheard Answering Machine Message
	Unheard Voice Mail
	All Keys Locked
	Password Lock Active
	Secret Mode Shown

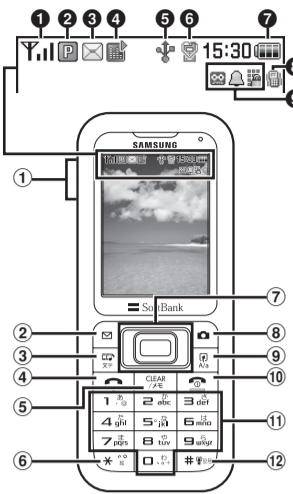

Key Assignments

1	Adjust Ringer/Earpiece volume or scroll menus
2	Open Messaging menu or execute Left Softkey command/function
3	Press for Media Player or change entry mode for text entry
4	Initiate or accept Voice Calls
5	Delete entered text or return to the previous window
6	Toggle Pictograms for text entry Long press for Mode settings
	Move menu items or cursor, scroll
	Basic Multi Selector Operations
7	: Press or
8	Activate Camera or execute Right Softkey command/function
9	Show Switch bar or toggle upper/lower-case for text entry
10	Turn power on/off or end operations
11	Enter numbers or characters and select menu items
12	Toggle Symbols for text entry Long press for Manner profile

Function List

Messaging	Received messages	Data Folder	Pictures	Settings	Sounds & Alerts
	Create new		My Pictograms		Manner mode settings
	Retrieve new		Ring songs • tones		Display settings
	Drafts		Music		Phone settings
	Templates		Videos		Security
	Sent messages		Graphic Mail templates		Call settings
	Unsent		Other documents		Mode settings
	Server mail		Memory status		Connectivity
	Create new SMS				Memory settings
	Settings	Tools	Alarms		
	Memory status		Calculator		
Call Log	Received calls		Converter		
	Dialed calls		World clock		
Media Player			Notepad		
	Music		Tasks		
	Movie		Voice recorder		
	Settings		Stopwatch		
Calendar		Phonebook	Phonebook		
Camera	Take photo		Create new entry		
	Record video		Group settings		
			Account details		
			Speed dial		
			Settings		
			Memory status		

Handset Functions

Basic Operations

Handset Power On/Off

Power On
 for 1+ seconds

730SC initiates Network Info retrieval the first time , or is pressed in Standby. Select **Yes** then follow onscreen instructions.

Power Off
 for 2+ seconds

English Interface

\rightarrow **設定** \rightarrow **一般設定** \rightarrow **言語選択** \rightarrow **English**

My Phone Number

\rightarrow
 • to exit

Setting Clock

\rightarrow **Settings** \rightarrow **Phone settings** \rightarrow **Date & Time** \rightarrow Time field \rightarrow Enter time (12/24-hour format) \rightarrow Date field \rightarrow Enter year, month, and day \rightarrow (Save)

Calls

Voice Call

Enter a phone number \rightarrow Confirm the number \rightarrow / (Call)
 • to end the call

Using Call Log Records

(Received calls) / (Dialed calls) \rightarrow
 Highlight a record \rightarrow (Call) \rightarrow **Voice call**
 • to end the call

International Call

International Call Service may require prior application; get information or apply online: http://mb.softbank.jp/mb/en/global_service/ (730SC cannot be used outside Japan.)

Enter a phone number \rightarrow \rightarrow **International call** \rightarrow Select country / **Enter Code** for direct entry \rightarrow Confirm the number \rightarrow

• to end the call

To call a Softbank handset overseas, enter handset phone number; country code is not required.

Receiving a Call

When 730SC rings/vibrates,
 • to end the call

Answering Machine

Activating & Canceling
 \rightarrow **Settings** \rightarrow **Call settings** \rightarrow **Answering machine** \rightarrow **Setting** \rightarrow **On/Off**
 • When **On**, appears in Standby.

Playing Messages
 \rightarrow **Settings** \rightarrow **Call settings** \rightarrow **Answering machine** \rightarrow **Recordings** \rightarrow Highlight a message \rightarrow (Play)

Deleting Messages
 \rightarrow **Settings** \rightarrow **Call settings** \rightarrow **Answering machine** \rightarrow **Recordings** \rightarrow Highlight a message \rightarrow (Delete) \rightarrow **Yes**

Text Entry

Changing Text Entry Mode

In a text entry window, \rightarrow Select entry mode

	Kanji/Hiragana
	Double-byte Katakana
	Single-byte Katakana
	Double-byte Alphanumerics
	Single-byte Alphanumerics
	Double-byte Numbers
	Single-byte Numbers
	Double-byte Symbols
	Single-byte Symbols
	Pictograms
	Emoticons
	Hangul
	Double-byte Alphabet (Lower case)
	Single-byte Alphabet (Lower case)

Example: Entering "NO"

In a text entry window, \rightarrow **Ab** \rightarrow (Twice) \rightarrow \rightarrow (Thrice) \rightarrow (OK)

Messaging

S! Mail/SMS

S! Mail
 Exchange messages of 30,000 single-byte or 15,000 double-byte characters (approx.) with S! Mail compatible SoftBank handsets or other devices via E-mail; attach media or other files for multimedia messaging.

SMS
 Exchange up to 70 double/single-byte characters or 160 single-byte alphanumerics with SMS compatible SoftBank handsets. Use handset phone numbers as mail addresses.

Sending Messages

S! Mail
 \rightarrow **Create new** \rightarrow Recipient field \rightarrow **Enter address** \rightarrow Enter mail address \rightarrow Subject field \rightarrow Enter subject \rightarrow Attach field \rightarrow **Data Folder** \rightarrow Select a folder \rightarrow Select a file \rightarrow Enter Text field \rightarrow Enter message \rightarrow (Send)

SMS
 \rightarrow **Create new SMS** \rightarrow Recipient field \rightarrow **Enter Number** \rightarrow Enter phone number \rightarrow Enter Text field \rightarrow Enter message \rightarrow (Send)

Checking for New Messages

In Standby, notification appears for new message.
 (View) \rightarrow Select a folder \rightarrow Select an incoming message

Phonebook

Phonebook Entry Items

Phone Number
 Save five numbers (32 bytes each); USIM Card Phonebook entry limit varies by card.

E-mail Address
 Save five addresses (128 bytes each); USIM Card Phonebook character entry limit varies by card.

Saving to Phonebook

\rightarrow (New) \rightarrow Last name field \rightarrow Enter last name \rightarrow First name field \rightarrow Enter first name \rightarrow Phone number field \rightarrow Enter number \rightarrow Select an icon \rightarrow E-mail address field \rightarrow Enter address \rightarrow Select an icon \rightarrow (Save)

Calling from Phonebook

\rightarrow Highlight an entry \rightarrow (Details) \rightarrow Highlight number \rightarrow (Call) \rightarrow **Voice call**

Mobile Camera

Capturing Still Images

\rightarrow Use Display as viewfinder \rightarrow \rightarrow (Save)

Capturing Video

\rightarrow **Camera** \rightarrow **Record video** \rightarrow Use Display as viewfinder \rightarrow \rightarrow (Save)

Media Player

Playing Music

\rightarrow **Media Player** \rightarrow **Music** \rightarrow Select a folder \rightarrow Highlight a file \rightarrow (Play)

Creating Playlists

\rightarrow **Media Player** \rightarrow **Music/Movie** \rightarrow **Playlist** \rightarrow \rightarrow **Create playlist** \rightarrow Enter Playlist name \rightarrow Select created Playlist \rightarrow \rightarrow **Add** \rightarrow **Files** \rightarrow Check file to save \rightarrow (Save)

Playing Playlists

\rightarrow **Media Player** \rightarrow **Music/Movie** \rightarrow **Playlist** \rightarrow Highlight a Playlist \rightarrow (Play)

Managing Files

Opening Files

\rightarrow **Data Folder** \rightarrow Select a folder \rightarrow Highlight a file \rightarrow (View/Play/Select/Start)